

VICINITY MAP

Certificate of ownership and dedication. This certifies that the undersigned is the owner of the property shown on this map, has acquired the same by deed as recorded in the office of the register of deeds of Wake County, North Carolina or otherwise as shown below and that by submission of this plat or map for approval, the dedication to the Town of Cary for public use of streets, easements, rights of way and parks shown thereon for all lawful purposes to which the same may be devoted or allow the same to be used and upon acceptance thereof and in accordance with all town policies, ordinances and regulations or conditions of the Town of Cary for the benefit of the public, said dedication shall be irrevocable; provided dedications of easements for storm drainage are not made to the Town of Cary but are irrevocably made to the subdivision area of any and all properties shown on the plat or map and subject to the conditions of the deed and for Section 2 of the town storm drainage plan, as the same may be in force in time hereafter. Book 3221, Page 59.

*John Y. Phelps, Jr.*  
 Surveyor  
 Key Homes, Inc.  
 Wake County  
 North Carolina

Personally appeared before me  
*Donald R. Chapman*, who being duly sworn says that the certificate shown is true and correct this 23 day of July, 1987.  
*Donald R. Chapman*  
 Notary Public

Condition of approval. The undersigned certifies that the property shown on this map is the same as that shown on the plat or map and approved the dedication of the streets, easements, rights of way and public parks shown thereon, but assumes no responsibility to open or maintain the same, the Town of Cary is in the public interest to do so.

THIS PLAT, NOT TO BE RECORDED AFTER 5:00 P.M. DAY OF JULY 1987. 1 COPY TO BE RETAINED FOR THE CITY.  
 THIS PLAT IS OUT OF THE CITY LIMITS.

NORTH CAROLINA - WAKE COUNTY

The foregoing certificate of *John Y. Phelps, Jr.*  
 Notary (y) (ies) (are) certified to be correct. This instrument was presented for registration and recorded in this office.  
 This 23 day of July 1987, at 10:40 o'clock, A.M.  
 Kenneth C. Wilkins, Register of Deeds  
 By *Debra C. Smith*, Deputy Register of Deeds

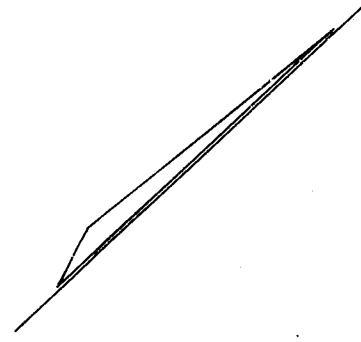

COMMON AREA

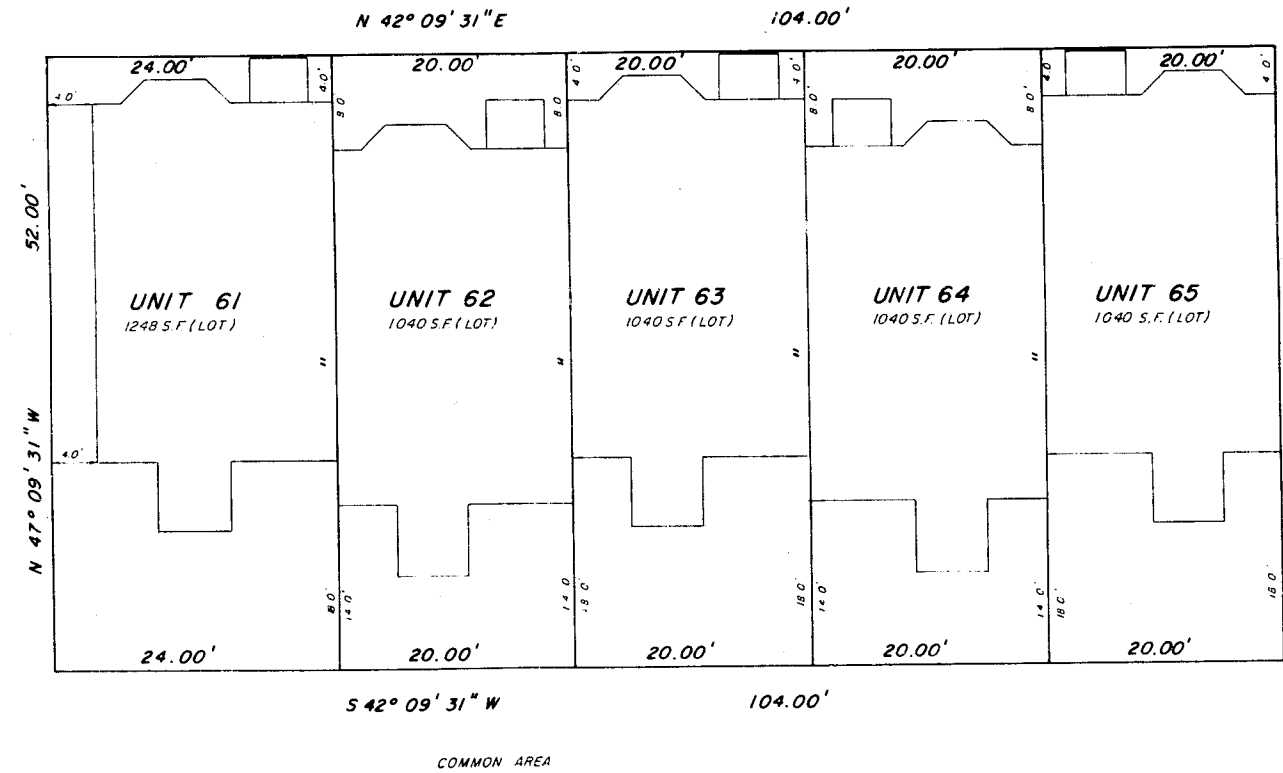

COMMON AREA

State of North Carolina

WAKE County  
 I, *JOHN Y. PHELPS, JR.*  
 certify that this map was drawn under my supervision, deed description recorded in Book 3221, Page 59; that the ratio of precision as calculated by latitudes and departures is 1/10,000; that the boundaries not surveyed are shown as broken lines plotted from information found in Book 3221, Page 59; that this map was prepared in accordance with G.S. 47-30 as amended. Witness my hand and seal this 23 day of July 1987.  
*John Y. Phelps, Jr.*  
 REGISTERED LAND SURVEYOR

NORTH CAROLINA WAKE COUNTY

Personally appeared before me  
*John Y. Phelps, Jr.*, who being duly sworn says that the certificate shown is true and correct this 23 day of July, 1987.  
*John Y. Phelps, Jr.*  
 Registered Land Surveyor

COMMON AREA

REFERENCE: CAMBRIDGE FOREST PHASE TWO  
 UNITS 50-53, 54-57, 58-60, 61-65, 66-71  
 RECORDED IN B.O.M. 1987 Pg. 285  
 RE-RECORDED IN B.O.M. 1987 Pg. 1261

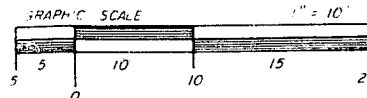

THIS PLAT, NOT TO BE RECORDED AFTER 5:00 P.M. DAY OF JULY 1987. 1 COPY TO BE RETAINED FOR THE CITY.  
 THIS PLAT IS OUT OF THE CITY LIMITS.

TAX MAP (PART) 459-18, 459-150

SCALE 1" = 10'	CAMBRIDGE FOREST PHASE TWO UNITS 61-65
DATE 07-14-87	
FLD. BK. CAMFOR 2	
CARY, N.C.	
JOHN Y. PHELPS, JR. REGISTERED LAND SURVEYOR	

RECORDED IN BOOK OF MAPS 1987 VOL. PAGE 1263