

FOUNDATION PLAN

RIGHT HAND PLAN
KH. 5320 & KH. 5330

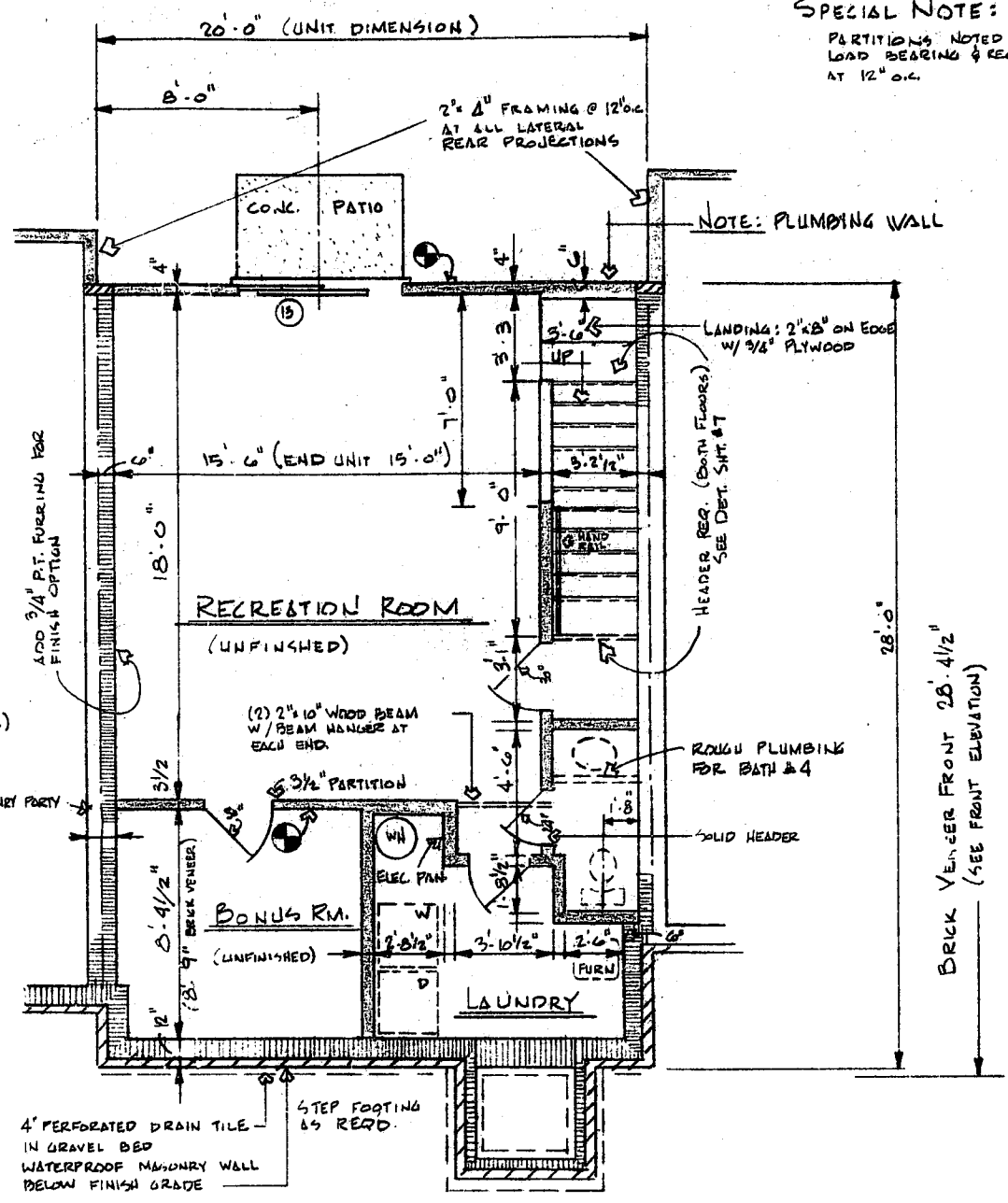

LOWER LEVEL FLOOR PLAN

LEFT HAND PLAN
KH. 5320 & KH. 5330

SPECIAL NOTE:
PARTITIONS NOTED THUS ARE
LOAD BEARING & REQUIRE 4" OR 6" STUDS
AT 12" O.C.



DATE	REVISION #	DATE	BY	DESCRIPTION
		3-29-83		
10-19-83	(3) DAF		DF	REI BONUS RM.
12-10-83	UDLE			GENERAL REVISIONS

SHEET NO.
1