

**FOUNDATION PLAN**

RIGHT HAND PLAN  
KH-5320 & KH-5330

SCALE: 1/4" = 1'-0"

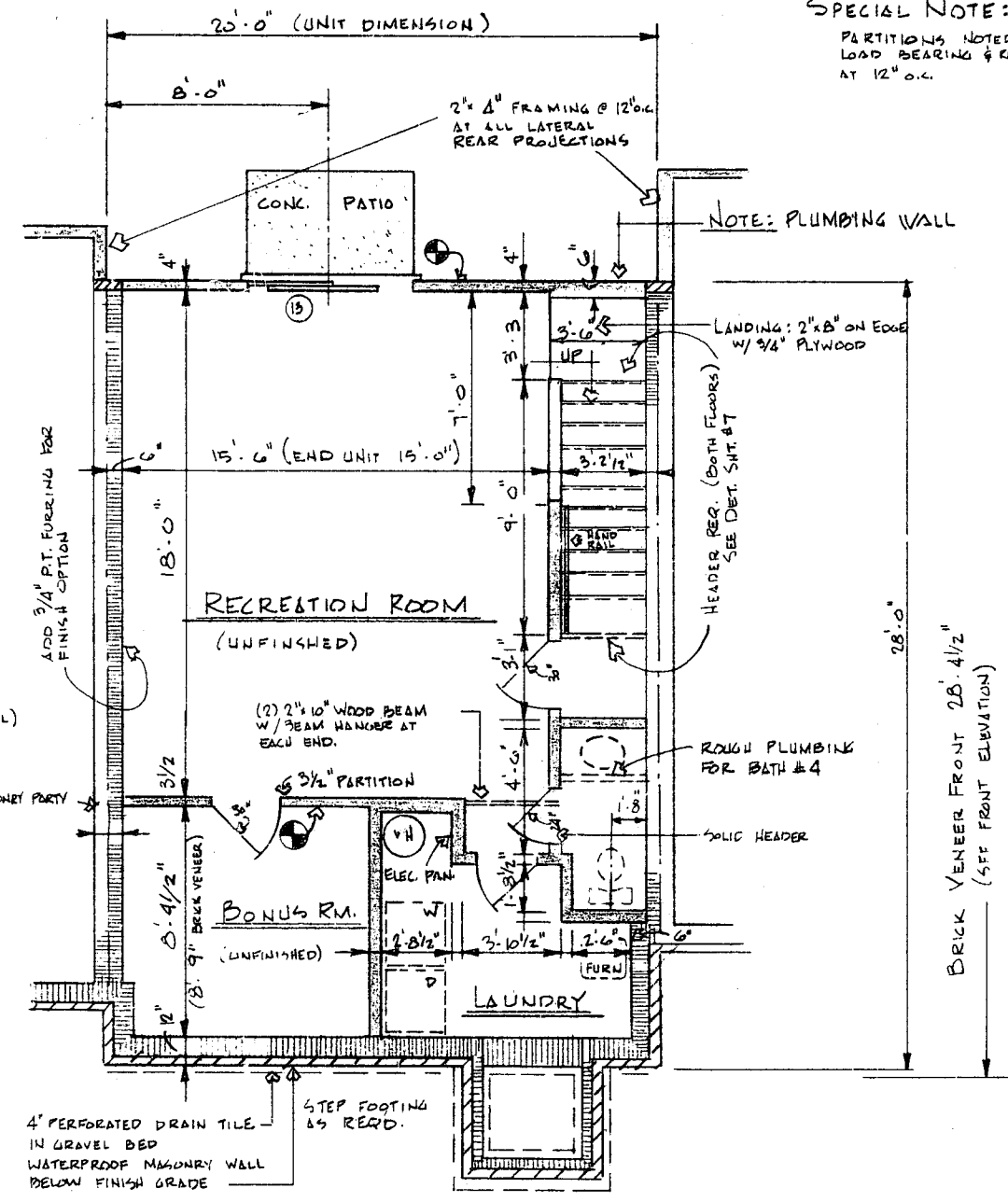

**LOWER LEVEL FLOOR PLAN**

LEFT HAND PLAN  
KH-5320 & KH-5330

**SPECIAL NOTE:**  
PARTITIONS NOTED THUS ARE LOAD BEARING & REQUIRE 4" OR 6" STUDS AT 12" O.C.

NOTE: PLUMBING WALL

BRICK VENEER FRONT 28'-4 1/2"  
(SEE FRONT ELEVATION)

<b>KEY homes</b>				SHEET NO. <b>1</b>
DATE	REVISION #	DATE	KH-5320	
		3-25-85		
		DRAWN	KH-5330	
		DF		
REV. BONUS RM.		10-19-85	(2) DAF	
GENERAL REVISIONS		10-10-85	(1) DAF	