

NOTE: LOTS 9-11 INCLUDING OF CAMPBELL-WOOD SUBD. PHASE ARE APPROVED BY WAKE CO. COMM. DEVELOP. DEPT., BUT AT THIS TIME ARE NOT RECORDED.

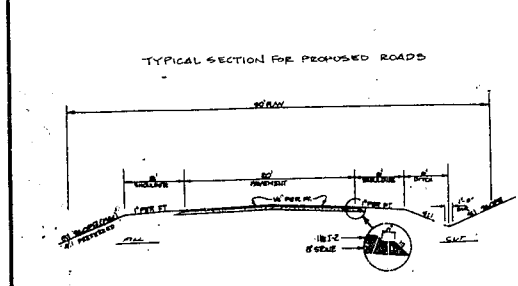

LEGEND

- REINFORCED CONCRETE PIPE
- SILT BASIN (RIP-RAP GRAVEL FILTER TYPE)
- GRADE BREAK WITH WATER FLOW
- BORROW AND SPOILS AREA (AREA=0.25 AC.)
- ENERGY DISSIPATOR (RIP-RAP TYPE)
- SILT FENCE

LOCATION AND COURSE OF DRAINAGE EASEMENTS MAY VARY DUE TO FIELD CONDITIONS.

quantities and placement of materials may change to meet or better conform to field conditions as per instructions of engineer.

DENUDED AREA

WAKE CO.	CARY	TOTAL
1.68 Ac.	3.23 Ac.	4.91 Ac.

Denuded area is the total length of the street multiplied by the clearing limit of 60'. (60' each side of centerline) PLUS BORROW/SPOILS AREA.

WITHIN THE TOWN OF CARY'S ETJ, THE PROJECT SHALL COMPLY WITH THE TOWN OF CARY'S WATERSHED PROTECTION ORDINANCE

IMPERVIOUS SURFACE FROM STREETS	1.002 ac.
IMPERVIOUS SURFACE FROM LOTS (18 ft is at 0.092 ac./lot)	1.656 ac.
TOTAL IMPERVIOUS SURFACE AREA WITHIN CARY'S ETJ	2.658 ac.
PERCENTAGE IMPERVIOUS SURFACE WITHIN CARY'S ETJ	11.761%

ALL WORK SHALL CONFORM TO TOWN OF CARY AND/OR NC DOT STANDARDS AND SPECIFICATIONS WHERE APPLICABLE

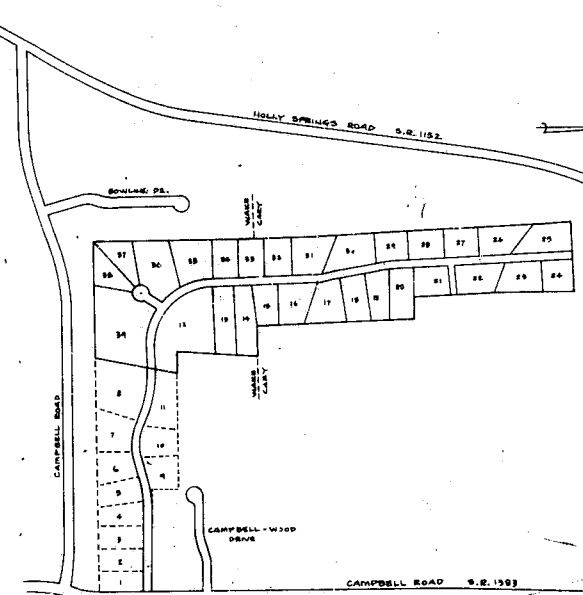

OWNERS:

T.M. 617-45	VIRGINIA C. & CHARLES F. HARRISON
T.M. 617-180	810 CAROLINA AVE. RALEIGH, NC 27606 801-4781
-55	EDWIN L. CAMPBELL 8404 CAMPBELL RD. RALEIGH, NC 27606 801-5167

PROPOSED MINIMUM BUILDING SETBACKS

FRONT: 30'
SIDE: 15'
REAR: 30'
CORNER 25'

APPROVED
TOWN OF CARY
PRELIMINARY PLANS

P.A.Z. BOARD 3-15-88
T.C. 3-24-88
T.F.W.

- * Approval Includes
- 1) Lot 14 & 33 to be built in accordance with T.O.C. standards rather than Wake County.
 - 2) Approval does not include the property north of Lots 20 & 29.
 - 3) Subdivision Approval does not include curb & gutter of roadways (variance granted by Town Council).

SITE DATA SUMMARY

	Cary	Wake Co.	Total
Tax Map Reference.....	627-53	627-45, 180	
Present Zoning.....	R-40	R-40W	
Total Acreage.....	22.6	15.8	38.4
Total Number New Lots.....	18	10	28
Average Lot Size.....	1.11 ac.	1.44 ac.	1.23 ac.
Lineal Foot in Streets.....	2300	1200	3500
Acreage in Streets.....	2.64	1.37	4.01

Water system will consist of individual well on each lot.
Sewer system will consist of individual septic tank on each lot.
TOPOGRAPHIC BY ORIENTATION TAKEN FROM WAKE COUNTY TOPOGRAPHIC SHEET 07702 AND 07704, VIA CONTOUR INTERVAL OF 5'.
NOTE: NO FLOODPLAINS INSIDE TOWN OF CARY ETJ

EROSION CONTROL WITH
SITE PLAN
PRELIMINARY SUBDIVISION PLAN
CAMPBELL-WOOD SUBDIVISION PHASE III
SWIFT CREEK TWP., WAKE CO., N.C.

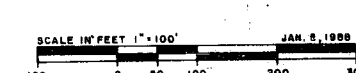

PREPARED BY: THOMPSON & ASSOCIATES, P.A.
1218 FRANKLIN RD., SUITE 201H
RALEIGH, NC 27606
801-1709