

# SITE IMPROVEMENTS FOR CANDLEWOOD HOTEL

## AT THE VILLAGE OF BUCK JONES GARY, N.C.

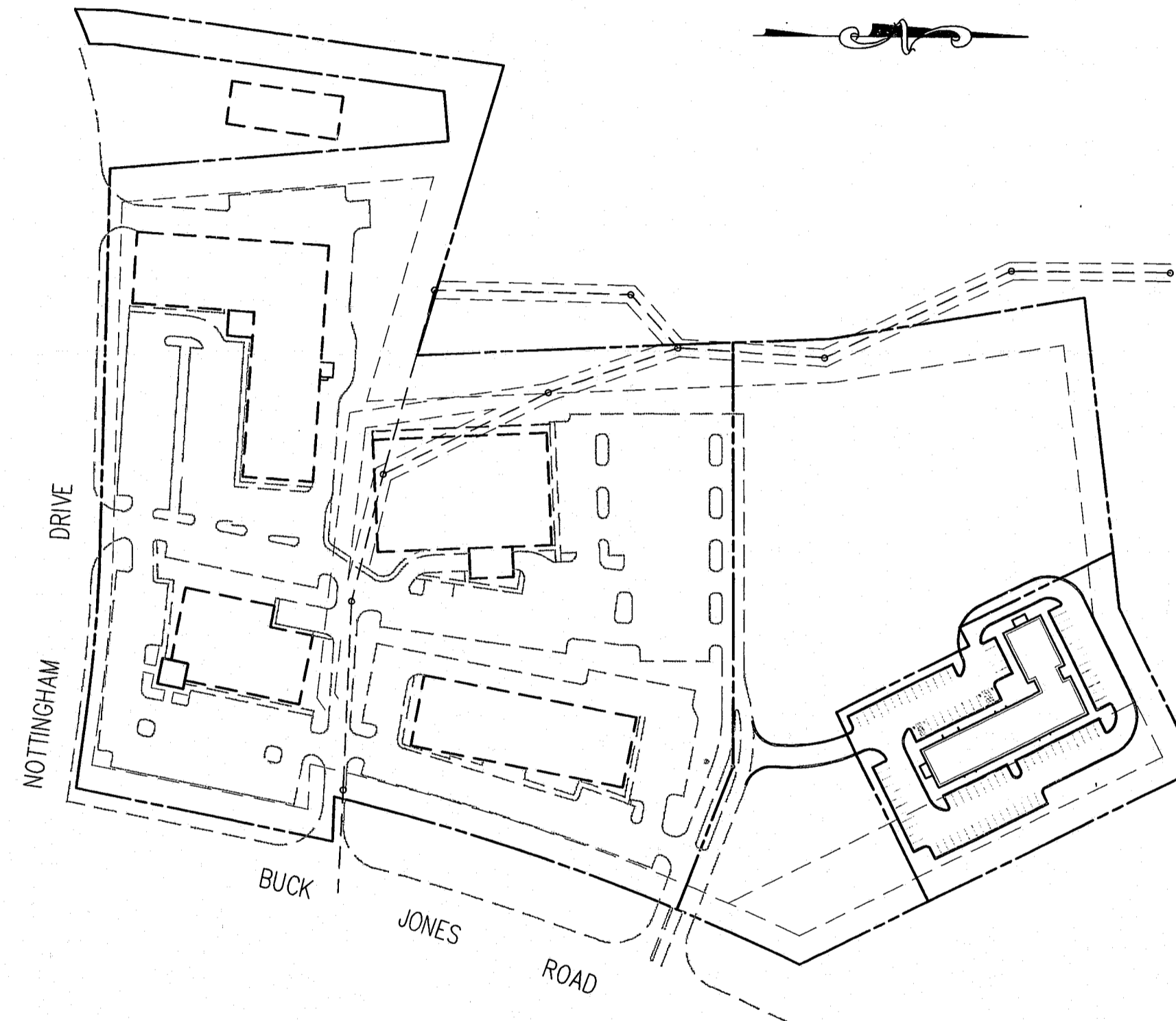
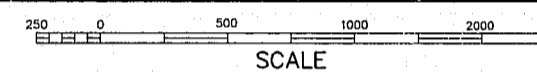
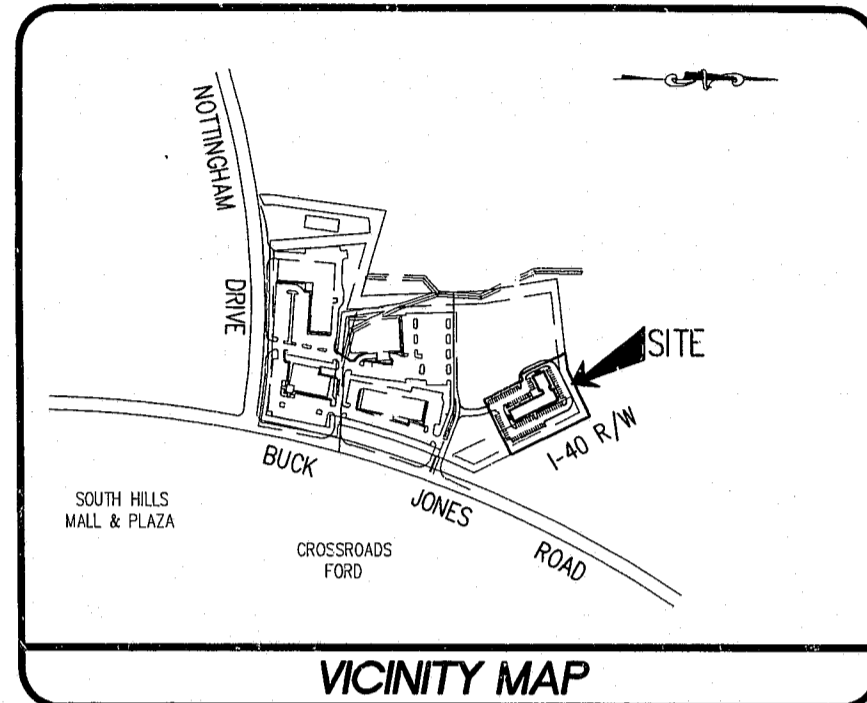

### INDEX OF SHEETS

SITE PLAN	SHT 1
OVERALL GRADING, UTILITIES, & EROSION CONTROL PLAN	SHT 2
DETAILED GRADING PLAN	SHT 3
LIGHTING PLAN	SHT 4
LANDSCAPE PLAN	SHT 5
UTILITY PROFILES	SHT 6
UTILITY PROFILES	SHT 7
DETAILS	SHT 8
ARCHITECTURAL FLOOR PLAN	SHT A1.1
ARCHITECTURAL ELEVATIONS	SHT A2.1
ARCHITECTURAL ELEVATIONS	SHT A2.2

### LEGEND

DESCRIPTION	EXISTING	PROPOSED
2' CONTOUR INTERVAL	-----	-----
10' CONTOUR INTERVAL	-----	-----
PROPERTY LINE	-----	-----
ROADWAY CENTERLINE	-----	-----
RIGHT OF WAY LIMITS	-----	-----
EASEMENT LINE	-----	-----
CURB & GUTTER	=====	=====
SANITARY SEWER FACILITIES	-----	-----
STORM SEWER FACILITIES	-----	-----
WATERLINE	-----	-----
FIRE HYDRANT ASSEMBLY	-----	-----
FENCING STRUCTURE	-----	-----
WOODSLINE	-----	-----
WATERWAYS	-----	-----
SILT FENCING	-----	-----

### OWNER

**STUDIO VENTURES, L.L.C.**  
4015 MAY AVENUE  
WICHITA, KANSAS 67209  
PHONE: (316) 942-0232

### OWNER'S REPRESENTATIVE

**JEFFREY JOHNSTON, VICE PRES.**  
**M.J. ANDERSON CONSTRUCTION CORPORATION**  
SUITE 242 BROWENTON PLACE  
LOUISVILLE, KY. 40222  
PHONE: (502) 425-8770



### PREPARED BY:

**WITHERS & RAVENEL**  
**ENGINEERING & SURVEYING, INC.**

111 MacKENAN DRIVE  
GARY, NORTH CAROLINA 27511  
TELEPHONE: OFFICE (919) 488-8340  
FAX: (919) 487-8000

910-SP-157  
**APPROVED**

P&Z 10-21-96  
TC 11-14-96  
RCS

"official approval plan"

T-5-11 13-11