

**The Parkway (Shoebus)**

- recommended for streets, parking lots, residential/commercial communities and other locations where decorative appeal and/or a more controlled (cutoff) light pattern is needed.
- life span: overhead service - 3 years; underground service - 5 years
- available in ~~black~~ dark bronze
- mountable on a 30 foot decorative square metal pole
- suitable for underground service only
- available with one to four fixtures per pole.

Lumen Size (lamp watts)	Area Coverage*	Light Pattern— Oblong Cutoff Type III	Source/Color
22,000 (200 watts) medium size energy efficient	75' up & 75' down area 60' across area		Sodium Vapor/ Golden Yellow

CPM's LITE\*PRO V3.00 Point-By-Point Numeric Output 13:52 17-Sep-98  
 PROJECT: AU-006 AREA: PROJECT-WIDE GRID: N/A  
 VALUES ARE FC, SCALE: 1 IN= 1.0FT, HORZ GRID (N), HORZ CALC, Z= 0.0

+ MIN=0.31 MAX=3.41 AVE=1.26 AVE/MIN= 4.06 MAX/MIN= 11.02  
 \* MIN=0.08 MAX=3.41 AVE=0.86 AVE/MIN= 10.54 MAX/MIN= 41.91

CONTOUR LEVELS: A= 1.75 B= 0.75 C= 0.35

CALCULATION SUMMARY-				
AREA NAME	DIMENSIONS	GRID NAME	AVE	MAX
SHOEBUS	420x495FT	Horiz 0deg	<+> 1.3 <-> 0.9	3.4 3.4
				0.3 0.1

LUMINAIRE SCHEDULE						
TYPE	SYMBOL	DESCRIPTION	LAMP	LUMENS	MOUNTING/BALLAST	LF/ QTY
005		GE SEBZ_1/POLE	(1) LU-200	22000	30 FT. HGL 22000 LUMEN HPS	0.72 8
		(1) "002" SH_BOX22_1-4/POLE				

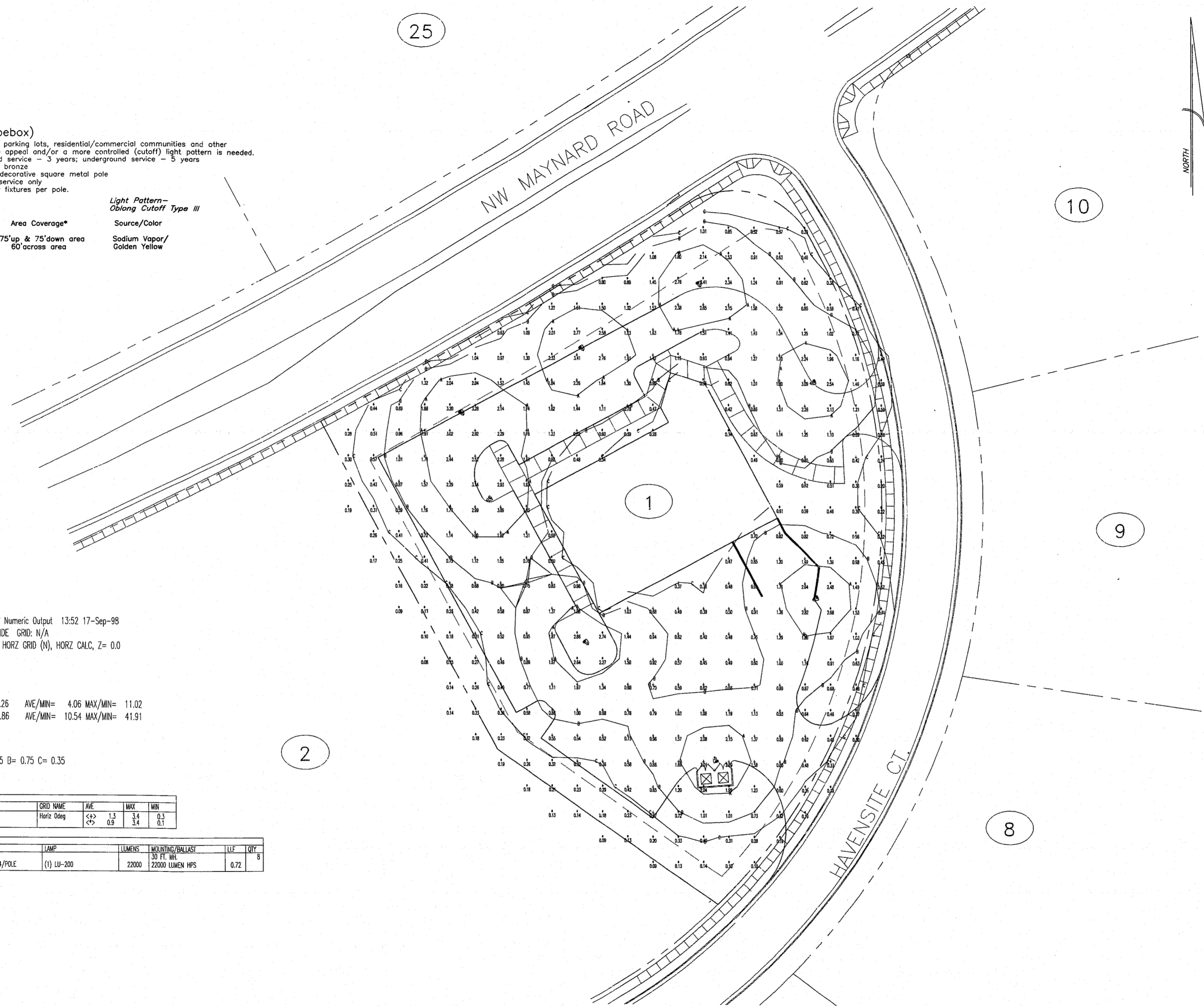

REV.09/19/98 PER CARY COMMENTS  
 REV.10/04/98 PER CARY COMMENTS

<b>CapriFlavors Food Distributor</b>		
Zenac, Inc., P.O. Box 3557, Cary, NC 27513		
POINT BY POINT LIGHTING PLAN		
SCALE: 1"=30'	DATE: AUGUST 12, 1998	1