

Carolina Preserve by
 Del Webb at Amberly
 A/R Phase 3
 Cary, NC
 Pulte Homes Corporation
 1225 Crescent Green Drive, Suite 250
 Cary, NC 27518

REVISIONS	
PROJECT # 09-4020	DATE 01/22/2010
DRAWN BY: MB	CHECKED BY: CD
TITLE	
PHASE 3E UTILITY LAYOUT	
SHEET	
C6.2.7	

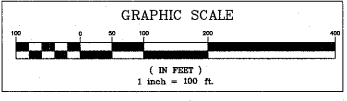
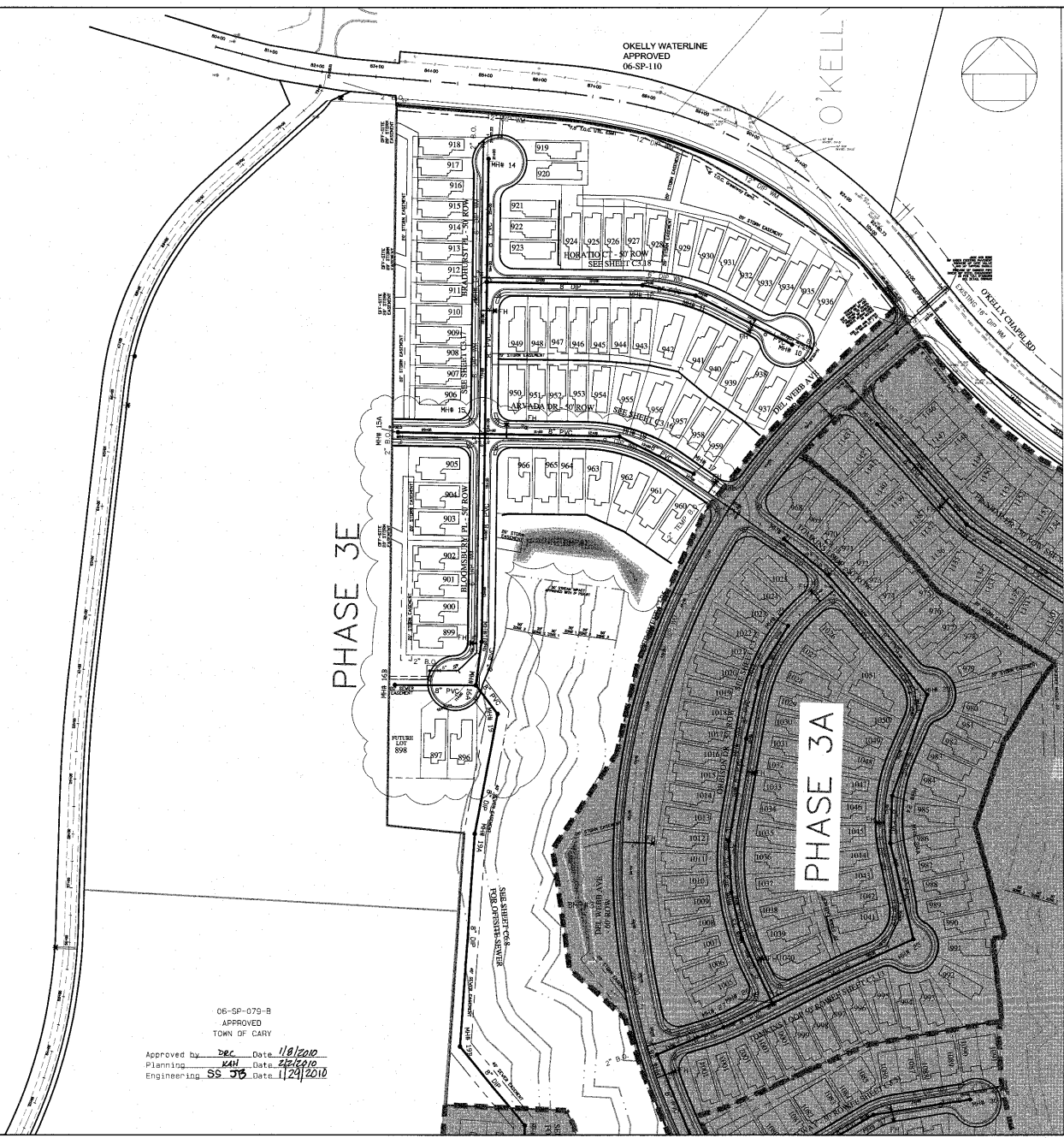

1. ALL STREETS WITHIN OR ADJACENT TO A PHASE MUST BE COMPLETED AS PART OF THAT PHASE
 2. STREETS MUST BE CONSTRUCTED TO CREATE A LOOP OR TEMPORARY TURNAROUNDS MUST BE CONSTRUCTED AT THE END OF EACH TEMPORARY DEAD END STREET
 3. SANITARY SEWER PHASING LINE MUST BE AT A MANHOLE AND THERE MUST BE A VALVE AND BLOW-OFF ON THE WATERLINE AT THE PHASING BOUNDARY
 4. WATERLINE SHALL BE CONNECTED TO PHASE 2 WATERLINE.
- The following phases will be protected from a water quality stand point through the proposed BMP's shown on the phasing plan.
 Phase 3A - BMP #3, 5, AND 6
 Phase 3B - BMP # 7
 Phase 3C1 - BMP # 8
 Phase 3C2 - BMP # 9
 Phase 3E - BMP #1
 Phase 3F - BMP #2

06-SP-079-B
 APPROVED
 TOWN OF CARY

Approved by: hgc Date: 1/9/2010
 Planning: KAH Date: 2/2/2010
 Engineering: SS JB Date: 1/29/2010

© WSP-SELLS. ALL RIGHTS ARE RESERVED. ANY REPRODUCTION OR OTHER USE OF THIS DOCUMENT WITHOUT PERMISSION FROM WSP-SELLS IS EXPRESSLY PROHIBITED.