

V:\Projects\Amberly AR Recreation Center\Drawings\PROJECT DRAWINGS\15-4029 C6.0 Site Lighting Plan.dwg 11/22/2005 9:49:11 AM EST

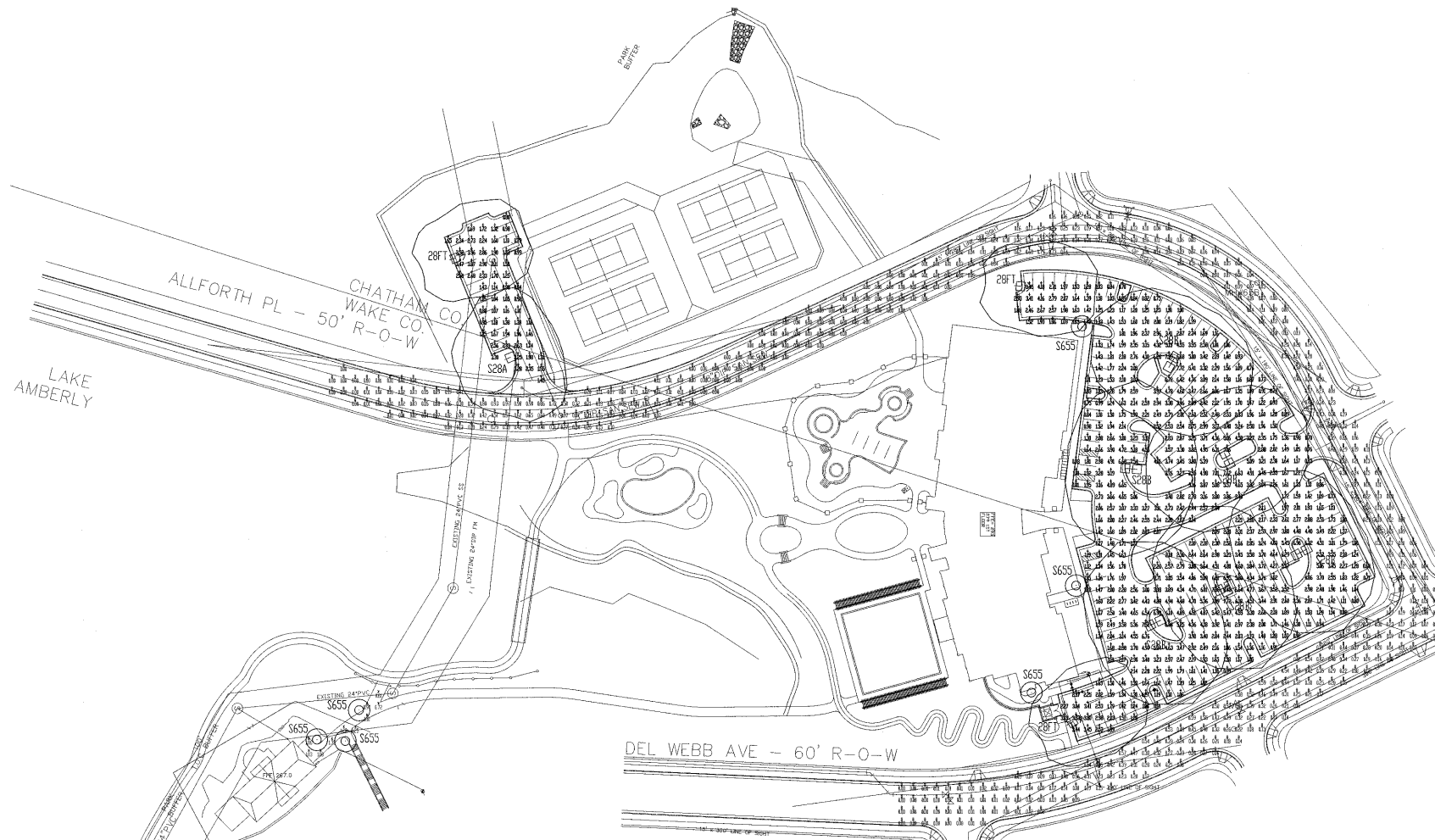

ISOFOOTCANDLE CURVES

FIXTURE: SHOEBOX
 MOUNTING HEIGHT: 30 FT
 LAMP: 250W, 28,500 LUMENS, SODIUM
 PATTERN TYPE: III

NOTE: THE FOOTCANDLE READINGS BELOW ARE MAINTAINED AND HAVE BEEN DEPRECIATED FOR LAMP LUMEN DEPRECIATION AND LUMINAIRE JUST DEPRECIATION FOR INITIAL FIXTURES ONLY. DIVIDE THE READINGS BELOW BY .72.

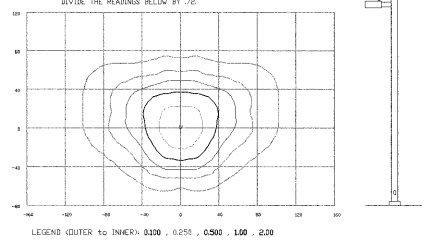

S28A
S28B

ISOFOOTCANDLE CURVES

FIXTURE: MITCHELL WATER PAT./HPS/WARDS/REDUCED
 MOUNTING HEIGHT: 65 FT
 LAMP: 300W, 3000 LUMENS, SODIUM
 PATTERN TYPE: V

NOTE: THE FOOTCANDLE READINGS BELOW ARE MAINTAINED AND HAVE BEEN DEPRECIATED FOR LAMP LUMEN DEPRECIATION AND LUMINAIRE JUST DEPRECIATION FOR INITIAL FIXTURES ONLY. DIVIDE THE READINGS BELOW BY .72.

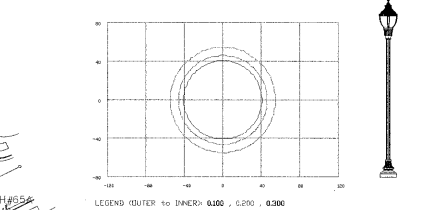

S655

ISOFOOTCANDLE CURVES

FIXTURE: SHOEBOX - FORWARD THROW
 MOUNTING HEIGHT: 30 FT
 LAMP: 250W, 28,500 LUMENS, SODIUM
 PATTERN TYPE: IV

NOTE: THE FOOTCANDLE READINGS BELOW ARE MAINTAINED AND HAVE BEEN DEPRECIATED FOR LAMP LUMEN DEPRECIATION AND LUMINAIRE JUST DEPRECIATION FOR INITIAL FIXTURES ONLY. DIVIDE THE READINGS BELOW BY .72.

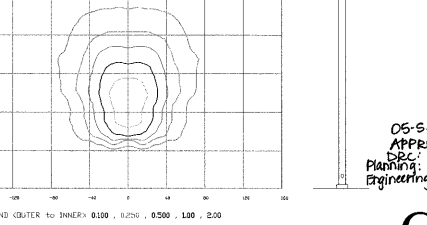

This design contains Special Order fixtures. Please allow additional lead time for these items.

05-SP-135
 APPROVED
 11/22/05
 Planning: J.23.06
 Engineering: J.14.06

C6.0

CALCULATION SUMMARY

AREA NAME	DIMENSIONS	GRID / TYPE	AREA (SQ FT)	SPAC	REQD	AVE	MAX	MIN	MAX/AVG	AVG/REQD
Parking	126'x50'x50'x60'	Parking	654	100'	100'	0.84	0.85	0.68	0.27	0.87
		entry building	10	100'	100'	1.05	1.35	0.61	0.27	1.11
		property line	537	100'	100'	0.18	0.19	0.00	N/A	N/A

Amberly AR Rec Ctr. 05-2029 LUMINAIRE SCHEDULE

TYPE	QUANTITY	DESCRIPTION	LAMP	LUMENS	FRONTING/BALLAST	EFF.	TYPE
S28T	1	Lighting Sys S28T 1/POLE (1) S28T S28T 1/POLE	(1) LU 250	28500	28' HI HI 20K HI HPS	0.72	3
S28A	1	Lighting Sys S28A 1/POLE (1) S28A S28A 1/POLE	(1) LU 250	28500	28' HI HI 20K HI HPS	0.72	1
S28B	1	Lighting Sys S28B 2/POLE (2) S28B S28B 1/4/POLE	(2) LU 250	28500	30' HI HI 20K HI HPS	0.72	6
S655	1	HOLDING WKS S THRU/EAH (1) S655 MESH THRM LP/ST	(1) LU 100	9500	12' HI HI SODIUM VAPOR	0.72	6

LIGHTING DESIGN TOLERANCE

The calculated footcandle light levels in this lighting design are predicted values and are based on specific information that has been supplied to Progress Energy. Any inaccuracies in the supplied information, differences in luminaire installation, lighted area geometry including elevation differences, reflective properties of surrounding surfaces, obstructions (skyscrapers or otherwise) in the lighted area, or lighting from sources other than listed in this design may produce different results from the predicted values. Normal tolerances of voltage, lamp output, and ballast and luminaire manufacture will also affect results.

Customer approval _____ Date _____



Progress Energy

PROPRIETARY & CONFIDENTIAL

This document together with the concepts and design presented herein, presented as an instrument of service, is the sole property of Progress Energy, and is intended only for the specific purpose and prospective client as stated in the title block of this drawing. Any use, copying, reproduction or disclosure of the drawing, design or any information contained herein by the prospective customer or other entities, including without limitation, architects, engineers, or equipment manufacturers is hereby expressly prohibited and shall not be permitted absent prior written consent from, and payment of compensation to Progress Energy. Progress Energy disclaims any liability or responsibility for any unauthorized use of or reliance on this document.

AMBERLY AR RECREATION CENTER CARY NC	
SITE LIGHTING PLAN	
Designed by	PGN LIGHTING SOLUTIONS - CAROLINAS
Reviewed by	R. Simpkins Scale: 1" = 50'
Date	11/19/2005 Size: Drawing size: "D"
Description	HPS Shoebox & Mitchell post fixtures
Drawing No.	05-2029B SHV: 1 OF 1