

# CAROLINA PRESERVE

AT AMBERLY

REFERENCE APPROVED SITE PLAN  
TOWN OF CARY PROJECT #04-SB-028  
(FORMERLY AMBERLY AR-1)

## ENTRY FEATURE, MONUMENTS, AND GATEHOUSE

11/10/2005

## TABLE OF CONTENTS

ENTRY SIGN LAYOUT	L-1.01
SITE DETAILS	L-1.02
SITE DETAILS	L-1.03
GRADING PLAN	L-1.04
PLANTING PLAN	L-1.05
LANDSCAPE MAINTENANCE SCHEDULE	L-1.06
PLANTING DETAILS	L-1.07
LIGHTING PLAN	L-1.08

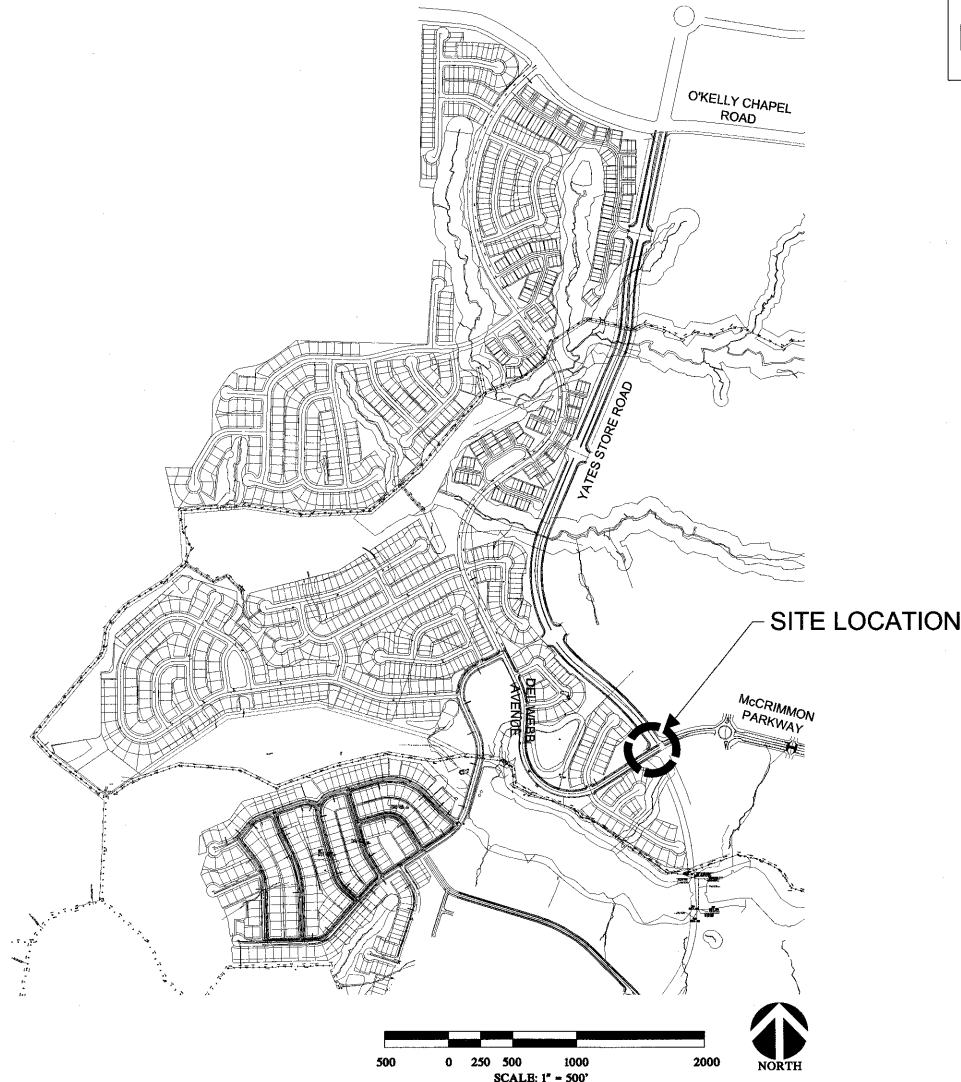

### OWNER

PULTE HOMES, INC. -- RALEIGH DIVISION

801 Corporate Center Drive  
Suite 118  
Raleigh, North Carolina 27607  
(919) 816-1100  
FAX (919) 816-1197

CONTACT: BOB KOSCSO

### LANDSCAPE ARCHITECT

NILES BOLTON ASSOCIATES

3060 Peachtree Road NW  
Suite 600  
Atlanta, Georgia 30305  
(404) 365-7600

CONTACT: GREGG HUDSPETH  
PAUL LASETER

CARY PROJECT NUMBER 05-SP-118  
APPROVED  
TOWN OF CARY

APPROVED BY: *DRC* DATE: 10-31-05  
PLANNING: *ST* DATE: 11-23-05  
ENGINEERING: *ST* DATE: 11-28-05