

KIM LIGHTING
 Sign / Wall Lighter 4300 Series
 120 Volt Extruded Aluminum - 1.5' x 18" Fluorescent
 Model: SM18
 Version: 09/09

Type:	Fixture Options:	Approvals:
Job:		
Fixture Catalog number:		
	Mounting Options:	Date:
		Page: 1 of 5

Specifications

Housing: One-piece extruded aluminum with die-cast armatures.

Details: Top, die-cast aluminum, with locking tabs and 1/2" x 1/4" brass NPT inserts. Mount fixture by 2x2 square set screw. Clear anodized prior to standard zinc-chromium conversion coating for added corrosion resistance.

Reflector: Semi-Alup®

Lens: Clear, flat acrylic, fully gasketed, recessed by a recessed extruded aluminum rail with recessed graphic sheeted bottom.

Socket: Medium beam recessed on reflector.

Wiring: Factory pre-wired with 1x2 18AWG solid 100% bulk conduit from each end.

Details: Electronic ballast (EFC) mounting. Variable voltage 130 through 277.

Finish: Super 1000 aluminum polyester powder coat paint. 2.5 mil overall thickness, applied over a standard zinc-chromium conversion coating. 2000 hour salt spray test endures mounting. Standard color: 40 9805 (RAL 7031, Titanium Dioxide) and Super Gloss (GG).

Certification: UL Listed (ULC) and CUL listed and certified for wet location. From manufacturer that employ a quality program that is certified to meet the ISO 9001:2000 standard.

Fixture	Length	Weight	Watts (Lamp(s))
4324	24"	1.4 lbs	110 (1) 14-watt T5 lamp
4325	30"	1.8 lbs	110 (1) 14-watt T5 lamp
4326	36"	2.2 lbs	110 (1) 14-watt T5 lamp
4327	42"	2.6 lbs	110 (1) 14-watt T5 lamp
4328	48"	3.0 lbs	110 (1) 14-watt T5 lamp
4329	54"	3.4 lbs	110 (1) 14-watt T5 lamp
4330	60"	3.8 lbs	110 (1) 14-watt T5 lamp

NOTE: Electronic ballast operates 120 through 277 volt AC/100V. Electronic ballast must be used with pre-wired conduit.

Cat No. Finish:

RL	Black
CR	Clear Chrome
GR	Temp. Grey

NOTE: Do not use any other alloy products from direct swaging. Do not exceed 600 pound strength. Unlisted loads may be obtained in right page of appropriate length for size and condition.

MANUFACTURER:
KIM LIGHTING
 OR APPROVED EQUAL

MODEL:
4348 SIGN LIGHT
SM18 STANCHION MOUNT

COLOR:
BLACK

CONTACT:
JIM HOMINS, (770) 368-3762

QTY:
4

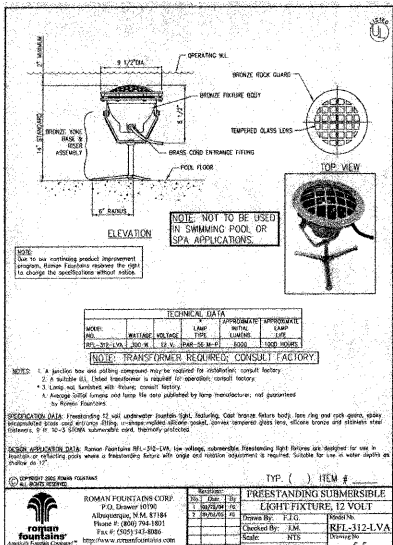

2. Underwater Uplight
 Not to Scale

MANUFACTURER:
WE-EF
 OR APPROVED EQUAL

MODEL:
607-1211-10-180
UNDERWATER LIGHT

NOTE:
ORIENT LENS FOR
HORIZONTAL APPLICATION

CONTACT:
LUMENSOURCE
MARK S. MIRZA
(770) 521-9940

QTY:
8

KIM LIGHTING
 120 Volt Die-Cast Aluminum, PAR38 Incandescent / Halogen
 Model: EL740
 Version: 04/05

Type:	Fixture Options:	Approvals:
Job:		
Fixture Catalog number:		
	Mounting Options:	Date:
		Page: 1 of 5

Specifications

Housing: Die-cast aluminum body, lamp housing and socket enclosure.

Details: Die-cast aluminum with locking tabs and 1/2" x 1/4" brass NPT inserts. Provide horizontal rotation independent of the bracket mount. Seal tested by 30 minutes salt spray. Clear anodized prior to zinc-chromium conversion coating for added corrosion resistance.

Lens Frame: Integral die-cast aluminum lens ring and glass flange.

Lens: Tinted clear soda lime glass with silicone gasket. Fit with lens frame to provide water-tight and protected joint.

Gasketing: Silicone gaskets used throughout.

Socket: Nickel plated lamp/fixture socket: 40W (pulsed rated).

Wiring: EFC/100V used 100%.
 Power: Super T5C, thermoseal polymer powder coat paint. 2.5 mil overall thickness, applied over a zinc-chromium conversion coating. 2000 hour salt spray test endures, rating standard color: 40 9805 (RAL 7031, Titanium Dioxide) and Super Gloss (GG).

Certification: UL Listed in U.S. and Canadian safety standards for wet locations. From manufacturer that employ a quality program that is certified to meet the ISO 9001:2000 standard.

Fixture	Weight	Watts	Wavelength
EL740	Black	40W	4000 - 1500 nm
EL740	Dark Bronze	40W	4000 - 1500 nm
EL740	Super Gloss	40W	4000 - 1500 nm

NOTE: Electronic ballast operates 120 through 277 volt AC/100V. Electronic ballast must be used with pre-wired conduit.

Cat No. Finish:

RL	Black
CR	Clear Chrome
GR	Temp. Grey

NOTE: Do not use any other alloy products from direct swaging. Do not exceed 600 pound strength. Unlisted loads may be obtained in right page of appropriate length for size and condition.

3. Accent Uplight
 Not to Scale

MANUFACTURER:
KIM LIGHTING
 OR APPROVED EQUAL

MODEL:
EL740
GROUND MOUNTED

COLOR:
BLACK

CONTACT:
TAYLOR AND LOCKRIDGE
JIM HOMINS
(770) 368-3762

QTY:
21

1. Sign Light
 Not to Scale

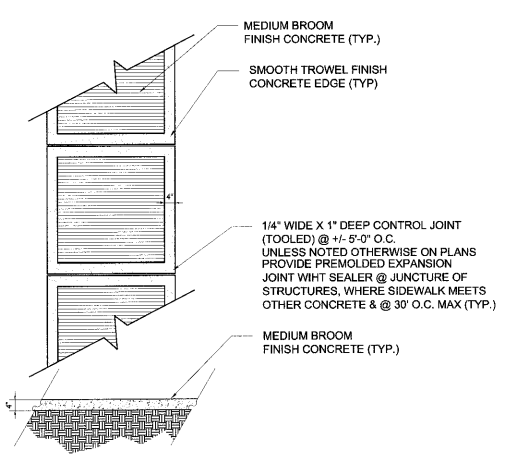

4. Concrete Sidewalk
 Scale: 1/2" = 1'-0"



JOB NUMBER: **304103.00**
 DRAWN BY: **PML**
 CHECKED BY: **GH**

Niles Bolton Associates, Inc.
 One Buckhead Plaza
 3080 Peachtree Road, NW
 Suite 600
 Atlanta, Georgia
 Phone: (404) 488-8500
 Fax: (404) 488-7610
 nba@nilesbolton.com

REVISIONS

DATE	DESCRIPTION

This drawing is an instrument of service, and shall remain the property of the consultant and shall not be reproduced, stored in a retrieval system, or used in any way without the permission of the Landscape Architect.

Carolina Preserve
 by *Dan Webb*
 A T A M B E R L Y
 Cary, North Carolina

SITE DETAIL

L-1.04

CARY PROJECT NUMBER 05-SP-118
 APPROVED
 TOWN OF CARY

APPROVED BY: **RDC** DATE: **10-31-05**
 PLANNING: **RDC** DATE: **11-23-05**
 ENGINEERING: **RB** DATE: **11-28-05**