

SITE LOCATION N.T.S.

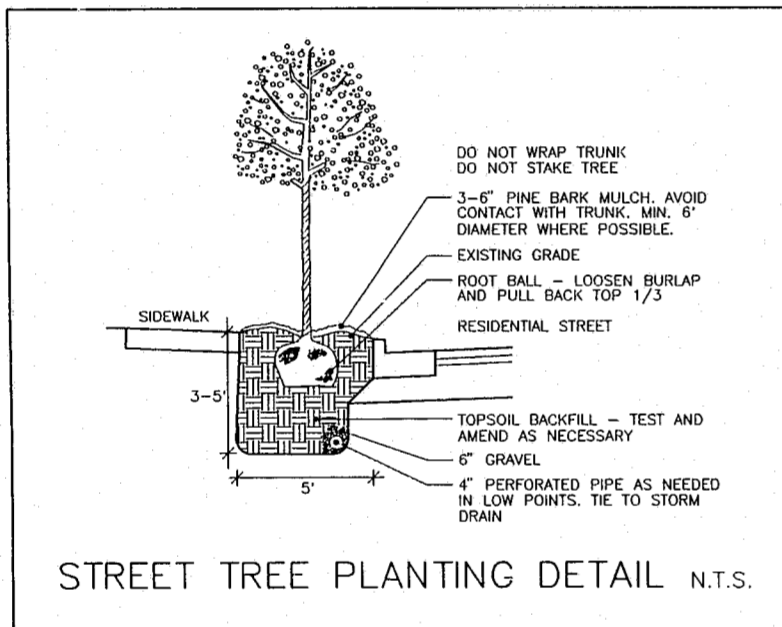

STREET TREE PLANTING DETAIL N.T.S.

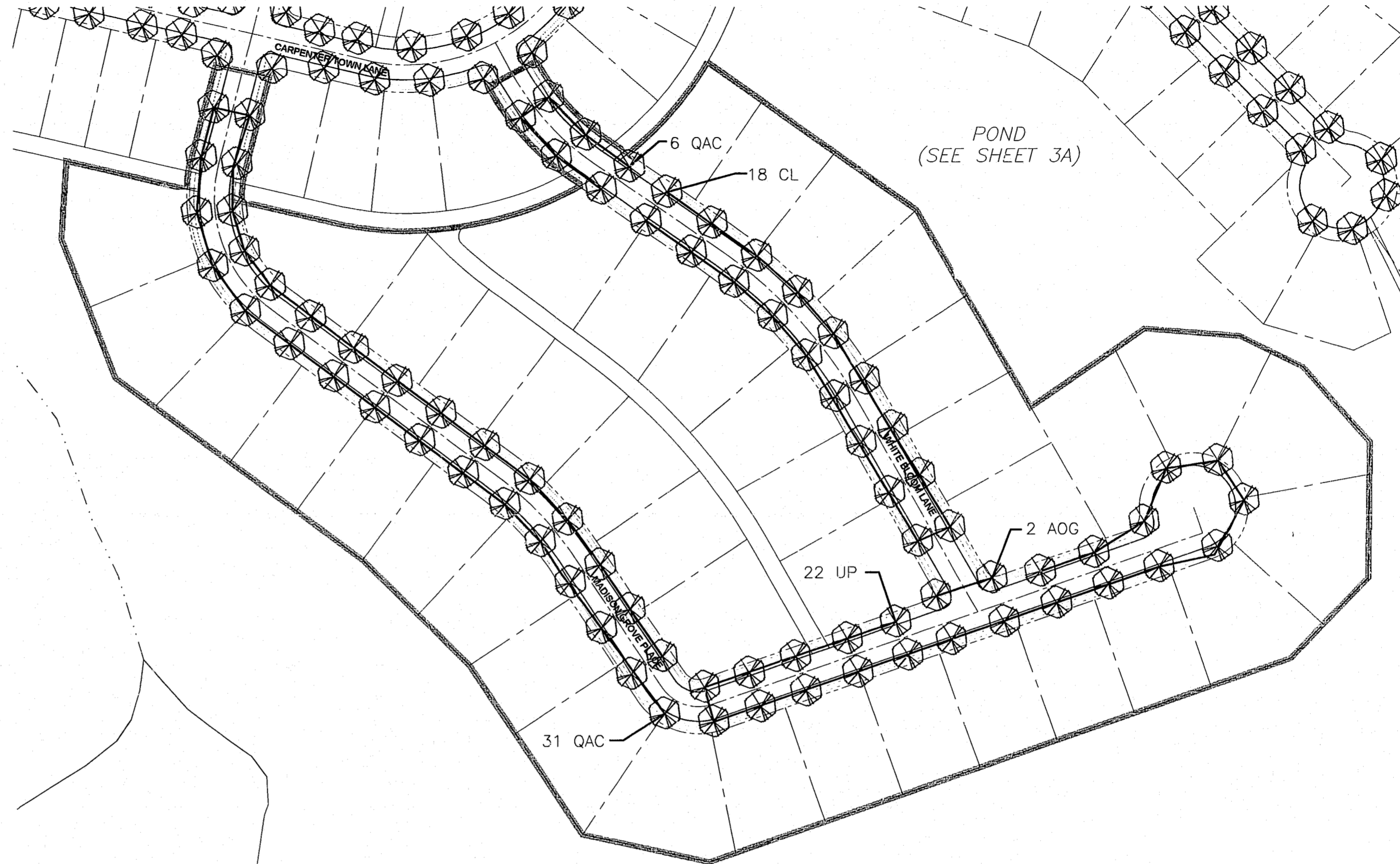

2	AOG	ACER RUBRUM 'OCTOBER GLORY'	OCTOBER GLORY RED MAPLE	50' o.c. TYP.	2"	CAL. MIN.
18	CL	CLADRASTIS LUTEA	AMERICAN YELLOWWOOD	50' o.c. TYP.	2"	CAL. MIN.
37	QAC	QUERCUS ACUTISSIMA	SAWTOOTH OAK	50' o.c. TYP.	2"	CAL. MIN.
22	UP	ULMUS PARVIFOLIA 'DRAKE'	DRAKE ELM	50' o.c. TYP.	2"	CAL. MIN.

Revisions

7/19/96	- TOC 1st Rev.
8/14/96	- Tree size Rev.



**CHARLES M. ELAM
& ASSOCIATES**

Urban Planning /
Landscape Architecture

975 Walnut Street
Suite 261
Cary, North Carolina 27511
919/467-0577

CARPENTER VILLAGE
PHASES 1H & 3C; PARCEL B
CARY, NORTH CAROLINA

**STREET TREE
PLANTING
PLAN**

Drawn By: _____

Checked By: _____

Date: 28 JUNE 1996

Sheet 1A

