

PLANT LIST

8	AQG	ACER RUBRUM	OCTOBER GLORY RED MAPLE	50' O.C.	2" CAL
8	QAC	QUERCUS ACUTISSIMA	SAWTOOTH OAK	50' O.C.	2" CAL
40	QAL	QUERCUS ALBA	WHITE OAK	50' O.C.	2" CAL
20	QR	QUERCUS RUBRA	RED OAK	50' O.C.	2" CAL

- ANY STREETSCAPE TREES WITHIN THE SIGHT TRIANGLES WILL BE LIMBED-UP TO 6'.
- UTILITY EQUIPMENT AND FACILITIES ASSOCIATED WITH ON-SITE ELECTRIC, CABLE, STORM DRAINAGE FACILITIES, TELEPHONE, GAS, OR OTHER SIMILAR UTILITIES SHALL BE SCREENED WHERE POSSIBLE WITH EVERGREEN PLANTINGS. DWARF BURFORD HOLLIES SHALL BE PLANTED TO FULFILL THIS REQUIREMENT, AND SHALL BE 24" IN HEIGHT, PLANTED 3' ON CENTER.
- ALL EXISTING VEGETATION WILL BE PRESERVED TO THE MAXIMUM EXTENT POSSIBLE (THIS APPLIES TO INDIVIDUAL LOTS).

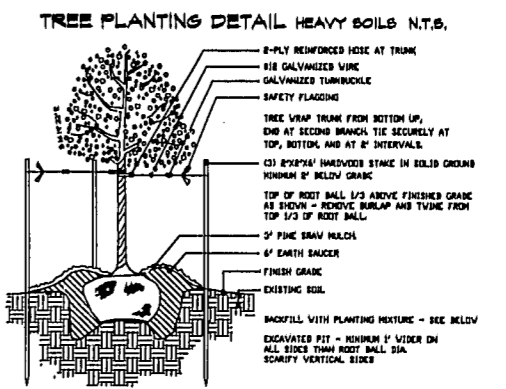
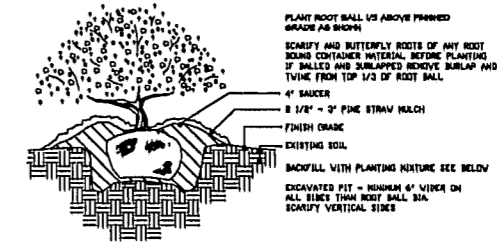

NOTE ON LOT LANDSCAPING:
 ONE CANOPY TREE (2" CALIPER, 6' HT. MIN) SHALL BE PLANTED IN EACH REAR YARD. CANOPY TREES CAN BE ANY OF THOSE LISTED IN THE PLANT LIST TABLE. FIVE EVERGREEN SHRUBS SHALL BE PLANTED AS FOUNDATION PLANTS, MIN 3 GAL. CONTAINER AND 24" TALL.
 WHERE REAR YARDS ABUT EACH OTHER, WITH NO INTERVENING ALLEY, FOUR ADDITIONAL EVERGREEN SHRUBS SHALL BE PLANTED.

* NO FENCES SHALL BE PLACED IN A BUFFER OR WITHIN THE COMMON OPEN SPACES ALONG LOUIS STEPHENS DRIVE UNLESS INSTALLED AT ONE TIME FOR THE ENTIRE LENGTH OF THE STREETSCAPE BUFFER. INDIVIDUAL LOT OWNERS SHALL NOT INSTALL FENCES IN A PIECEMEAL FASHION. PRIOR TO PLACING A FENCE IN A STREETSCAPE OR BUFFER, THE FENCE SHALL BE SUBMITTED TO AND APPROVED BY THE TOWN OF CARY. ALL FENCES SHALL BE UNIFORM IN DIMENSIONS, MATERIALS AND COLOR(S).

* NOTE:
 ALL SHRUBS ARE TO BE 24" TALL AND 3 GALLON AT TIME OF INSTALLATION.
 ALL TREES ARE TO BE AT LEAST 2" CAL AND 8' TALL AT TIME OF INSTALLATION.

APPROVED
 TER 11-3-99
 JPP 11/15/99

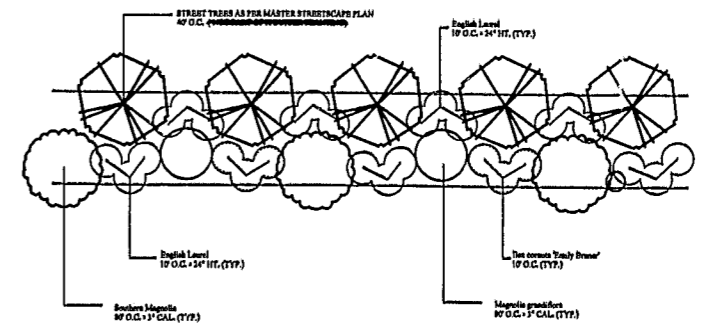

BY THE TOWN OF CARY
LOUIS STEPHENS DRIVE
 TYPICAL PLANTING FOR PHASE 16

ETd
 KRAM, TODD & PAMERSON, PA
 Urban Planning /
 Landscape Architecture
 2601 Weston Parkway
 Suite 203
 Cary, North Carolina 27513
 (919) 678-1871
 ETDOBELLSOUTH.NET

DEVELOPER:
 W & W PARTNERS
 150 CORNERSTONE DR.
 SUITE 150
 CARY, NORTH CAROLINA 27513

ENGINEER:
 HUGH J. GILLRICH & ASSOC.
 875 WALNUT STREET
 SUITE 350
 CARY, NORTH CAROLINA 27511

Drawn By: EVC
 Checked By: BITT
 Date: 4-12-99
 Proj#: 9904005

Revisions
 5/17/99 TOC REV.
 6/14/99 TOC 2nd REV
 7/12/99 TOC 3RD REV
 8/13/99 TOC 4TH REV
 10/25/99 TOC 5TH REV



CARPENTER VILLAGE
 PORTION OF PARCEL G
 CONSTRUCTION PHASE 16
 CARY, NORTH CAROLINA

STREETSCAPE
 AND UNIT PLANTING

PHASE 16

Sheet

2

DAVID STUART FERRELL
 PARCEL A
 PIN NO. 735.04-91-4493
 UNDEVELOPED

