

LINETYPE LEGEND			LEGEND SYMBOLS	
EXISTING	NAME	PROPOSED	ABBREV.	SYM. NAME
— H —	WATER LINE	— G —	MHPR	● PROPOSED MAN HOLE
— G —	GAS LINE	— G —	MH EX	○ EXISTING MAN HOLE
— OE —	OVERHEAD ELECTRIC	— OE —	FESPR	▶ PROPOSED FLARED END SECTION
— UE —	UNDERGROUND ELECTRIC	— UE —	FESEX	▷ EXISTING FLARED END SECTION
— OT —	OVERHEAD TELEPHONE	— OT —	YIPR	◻ PROPOSED YARD INLET
— UT —	UNDERGROUND TELEPHONE	— UT —	YIEK	◻ EXISTING YARD INLET
— SD —	STORM DRAIN	— SD —	CBPR	■ PROPOSED CATCH BASIN
— SS —	SANITARY SEWER	— SS —	CBEX	■ EXISTING CATCH BASIN
— FM —	FORCE MAIN	— FM —	VINLET	◻ PROPOSED V INLET
— CL —	CENTERLINE	— CL —	SEDBASIN	○ PROPOSED SEDIMENTATION BASIN
— PL —	PHASE LINE	— PL —		
— X —	FENCE LINE	— X —		
— SF —	SILT FENCE LINE	— SF —		
— SL —	STREAM LINE	— SL —		
— TL —	TREE LINE	— TL —		
— CG —	CURB & GUTTER LINE	— CG —		
— CL —	CONTOUR LINE	— CL —		
— IC —	INDEX CONTOUR LINE	— IC —		
— PL —	PROPERTY LINE	— PL —		
— SD —	SWALE/DITCH LINE	— SD —		
— GR —	GUARD RAIL LINE	— GR —		
— EL —	EASEMENT LINE	— EL —		
— RL —	ROW LINE	— RL —		
— FL —	FLOW LINE	— FL —		
— TD —	TEMP DIVERSION LINE	— TD —		
— CL —	CUT LIMITS	— CL —		
— FL —	FILL LIMITS	— FL —		
— RP —	RIGHT PROFILE	— RP —		
— LP —	LEFT PROFILE	— LP —		

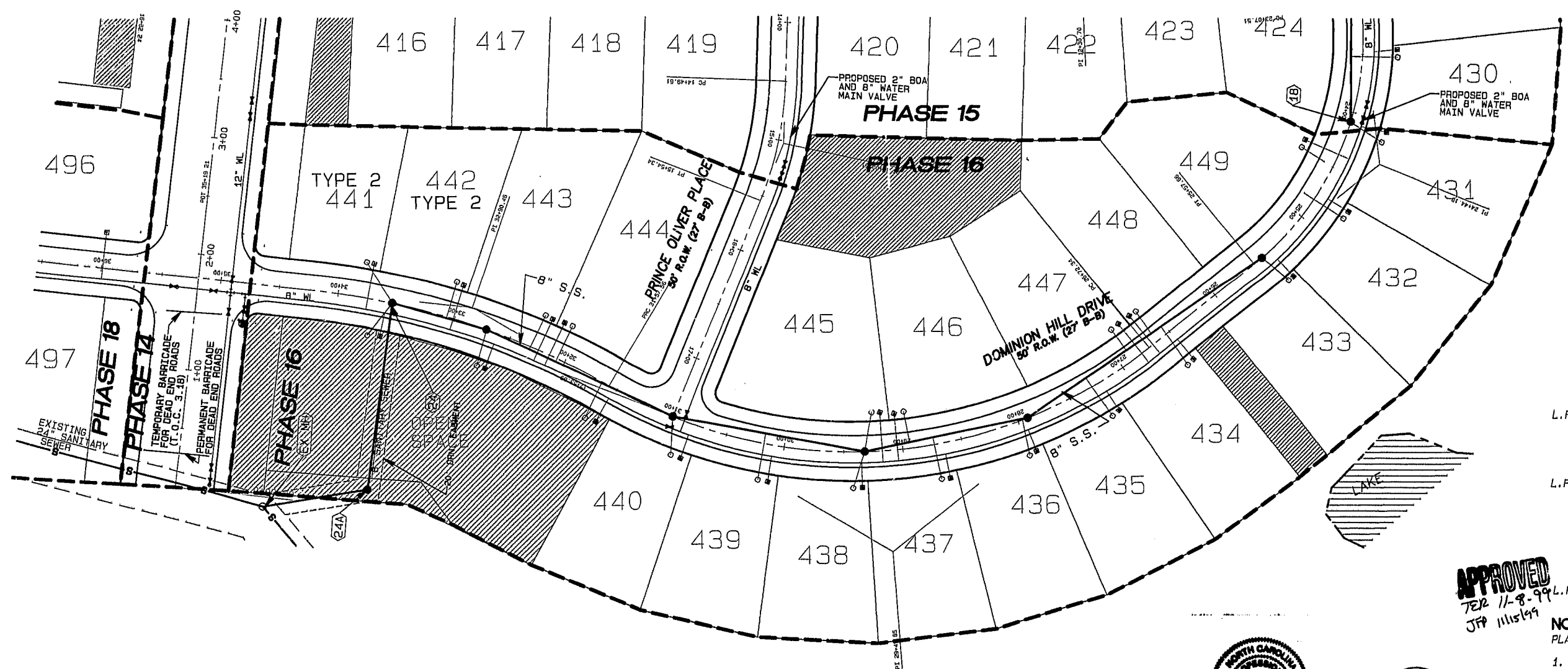

ABBREV.	SYM.	NAME
MH EX	○	EXISTING MAN HOLE
FESPR	▶	PROPOSED FLARED END SECTION
FESEX	▷	EXISTING FLARED END SECTION
YIPR	◻	PROPOSED YARD INLET
YIEK	◻	EXISTING YARD INLET
CBPR	■	PROPOSED CATCH BASIN
CBEX	■	EXISTING CATCH BASIN
VINLET	◻	PROPOSED V INLET
SEDBASIN	○	PROPOSED SEDIMENTATION BASIN

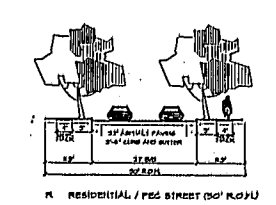

L.F. ROADS = 1,213 L.F. (STREET A)
 255 L.F. (STREET D)
 338 L.F. (STREET E)
 TOTAL = 1,806 L.F.

L.F. WATER LINE = 1,213 L.F. (8" STREET A)
 255 L.F. (8" STREET D)
 338 L.F. (12" STREET E)
 TOTAL = 1,468 L.F. OF 8"
 338 L.F. OF 12"

APPROVED
 JEP 11-8-99
 JFP 11/15/99

L.F. SAN. SEWER = 1,175 L.F. (8" PVC, STREET A)
 631" DIP Total 1051

NOT FOR CONSTRUCTION
 PLANS FOR INFRASTRUCTURE ONLY

- ALL CONSTRUCTION SHALL BE IN ACCORDANCE W/ TOWN OF CARY STANDARD SPECS AND DETAILS.
- CONTRACTOR SHALL BE RESPONSIBLE FOR VERIFICATION OF EXISTING CONDITIONS. CONTRACTOR SHALL NOTIFY ENGINEER OF DISCREPANCIES BETWEEN FIELD CONDITIONS AND THESE DRAWINGS.
- NO 100 YEAR FLOOD ZONE.
- VELOCITY REDUCTION PADS SHALL BE INSTALLED AFTER T.O.C. AUTHORIZES REMOVAL OF SEDIMENT BASINS.
- PROJECTED SANITARY FLOWS = 22 LOTS X 280GPD/UNIT = 6160 GPD.
- A DEVELOPER AGREEMENT WILL BE SUBMITTED PRIOR TO BIDDING THE PROJECT OR THE DEVELOPER FORFEITS THEIR REQUEST FOR A DEVELOPER AGREEMENT.

