

PRINCE OLIVE PLACE

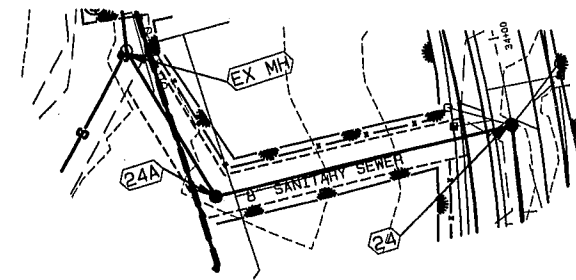

OUTFALL A

NOTES

1. WATER LINE MATERIAL SHALL BE DIP.
2. SANITARY SEWERS SHALL BE LAID AT LEAST 10' LATERALLY FROM EXISTING OR PROPOSED WATER MAINS UNLESS THE TOP OF THE SEWER MAIN IS AT LEAST 18" BELOW THE BOTTOM OF THE WATER MAIN AND THERE IS A HORIZONTAL SEPARATION OF AT LEAST 3'. MAINTAIN AT LEAST 12" BETWEEN THE TOP OF SANITARY SEWER MAINS AND THE BOTTOM OF STORM SEWER PIPES.
3. AIR RELEASE VALVES SHALL BE INSTALLED AT ALL WATER LINE HIGH POINTS ON LINES 8" OR LARGER.
4. ALL WATER LINES SHALL HAVE 3' MINIMUM COVER FROM FINISHED SUBGRADE.

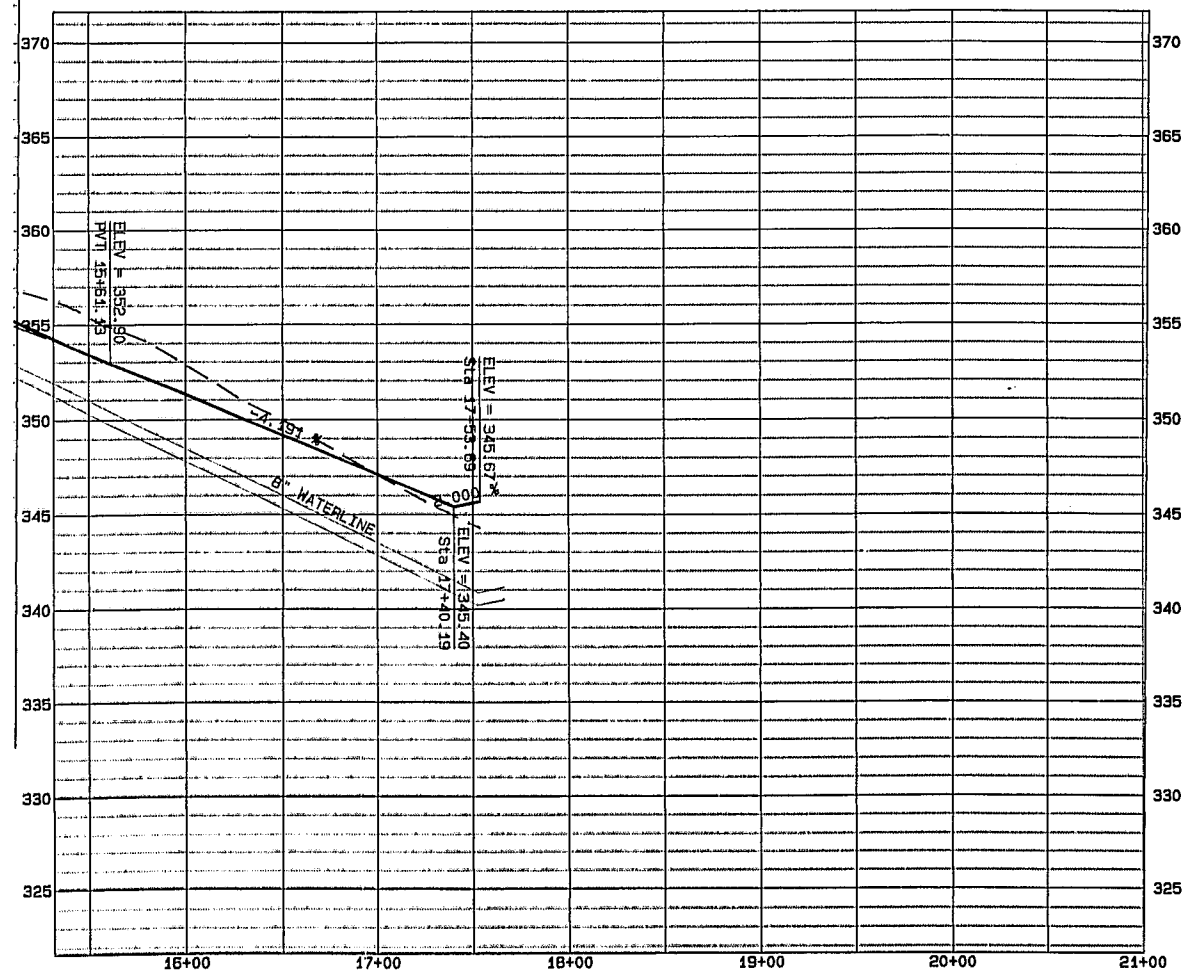
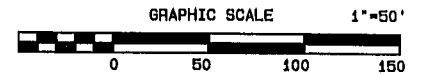

CARPENTER VILLAGE PHASE 16

PROFILE

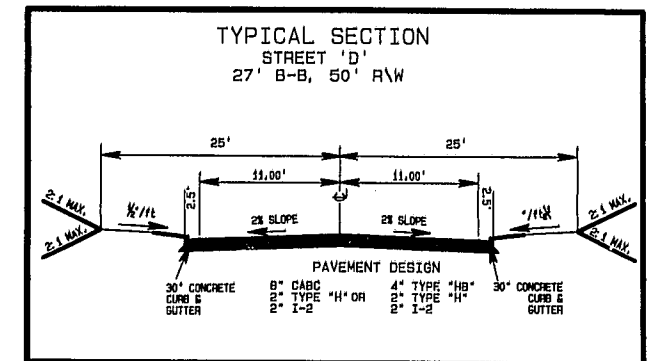
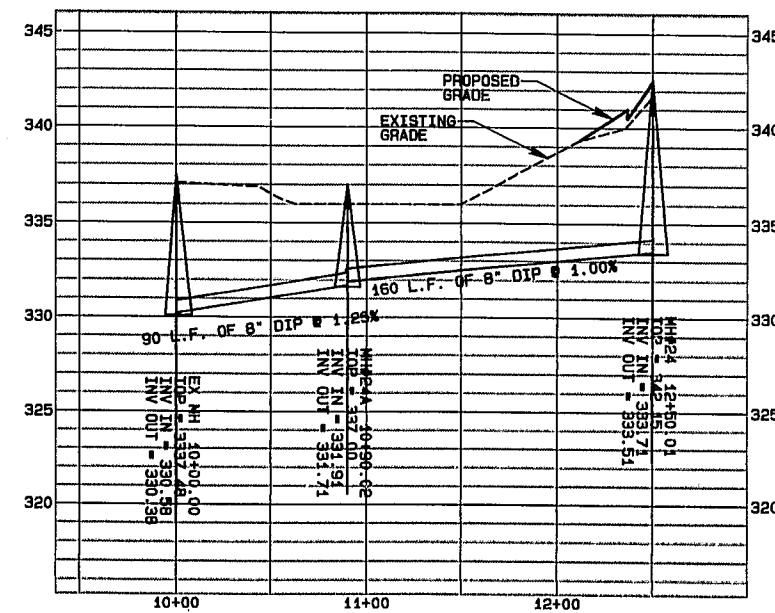

APPROVED
 TJP 11-8-99
 JTP 11/15/99



[Signature]
 14 Oct. 99

Hugh J. Gilleece and Associates
 875 Walnut St. Suite 350 Cary, NC ph(919)469-1101 fax(919)460-7637

Revisions:

(H) Scale: 1"=50'	Designed by:	Sheet:
(V) Scale: 1"=5 ft.	Drawn by:	5
0: 1369014-1892_PRO	Date:	10/18/1999