

PEGGY E. HATCHER  
PIN NO. 735.04-82-6882

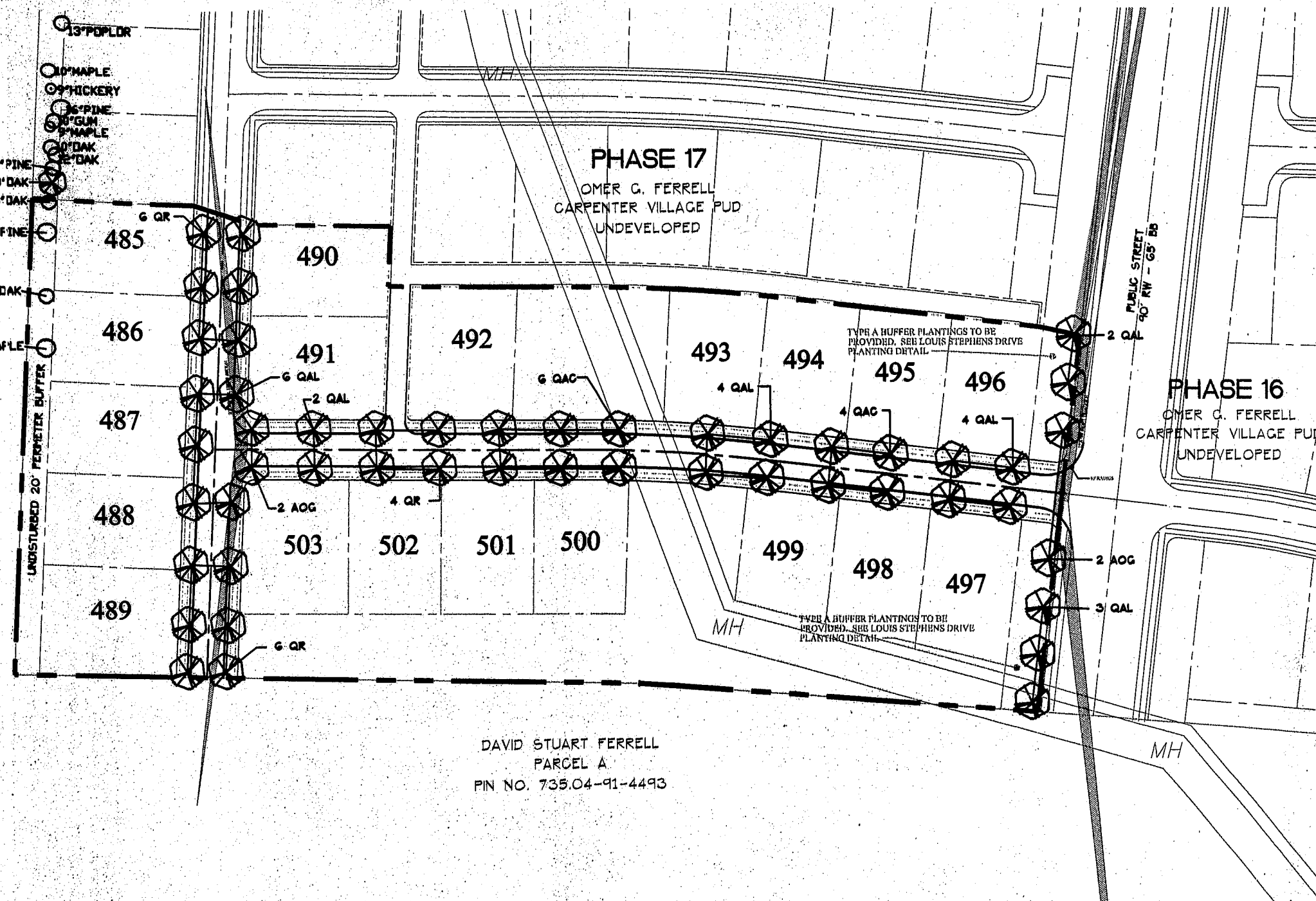

DAVID STUART FERRELL  
PARCEL A  
PIN NO. 735.04-91-4493



**PLANT LIST**

4	AOG	ACER RUBRUM	OCTOBER GLORY RED MAPLE	50' O.C.	4"	CAL.
16	QR	QUERCUS RUBRA	RED OAK	50' O.C.	4"	CAL.
21	QAL	QUERCUS ALBA	WHITE OAK	50' O.C.	4"	CAL.
10	QAC	QUERCUS ACUTISSIMA	SAWTOOTH OAK	50' O.C.	4"	CAL.

- ANY STREETSCAPE TREES WITHIN THE SIGHT TRIANGLES WILL BE LIMBED-UP TO 6'.
- TREE PLANTINGS WITHIN THE 20' PERIMETER BUFFER WILL BE A MINIMUM OF 2.5" CALIPER AND 8' TALL AT THE TIME OF INSTALLATION.
- UTILITY EQUIPMENT AND FACILITIES ASSOCIATED WITH ON-SITE ELECTRIC, CABLE, STORM DRAINAGE FACILITIES, TELEPHONE, GAS, OR OTHER SIMILAR UTILITIES SHALL BE SCREENED WHERE POSSIBLE WITH EVERGREEN PLANTINGS. DWARF BURFORD HOLLIES SHALL BE PLANTED TO FULFILL THIS REQUIREMENT, AND SHALL BE 24" IN HEIGHT, PLANTED 3" ON CENTER.
- ALL EXISTING VEGETATION WILL BE PRESERVED TO THE MAXIMUM EXTENT POSSIBLE (THIS APPLIES TO THE INDIVIDUAL LOTS).

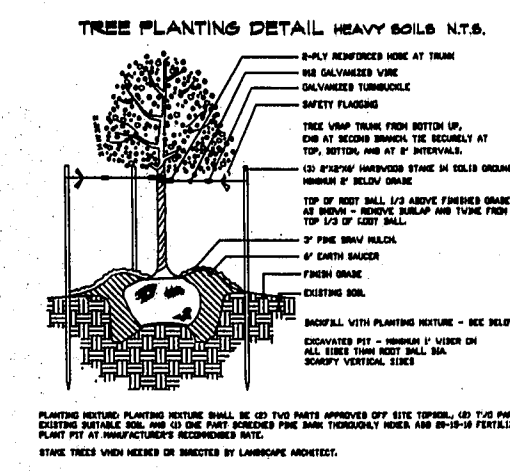
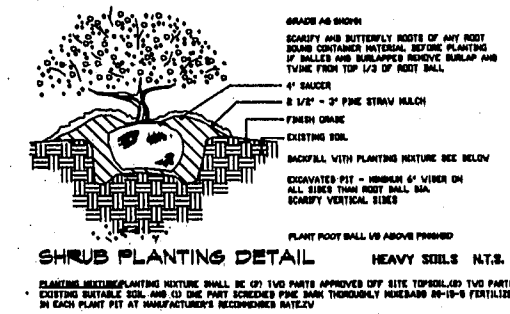

**NOTE ON LOT LANDSCAPING**  
ONE CANOPY TREE (2" CALIPER, 8' HT. MIN) SHALL BE PLANTED IN EACH REAR YARD. CANOPY TREES CAN BE ANY OF THOSE LISTED IN THE PLANT LIST TABLE. FIVE EVERGREEN SHRUBS SHALL BE PLANTED AS FOUNDATION PLANTS, MIN. 3 GAL. CONTAINER AND 24" TALL.  
WHERE REAR YARDS ADJUT EACH OTHER, WITH NO INTERVENING ALLEY, FOUR ADDITIONAL EVERGREEN SHRUBS SHALL BE PLANTED.

\* NO FENCE SHALL BE PLACED IN A BUFFER OR WITHIN THE COMMON OPEN SPACE ALONG LOUIS STEPHENS DRIVE UNLESS INSTALLED AT ONE TIME FOR THE ENTIRE LENGTH OF THE STREETSCAPE BUFFER. INDIVIDUAL LOT OWNERS SHALL NOT INSTALL FENCES IN A PIECEMEAL FASHION. PRIOR TO PLACING A FENCE IN A STREETSCAPE OR BUFFER, THE FENCE SHALL BE SUBMITTED TO AND APPROVED BY THE TOWN OF CARY. ALL FENCES SHALL BE UNIFORM DIMENSIONS, MATERIALS AND COLOR(S).

\* NOTE:  
ALL SHRUBS ARE TO BE 24" TALL AND 3 GALLON AT TIME OF INSTALLATION. ALL TREES ARE TO BE AT LEAST 2" CAL. AND 8' TALL AT TIME OF INSTALLATION.

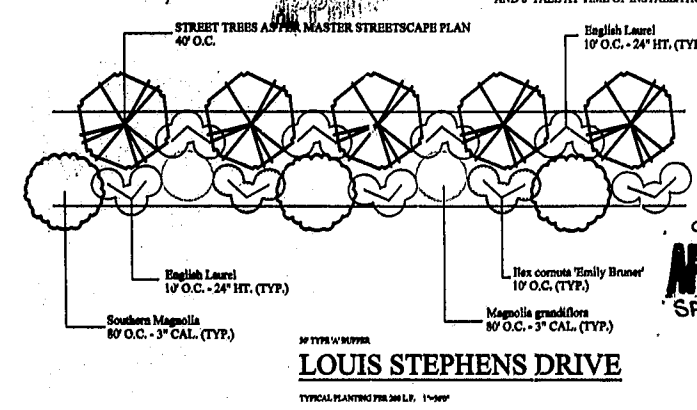
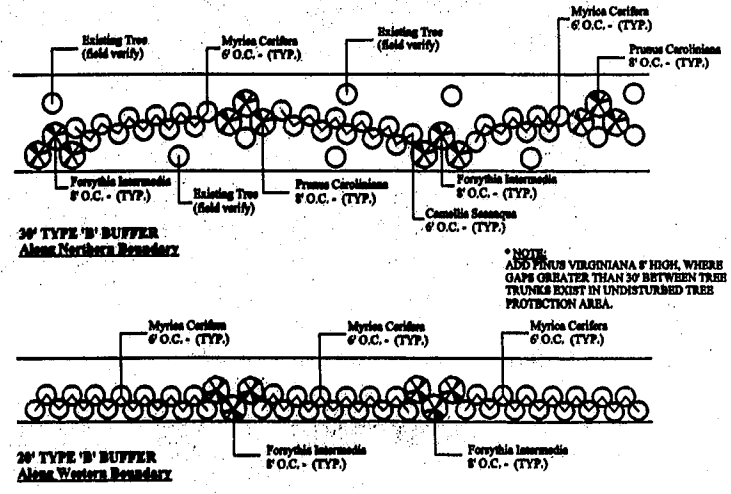

99-SB-017  
APPROVED  
SP 2-1-00

**ETd**  
ELAM, TODD & FAMBROSI, PA

Urban Planning /  
Landscape Architecture  
2601 Weston Parkway  
Suite 283  
Cary, North Carolina 27513  
(919) 478-1971  
ETD@BELLSOUTH.NET

DEVELOPER:  
W & W PARTNERS  
150 CORNERSTONE DR.  
SUITE 150  
CARY, NORTH CAROLINA 27513

ENGINEER:  
HUGH J. GILLRICH & ASSOC.  
875 WALNUT STREET  
SUITE 350  
CARY, NORTH CAROLINA 27511

Drawn By: EVC  
Checked By: BIT  
Date: 6-08-99  
Proj#: 9904007

Revisions  
5/17/99 TOC REV.  
6/14/99 TOC 2nd REV  
7/12/99 TOC 3RD REV  
8/13/99 TOC 4TH REV  
10/11/99 TOC 5TH REV



CARPENTER VILLAGE  
PORTION OF PARCEL H  
CONSTRUCTION PHASE 18  
CARY, NORTH CAROLINA

STREETSCAPE  
AND UNIT PLANTING

PHASE 18

Sheet

2