

CARY ALLIANCE CHURCH

4108 TEN TEN ROAD

CARY, NORTH CAROLINA

CARY ALLIANCE CHURCH
4108 TEN TEN ROAD
CARY, NORTH CAROLINA

SITE DATA

PROJECT:	CARY ALLIANCE CHURCH
PREPARER:	CPS ENGINEERS, PA
PREPARER'S CONTACT:	JIM CHANDLER, PE 7621 PURFOY ROAD, SUITE 201 FUQUAY-VARINA, NC 27526 PHONE: 919-552-4845 FAX: 919-552-6962 EMAIL: jchandler@cpsengineerspa.com
DEVELOPER:	POLYGON CONSTRUCTION GROUP, INC. 557-D PYLON DRIVE RALEIGH, NC 27606
DEVELOPER CONTACT:	CHRIS G. PAPPAS PHONE: 919-481-3858 FAX: 919-481-0390
OWNER:	CARY ALLIANCE CHURCH 555 SW MAYNARD ROAD CARY, NC 27511-4310
PROPERTY LOCATION:	4108 TEN TEN ROAD CARY, NC
PIN:	076002684403
ZONING:	O&I CU
PROPOSED USE:	VACANT/CHURCH
TOTAL TRACT AREA:	20.21 ACRES
WATER SHED:	NEUSE RIVER BASIN
ZONING OVERLAY DISTRICT:	FAIRVIEW MIXED-USE CENTER
REAL ID NUMBER:	0055435
CARY PROJECT NUMBER:	07-SP-015

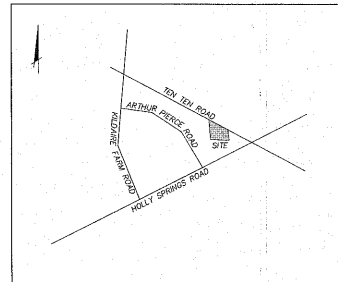

VICINITY MAP - SCALE: 1" = 1000'

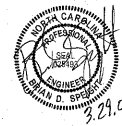
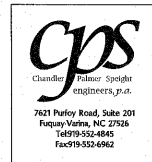

SHEET INDEX

- C1.01 - EXISTING CONDITIONS AND DEMO PLAN
- C2.01 - SITE OVERALL PLAN
- C3.01 - SITE LAYOUT PLAN
- C3.02 - SITE LAYOUT PLAN
- C4.01 - SITE GRADING PLAN
- C4.02 - SITE GRADING PLAN
- C5.01 - SEDIMENTATION AND EROSION CONTROL PLAN
- C6.01 - SITE UTILITY PLAN
- C6.02 - SANITARY SEWER PLAN/PROFILE
- C6.03 - WATER MAIN PLAN/PROFILE (STA. 10+00 - 21+50)
- C6.04 - WATER MAIN PLAN/PROFILE (STA. 21+50 - 32+07.42)
- C6.05 - STORM SEWER PLAN/PROFILE
- C7.01 - SITE LANDSCAPE PLAN
- C7.02 - LANDSCAPE DETAILS
- C8.01 - SR 1010 ROAD WIDENING PLAN/PROFILE
- C9.01 - SITE DETAILS
- C9.02 - SITE DETAILS
- C9.03 - SITE DETAILS
- C9.04 - SITE DETAILS
- C9.05 - SITE DETAILS
- C9.06 - SITE DETAILS
- C10.01 - PROGRESS ENERGY SITE LIGHTING PLAN
- C10.02 - PROGRESS ENERGY SITE LIGHTING PLAN
- A1 - OVERALL FLOOR PLAN
- A1A - PHASE 1 FLOOR PLAN
- A2 - LEFT AND FRONT BUILDING ELEVATIONS
- A3 - RIGHT AND REAR BUILDING ELEVATIONS

07-SP-015
APPROVED
TOWN OF CARY

Approved by DRC Date 04-23-07
Planning JEB Date 05-18-07
Engineering IS Date 5-21-07