

REVISIONS

DATE	BY	DESCRIPTION
02/20/07	CS	TOWN OF CARY REVIEW COMMENTS

CONSTRUCTION DOCUMENT

**CARY ALLIANCE CHURCH**  
**4108 TEN TEN ROAD**  
**CARY, NORTH CAROLINA**

DESIGNED BY	CS
ENGINEERED BY	CPS
PROJECT NO.	07-SP-015
DRAWN BY	TS
DATE	2/20/07
PROJECT NUMBER	06-014

SR 1010 ROAD  
 WIDENING  
 PLAN/PROFILE

**C8.01**

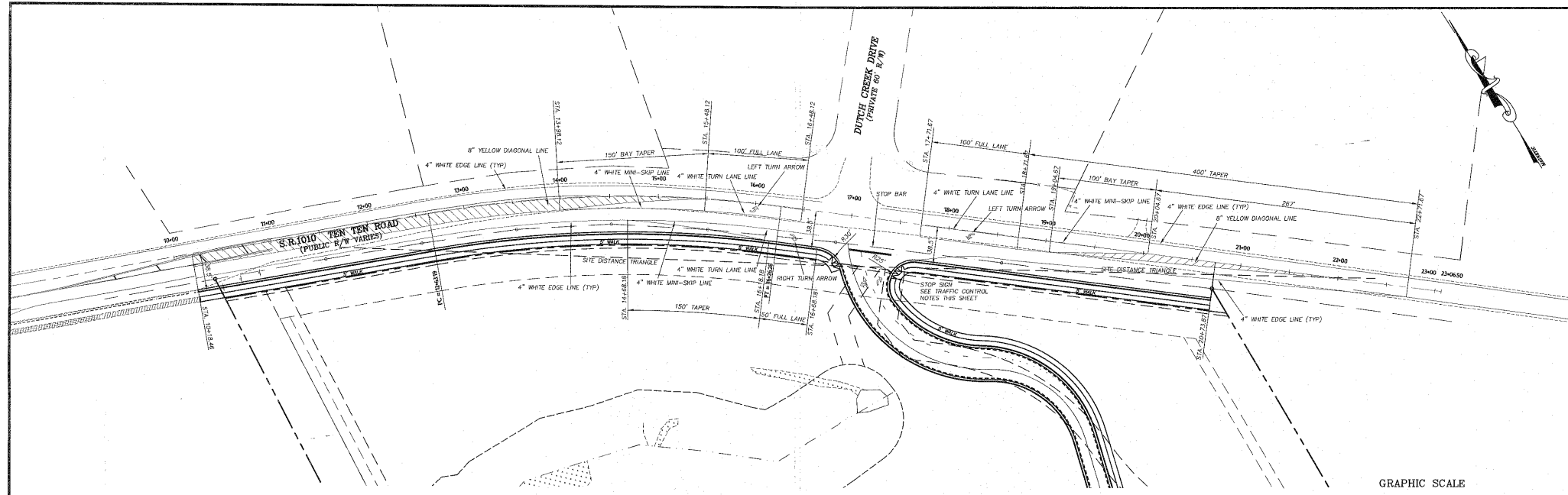

TEN TEN ROAD WIDENING PLAN/PROFILE  
 STA 10+00.00 THRU 23+65.50

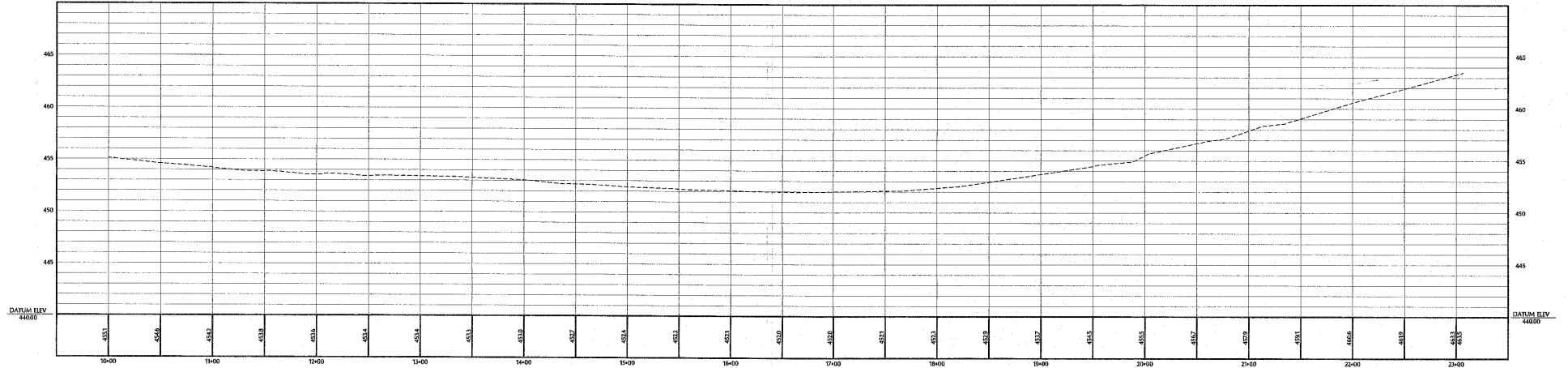
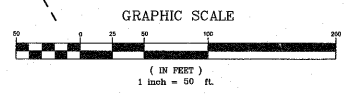

**NOTES**

- ALL SITE SIGNAGE SHALL BE IN ACCORDANCE WITH THE MANUAL ON UNIFORM TRAFFIC CONTROL DEVICES (MUTCD) AND NCDOT STANDARDS.  
 SIGN - MUTCD STD. - SIZE -  
 STOP - R1-1 - 30"x30"  
 ALL SIGNS SHALL BE MOUNTED WITH 3/4" MIN. VERTICAL CLEARANCE TO THE BOTTOM OF THE SIGN ON 2-1/8" GALV. STEEL U-CHANNEL POST SET IN 3-FT DEEP x 12-IN DIA. CONCRETE FOOTING.
- ALL CONSTRUCTION AND PAYMENT MARKINGS SHALL BE IN ACCORDANCE WITH THE MUTCD AND NCDOT STANDARDS AND SPECIFICATIONS.
- MARKINGS - NCDOT STD. - SIZE - COLOR -  
 DIRECTIONAL ARROWS - 1205-08 - STD. - WHT.  
 STOP BAR - 1203-01 - 24"-IN - WHT.  
 SKIP - - - - - 4"-IN - WHT.  
 MINI-SHIP - - - - - 4"-IN - WHT.  
 DOUBLE SOLID - (2) 4"-IN - YEL.  
 DIAGONAL LINE - 8"-IN - YEL.
- ALL PAYMENT MARKINGS SHALL BE THERMOPLASTIC.
- ALL SIGNAGE SHALL BE FIELD STAKED AND THE LOCATIONS APPROVED BY NCDOT INSPECTOR PRIOR TO SIGN INSTALLATION.
- CENTER ALL DIRECTIONAL ARROWS WITHIN TRAVEL LANE.
- TRAVEL LANES SHALL BE STRIPPED AS THREE-12' LANES. SEE NCDOT STD. 1205-05 FOR TURN LANE STRIPING DETAIL. SEE CARY STA. 03500.15 FOR STANDARD PAVEMENT WIDENING TAPER & MARKINGS DETAIL.
- PAYMENT DESIGN SHALL BE PER THE APPROVED NCDOT ENCROACHMENT AGREEMENT.

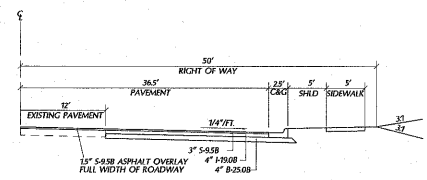

TYPICAL PARTIAL STREET SECTION TEN TEN ROAD

07-SP-015  
 APPROVED  
 TOWN OF CARY  
 Approved by **DRC** Date **04-23-07**  
 Planning **JOB** Date **06-18-07**  
 Engineering **TS** Date **5-21-07**