

SITE IMPROVEMENT PLANS FOR CARY AUTO MALL TRACT A & B CARY, NORTH CAROLINA

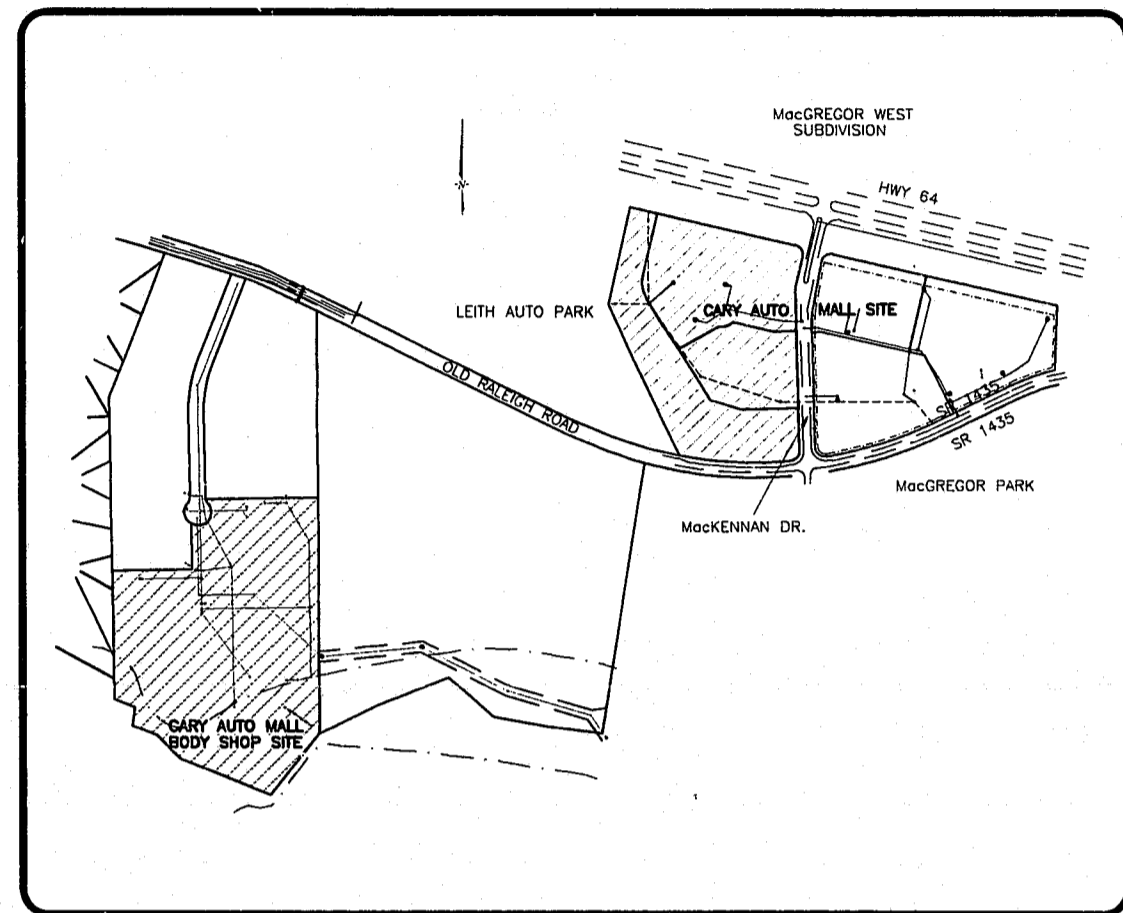

VICINITY MAP
SCALE: 1" = 500'

LEGEND

DESCRIPTION	EXISTING	PROPOSED
2' CONTOUR INTERVAL	-----	-----
10' CONTOUR INTERVAL	-----	-----
PROPERTY LINE	=====	=====
ROADWAY CENTERLINE	-----	-----
RIGHT OF WAY LIMITS	-----	-----
EASEMENT LINE	-----	-----
CURB & GUTTER	-----	-----
SANITARY SEWER FACILITIES	⊙	⊙
STORM SEWER FACILITIES	⊕	⊕
WATERLINE	⊗	⊗
FIRE HYDRANT ASSEMBLY	⊕	⊕
FENCING STRUCTURE	○	○
WOODSLINE		N/A
WATERWAYS	---	N/A
SILT FENCING	N/A	///

INDEX OF SHEETS

OVERALL SITE PLAN	SH1
DETAILED SITE PLAN	SH2
WATER, SEWER, STORM, & EROSION CONTROL PLAN	SGT3
LANDSCAPE PLAN	SH4
DETAILS	SH5
DETAILS	SH6
LIGHTING PLAN	SH10

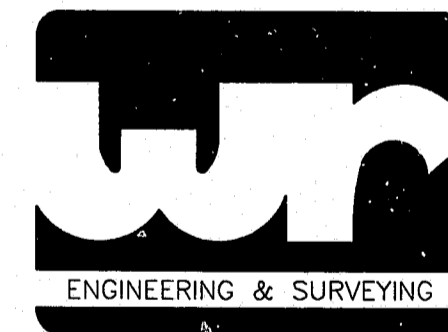

WITHERS & RAVENEL
Engineering & Surveying, Inc.

1149 Executive Circle
Cary, N.C. 27511

PHONE : 919-469-3340
FAX : 919-467-6008



**JERRY TURNER
& ASSOCIATES**

LANDSCAPE ARCHITECTURE
LAND PLANNING
ENVIRONMENTAL DESIGN

905 JONES FRANKLIN ROAD
RALEIGH, NORTH CAROLINA 27606
(919) 851-7150

82 S.E. 6TH AVENUE
DELRAY BEACH, FLORIDA 33483
(407) 276-0453

APPROVED
DATE: 10-4-95
BY: JH Tucker
TOWN OF CARY ENGINEERING DEPARTMENT

OFFICIAL APPROVED PLAN

95-50-142-MOD

APPROVED

9-7-95

Removal of proposed bldg parking addition
RHT

FINAL APPROVED PLANS