

SITE IMPROVEMENT PLANS FOR CARY AUTO MALL

CARY, NORTH CAROLINA

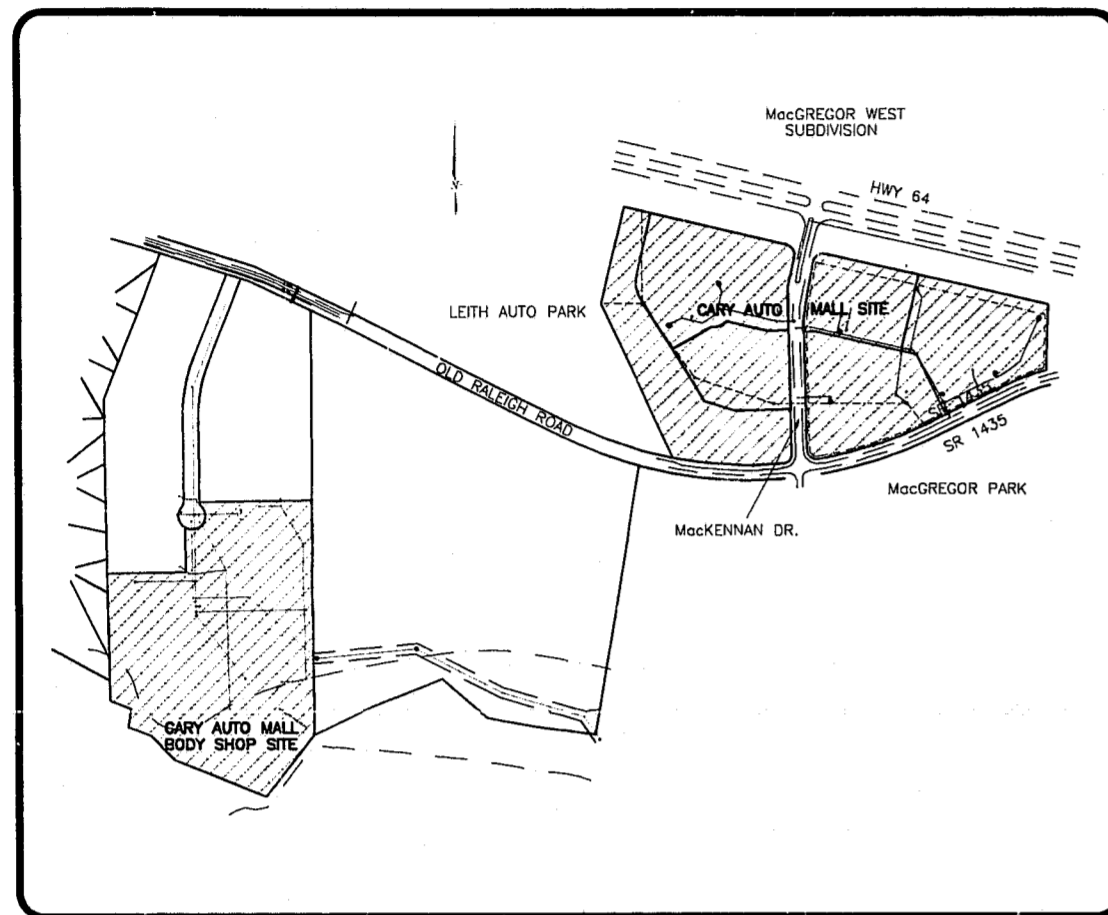

VICINITY MAP
SCALE: 1" = 500'

LEGEND

DESCRIPTION	EXISTING	PROPOSED
2' CONTOUR INTERVAL	-----	=====
10' CONTOUR INTERVAL	- - - - -	=====
PROPERTY LINE	=====	=====
ROADWAY CENTERLINE	=====	=====
RIGHT OF WAY LIMITS	=====	=====
EASEMENT LINE	=====	=====
CURB & GUTTER	=====	=====
SANITARY SEWER FACILITIES	-----○-----	-----●-----
STORM SEWER FACILITIES	----- -----	-----PSD-----
WATERLINE	-----X-----	-----X-----
FIRE HYDRANT ASSEMBLY	○---X---○	○---X---○
FENCING STRUCTURE	○-----○	○-----○
WOODSLINE	-----	N/A
WATERWAYS	-----	N/A
SILT FENCING	N/A	///

INDEX OF SHEETS

OVERALL SITE PLAN	SHT 1
DETAILED SITE PLAN	SHT 2
DETAILED SITE PLAN	SHT 3
WATER, SEWER, STORM, & EROSION CONTROL PLAN	SHT 4
WATER, SEWER, STORM, & EROSION CONTROL PLAN	SHT 5
LANDSCAPE PLAN	SHT 6
LANDSCAPE PLAN	SHT 7
SR 1435 WIDENING PLAN	SHT 8
SR 1435 WIDENING PLAN	SHT 9
LIGHTING PLAN	SHT 10
UTILITY PROFILES	SHT 11
UTILITY PROFILES	SHT 12
DETAILS	SHT 13
DETAILS	SHT 14
DETAILS	SHT 15

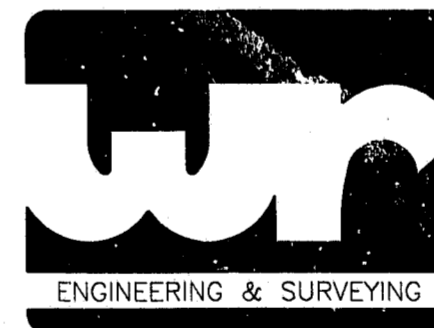

WITHERS & RAVENEL
Engineering & Surveying, Inc.

1149 Executive Circle
Cary, N.C. 27511

PHONE : 919-469-3340
FAX : 919-467-6008



**JERRY TURNER
& ASSOCIATES**

LANDSCAPE ARCHITECTURE
LAND PLANNING
ENVIRONMENTAL DESIGN

905 JONES FRANKLIN ROAD
RALEIGH, NORTH CAROLINA 27606
(919) 851-7150

62 S.E. 6TH AVENUE
DELRAY BEACH, FLORIDA 33483
(407) 276-0453

APPROVED

DATE: 12-5-94

BY: JH Tucker

TOWN OF CARY
ENGINEERING DEPARTMENT

CP 238-94
APPROVED
10-17-94
10-27-94
ecb
OFFICIAL SEPA/NEPA PLAN