

# ASBUILT DRAWINGS FOR MR-3 AND MR-4 SANITARY SEWER EXTENSION

CARY PARK P.U.D.  
CARY, N.C.

CARY PROJECT # 03-SP-051

**PROFESSIONAL ENGINEER'S  
CERTIFICATION**

PROJECT NAME: Cary Park P.U.D. MR-3 and MR-4 Sewer Extension  
PERMIT NO.: 100010 DATE ISSUED: 08/2010

I, James E. Cavalli, P.E., as a duly registered Professional Engineer in the State of North Carolina, having been authorized to observe and certify the work of the contractor of the project, Cary Park P.U.D. MR-3 and MR-4 Sewer Extension, Cary Park P.U.D., for the location:

Permittee hereby warrants, to the best of my abilities, the care and diligence used in the preparation of the drawings and that the construction was observed to be in full compliance with the approved plans and specifications, and other supporting documents.

*[Signature]*  
P.E. REGISTRATION NO. 18729

WORK PROJECT NO. 0322110



INDEX OF SHEETS	
PLAN & PROFILE	SHT 1
DETAILS	SHT 2

**DEVELOPER**

EAST WEST PARTNERS MANAGEMENT COMPANY  
190 FINLEY GOLF COURSE ROAD  
CHAPEL HILL, N.C. 27716  
(919) 929-0660  
FAX (919) 967-0959

**OWNER**

PANTHER CREEK - RALEIGH LIMITED PARTNERSHIP, LLC  
C/O EAST WEST PARTNERS MANAGEMENT COMPANY  
190 FINLEY GOLF COURSE ROAD  
CHAPEL HILL, N.C. 27716  
(919) 929-0660  
FAX (919) 967-0959

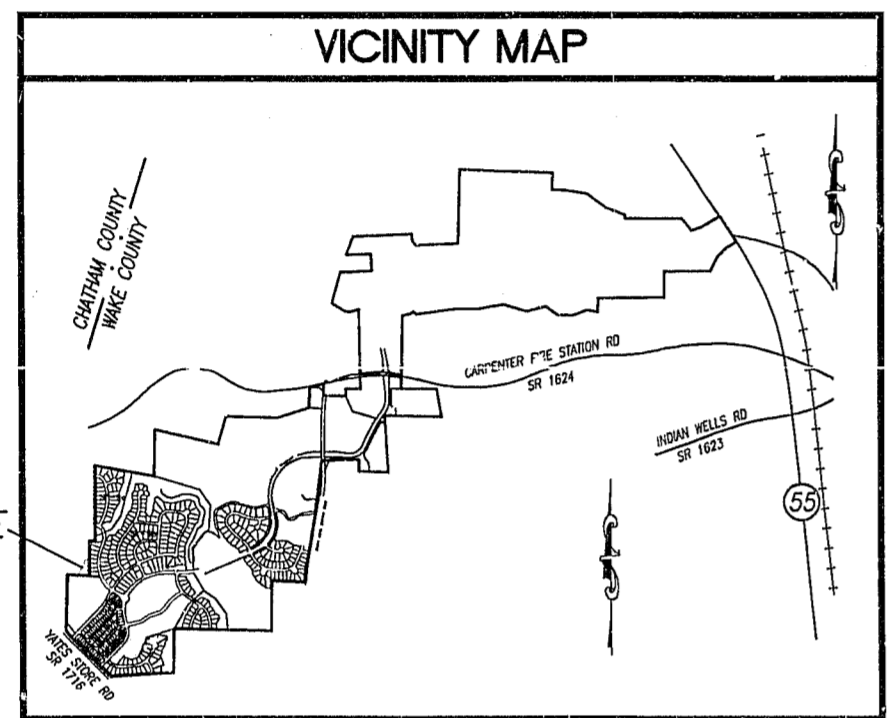

DESCRIPTION	EXISTING	PROPOSED
2' CONTOUR INTERVAL	-----	-----
10' CONTOUR INTERVAL	-----	-----
PROPERTY LINE	-----	-----
ROADWAY CENTERLINE	-----	-----
RIGHT OF WAY LIMITS	-----	-----
EASEMENT LINE	-----	-----
CURB & GUTTER	=====	=====
SANITARY SEWER FACILITIES	-----	-----
STORM SEWER FACILITIES	-----	-----
WATERLINE	-----	-----
FIRE HYDRANT ASSEMBLY	-----	-----
FENCING STRUCTURE	-----	-----
WOODSLINE	-----	N/A
WATERWAYS	-----	N/A
SILT FENCING	N/A	-----

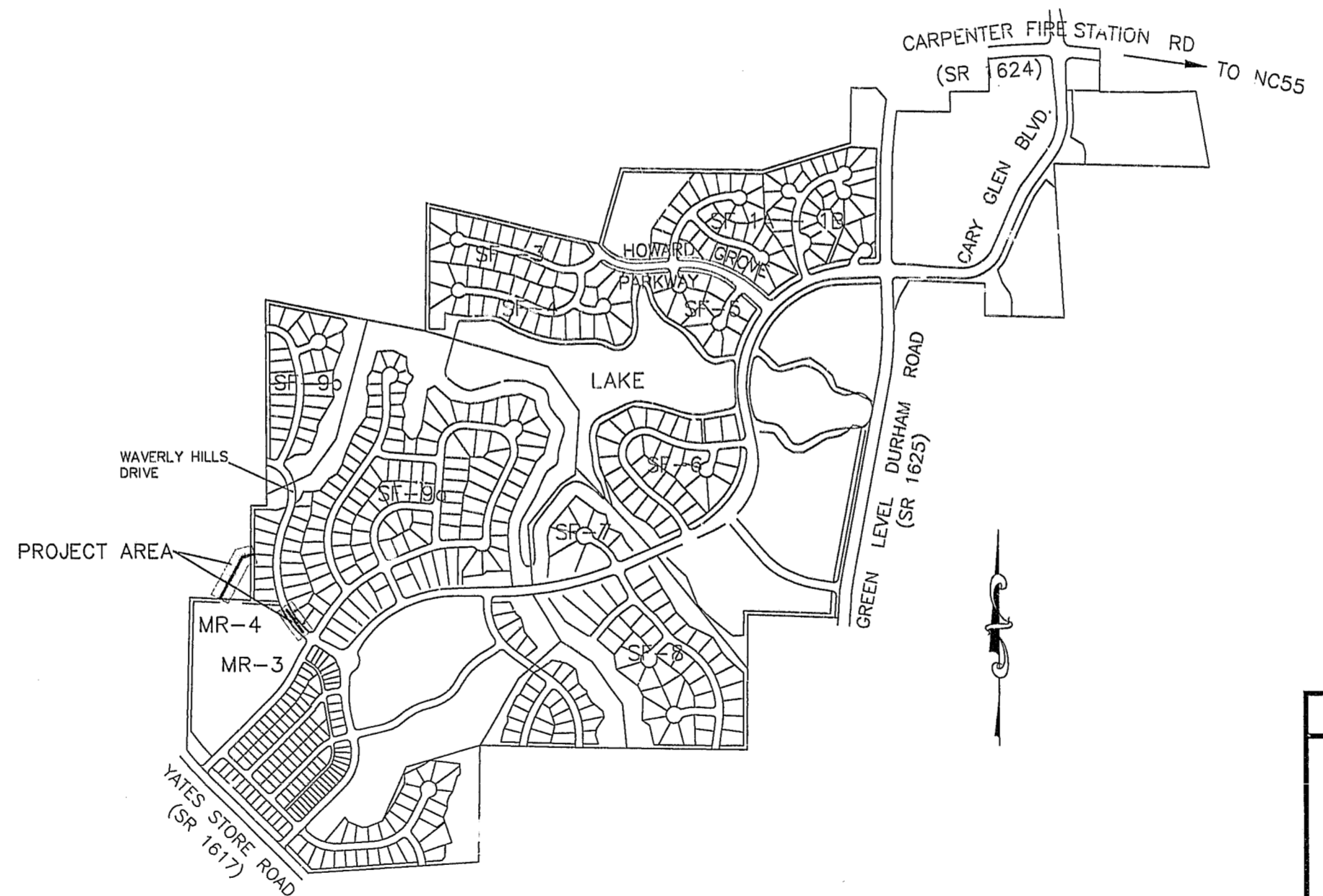

**PREPARED BY:**

**WITHERS & RAVENEL**  
ENGINEERS | PLANNERS | SURVEYORS  
111 MacKenan Drive Cary, North Carolina 27511 tel: 919-469-3340 fax: 919-467-6008 www.withersravenel.com

**APPROVED**  
TOWN OF CARY

Approved by: \_\_\_\_\_ Date: \_\_\_\_\_  
Planning: \_\_\_\_\_ Date: \_\_\_\_\_  
Engineering: \_\_\_\_\_ Date: \_\_\_\_\_