

AS-BUILT PLANS FOR CARY PARK PARCEL SF-11c - PHASE I CARY PARK P.U.D.

(FORMERLY KNOWN AS CARY GLEN P.U.D.)
CARY, N.C.

CARY PROJECT # 01-SB-007

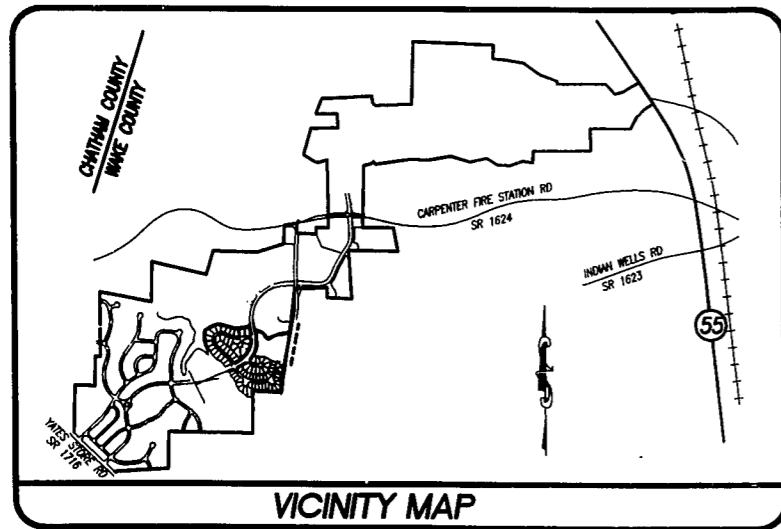

VICINITY MAP

INDEX OF SHEETS	
SUBDIVISION PLAN	SHT 1
UTILITY PLAN	SHT 2
STORM DRAINAGE, EROSION CONTROL, AND GRADING PLAN	SHT 3
ROO1 AND ROO2 PLAN & PROFILE	SHT 4
ROO3 AND ROO4 PLAN & PROFILE	SHT 5
A001 AND A002 PLAN & PROFILE	SHT 6
A003 PLAN & PROFILE, SANITARY SEWER OUTFALLS A & B PLAN & PROFILE	SHT 7
UTILITY DETAILS	SHT 8
EROSION CONTROL & STORM DRAINAGE DETAILS	SHT 9
ROADWAY DETAILS	SHT 10

LEGEND		
DESCRIPTION	EXISTING	PROPOSED
2' CONTOUR INTERVAL	_____	_____
10' CONTOUR INTERVAL	_____	_____
PROPERTY LINE	_____	_____
ROADWAY CENTERLINE	_____	_____
RIGHT OF WAY LIMITS	_____	_____
EASEMENT LINE	_____	_____
CURB & GUTTER	_____	_____
SANITARY SEWER FACILITIES	_____	_____
STORM SEWER FACILITIES	_____	_____
WATERLINE	_____	_____
FIRE HYDRANT ASSEMBLY	_____	_____
FENCING STRUCTURE	_____	_____
WOODSLINE	_____	_____
WATERWAYS	_____	_____
SILT FENCING	_____	_____

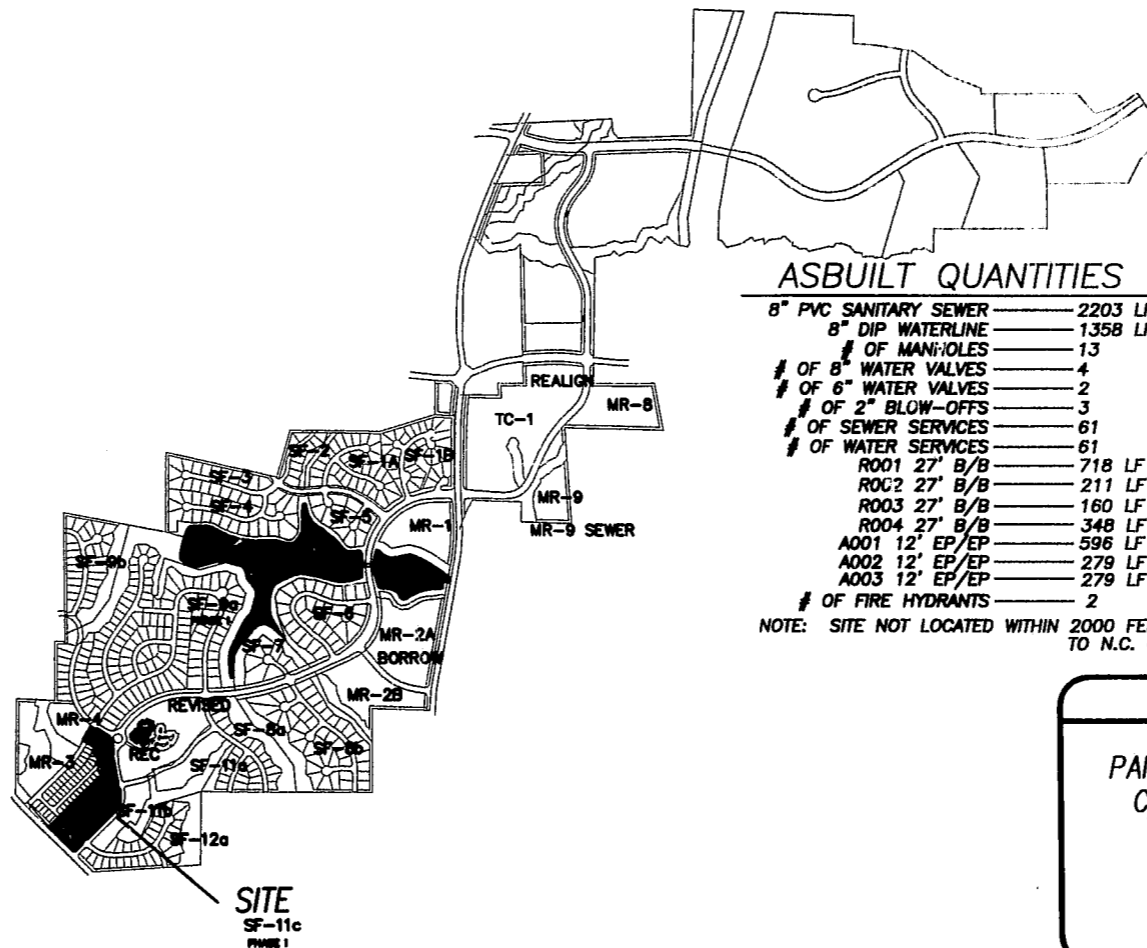

ASBUILT QUANTITIES	
8" PVC SANITARY SEWER	2203 LF
8" DIP WATERLINE	1358 LF
# OF MANHOLES	13
# OF 8" WATER VALVES	4
# OF 6" WATER VALVES	2
# OF 2" BLOW-OFFS	3
# OF SEWER SERVICES	61
# OF WATER SERVICES	61
ROO1 27" B/B	718 LF
ROO2 27" B/B	211 LF
ROO3 27" B/B	160 LF
ROO4 27" B/B	348 LF
A001 12" EP/EP	596 LF
A002 12" EP/EP	279 LF
A003 12" EP/EP	279 LF
# OF FIRE HYDRANTS	2

NOTE: SITE NOT LOCATED WITHIN 2000 FEET OF BENCHMARK TO TIE TO N.C. GRID COORDINATE SYSTEM.

OWNER
PANTHER CREEK - RALEIGH LIMITED PARTNERSHIP, LLC
C/O EAST WEST PARTNERS MANAGEMENT COMPANY
190 FINLEY GOLF COURSE ROAD
CHAPEL HILL, N.C. 27716
(919) 929-0660
FAX (919) 967-0959

PREPARED BY:



**WITHERS & RAVENEL
ENGINEERING & SURVEYING, INC.**

111 MacKENAN DRIVE
CARY, NORTH CAROLINA 27511
TELEPHONE: OFFICE (919) 469-3340
FAX No. (919) 467-6008



JERRY TURNER & ASSOCIATES, INC.

Landscape Architecture
Land Planning
Environmental Design

905 Jones Franklin Road
Raleigh, North Carolina 27606
(919) 851-7150 fax. (919) 851-7547

277 S.E. 5th Avenue
Delray Beach, Florida 33483
(561) 278-0453 fax. (561) 272-7593

DEVELOPER

EAST WEST PARTNERS MANAGEMENT COMPANY
190 FINLEY GOLF COURSE ROAD
CHAPEL HILL, N.C. 27716
(919) 929-0660
FAX (919) 967-0959