

SITE IMPROVEMENTS FOR CARY PARK PARCEL SF-11b

CARY PARK P.U.D.
CARY, N.C.

CARY PROJECT # 04-SB-002

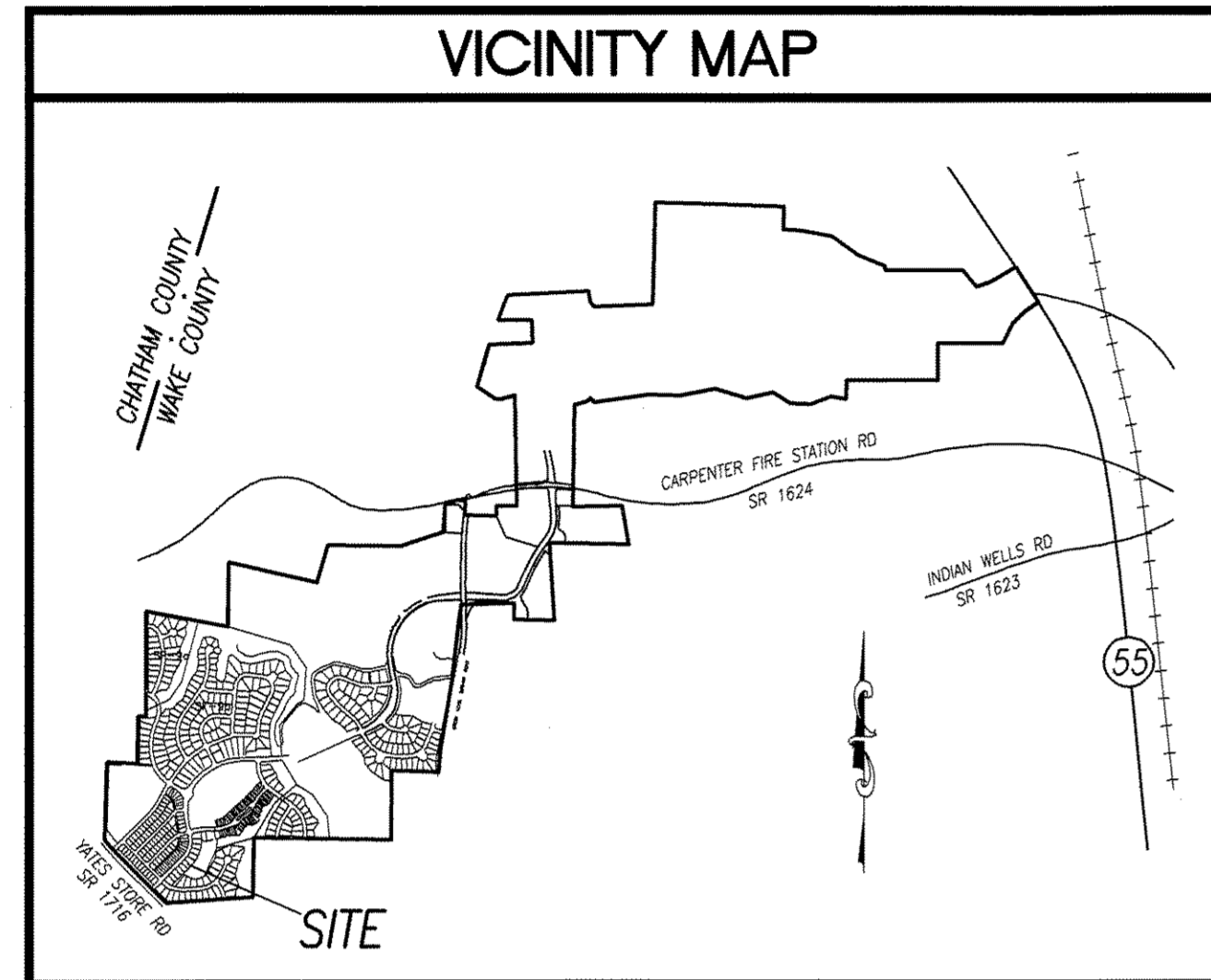

LEGEND

DESCRIPTION	EXISTING	PROPOSED
2' CONTOUR INTERVAL	-----	-----
10' CONTOUR INTERVAL	-----	-----
PROPERTY LINE	=====	=====
ROADWAY CENTERLINE	-----	-----
RIGHT OF WAY LIMITS	-----	-----
EASEMENT LINE	-----	-----
CURB & GUTTER	=====	=====
SANITARY SEWER FACILITIES	-----	-----
STORM SEWER FACILITIES	-----	-----
WATERLINE	-----	-----
FIRE HYDRANT ASSEMBLY	-----	-----
FENCING STRUCTURE	-----	-----
WOODSLINE	-----	N/A
WATERWAYS	-----	N/A
SILT FENCING	N/A	-----

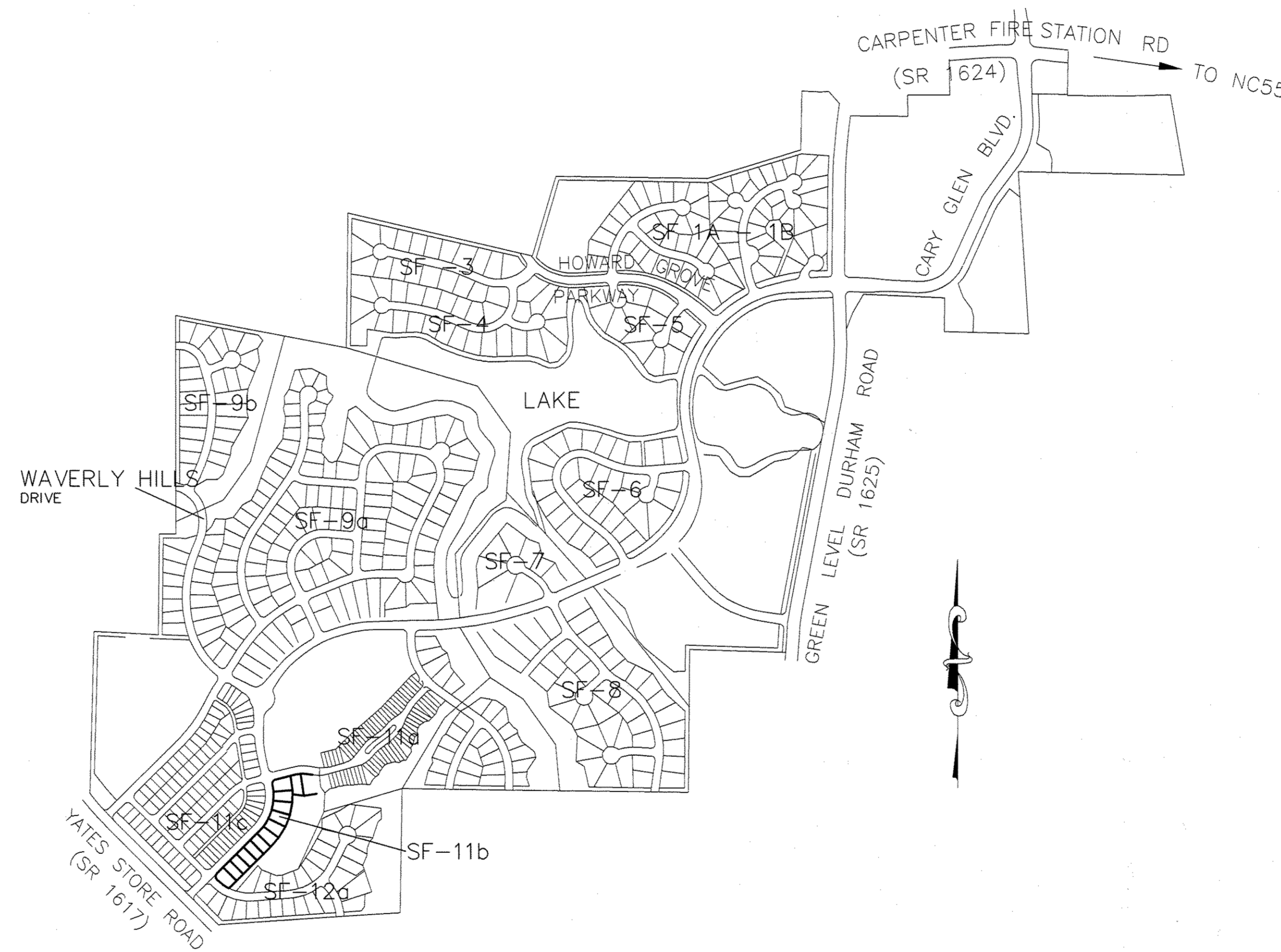

INDEX OF SHEETS

SITE PLAN	SHT 1
WATER, SANITARY SEWER, STORM DRAINAGE AND EROSION CONTROL PLAN	SHT 2
SANITARY SEWER PROFILES	SHT 3
DETAILS	SHT 4
LANDSCAPE PLAN AND DETAILS	SHT 5

DEVELOPER

EAST WEST PARTNERS MANAGEMENT COMPANY
190 FINLEY GOLF COURSE ROAD
CHAPEL HILL, N.C. 27716
(919) 929-0660
FAX (919) 967-0959

TOWN OF CARY 1ST REVIEW, DATED: 01/15/04

PREPARED BY:

WITHERS & RAVENEL
ENGINEERS | PLANNERS | SURVEYORS
111 MacKenan Drive Cary, North Carolina 27511 tel: 919-469-3340 fax: 919-467-6008 www.withersravenel.com

OWNER

PANTHER CREEK - RALEIGH LIMITED PARTNERSHIP, LLC
C/O EAST WEST PARTNERS MANAGEMENT COMPANY
190 FINLEY GOLF COURSE ROAD
CHAPEL HILL, N.C. 27716
(919) 929-0660
FAX (919) 967-0959

04-SB-002
APPROVED
TOWN OF CARY

Approved by: DRC Date: 2/11/04
Planning: RS Date: 9/20/04
Engineering: TS Date: 4/21/04