

# CONSTRUCTION PLANS FOR RESIDENTIAL DEVELOPMENT PARCEL TC-3 AT CARY PARK PUD CARY, NORTH CAROLINA FEBRUARY 2006

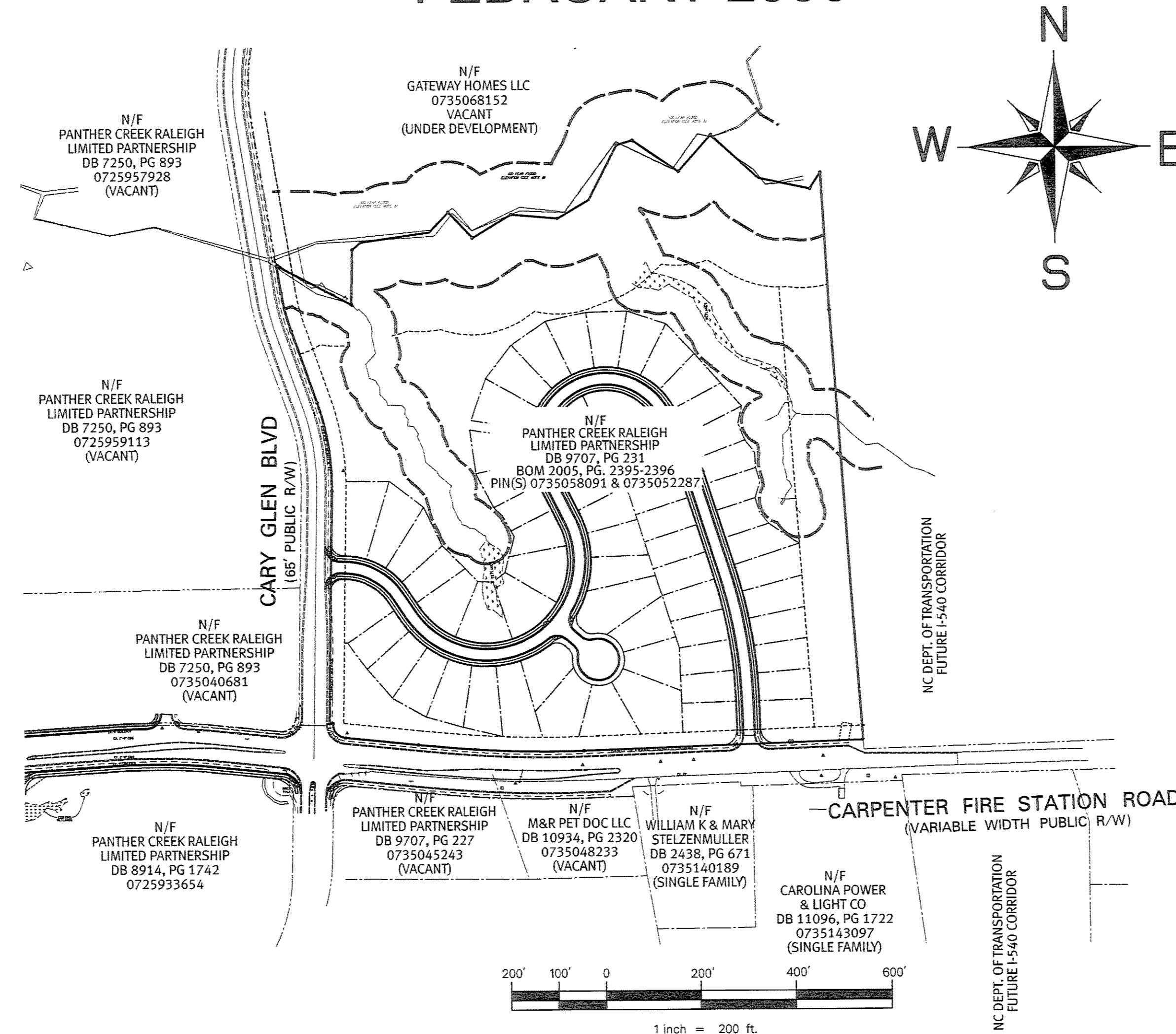
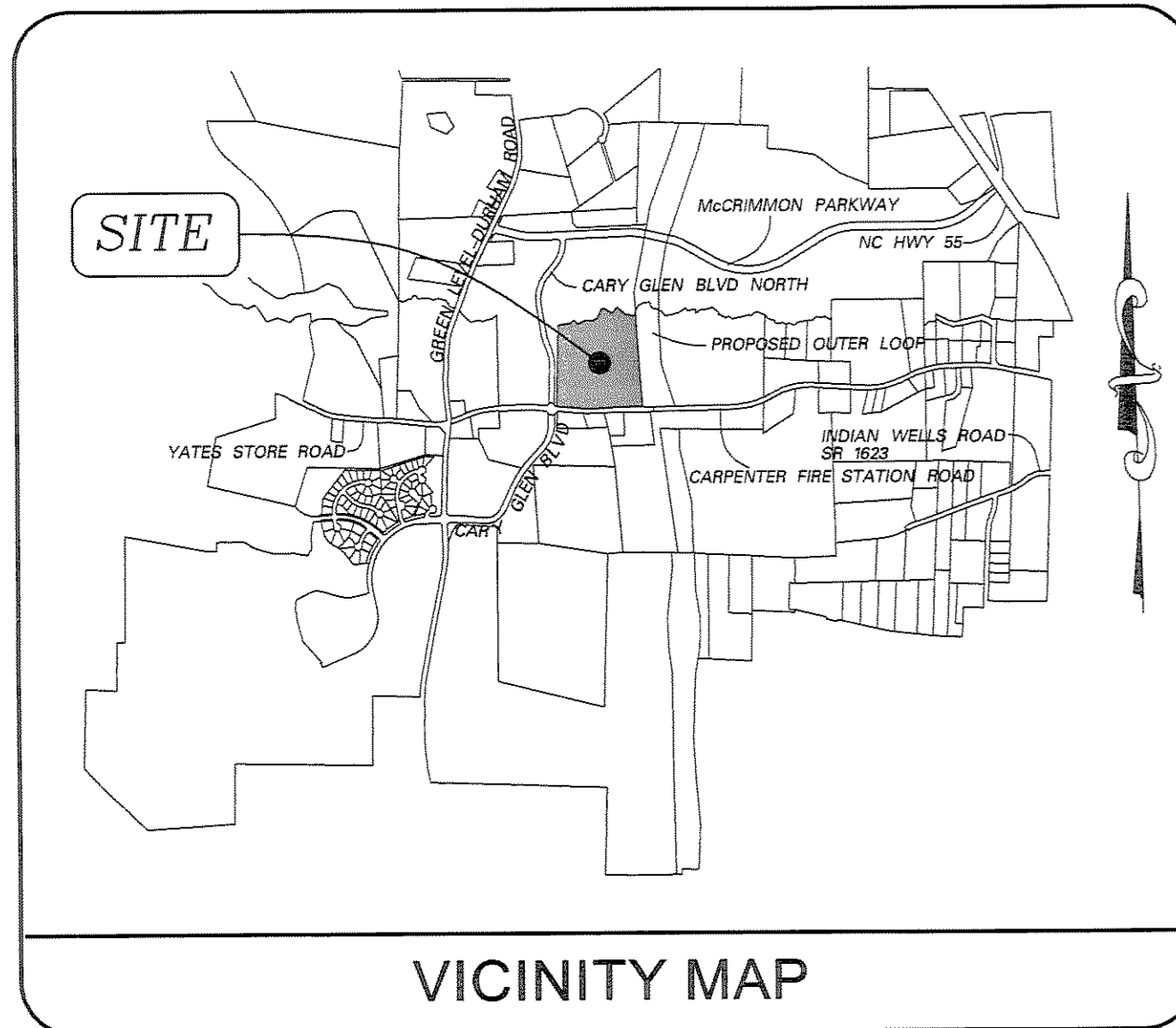

INDEX OF SHEETS	
DESCRIPTION	SHEET NO.
SITE PLAN	1
UTILITY PLAN	2
GRADING, STORM DRAINAGE & EROSION CONTROL PLAN	3
PLAN & PROFILE - ROADWAY	4-5
PLAN & PROFILE - SANITARY SEWER OUTFALLS	6
STORMWATER MANAGEMENT PLAN	7
UTILITY DETAILS	8
EROSION CONTROL AND STORM DRAINAGE DETAILS	9
ROADWAY DETAILS	10
LANDSCAPE PLAN	L1
PLANT LIST & DETAILS	L1.1

PUBLIC IMPROVEMENT QUANTITIES	
PUBLIC STREETS.....	2,446 LF
PUBLIC 5' SIDEWALK.....	3,380 LF
PUBLIC 6" DIP WATER MAIN.....	173 LF
PUBLIC 8" DIP WATER MAIN.....	2,060 LF
PUBLIC 8" SANITARY SEWER.....	2,768 LF

DESCRIPTION	EXISTING	PROPOSED
2' CONTOUR INTERVAL	.....	.....
10' CONTOUR INTERVAL	.....	.....
PROPERTY LINE	.....	.....
ROADWAY CENTERLINE	.....	.....
RIGHT OF WAY LIMITS	.....	.....
EASEMENT LINE	.....	.....
CURB & GUTTER	.....	.....
SANITARY SEWER FACILITIES	8" PVC	8" PVC SS
STORM SEWER FACILITIES	8" WL	8" DIP WL
WATERLINE	.....	.....
FIRE HYDRANT ASSEMBLY	.....	.....
WOODSLINE	.....	N/A
WATERWAYS	.....	N/A
SILT FENCING	N/A	.....
TREE PROTECTION FENCING	N/A	.....

**OWNER**

PANTHER CREEK - RALEIGH LIMITED PARTNERSHIP, LLC  
C/O EAST WEST PARTNERS MANAGEMENT COMPANY  
190 FINLEY GOLF COURSE ROAD  
CHAPEL HILL, N.C. 27716  
PHONE (919) 929-0660  
FAX (919) 967-0959

**DEVELOPER**

EAST WEST PARTNERS MANAGEMENT COMPANY  
190 FINLEY GOLF COURSE ROAD  
CHAPEL HILL, N.C. 27716  
PHONE (919) 929-0660  
FAX (919) 967-0959

Cary Project Number 05-SB-035  
APPROVED  
TOWN OF CARY

Approved by *DRC* Date 4/14/06  
Planning *AS* Date 4-25-06  
Engineering *TS* Date 4-27-06

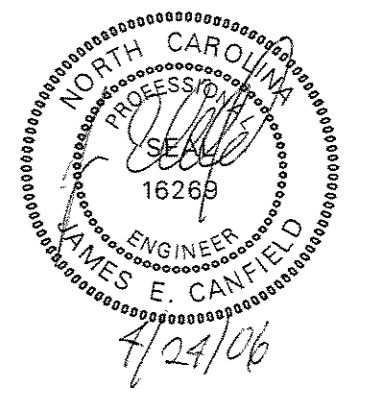

Prepared by:  
**WITHERS & RAVENEL**  
ENGINEERS | PLANNERS | SURVEYORS  
111 MacKenan Drive Cary, North Carolina 27511  
tel: 919-469-3340 fax: 919-467-6008 www.withersravenel.com