

PROJECTED WATER AND SANITARY SEWER FLOW

PLUMBING FIXTURE TOTALS:	PHASE I	PHASE II	TOTAL
WATER CLOSETS	2	2	4
LAVATORIES	2	2	4
SINKS	6	1	7
WATER FOUNTAINS	1	1	2
SHOWERS/TUBS	2	0	2
WASHING MACHINES	1	0	1
FLOOR DRAINS	4	0	4
HOSE BIBBS	4	0	4
TOTAL WASTE FIXTURE UNITS	42	16	58
SIZE LINE	4"	3"	4"
TOTAL WATER FIXTURE UNITS	46	18	64
GPH	29	13	35
SIZE LINE	1 1/4"	1"	1 1/4"
TOTAL HOT WATER FIXTURE UNITS	22.5	4.5	27
GPH	17	5	20
SIZE LINE	1"	3/4"	1"
TOTAL HOT WATER GPH	194	14	208

PLUMBING SYSTEM, FLUSH TANK

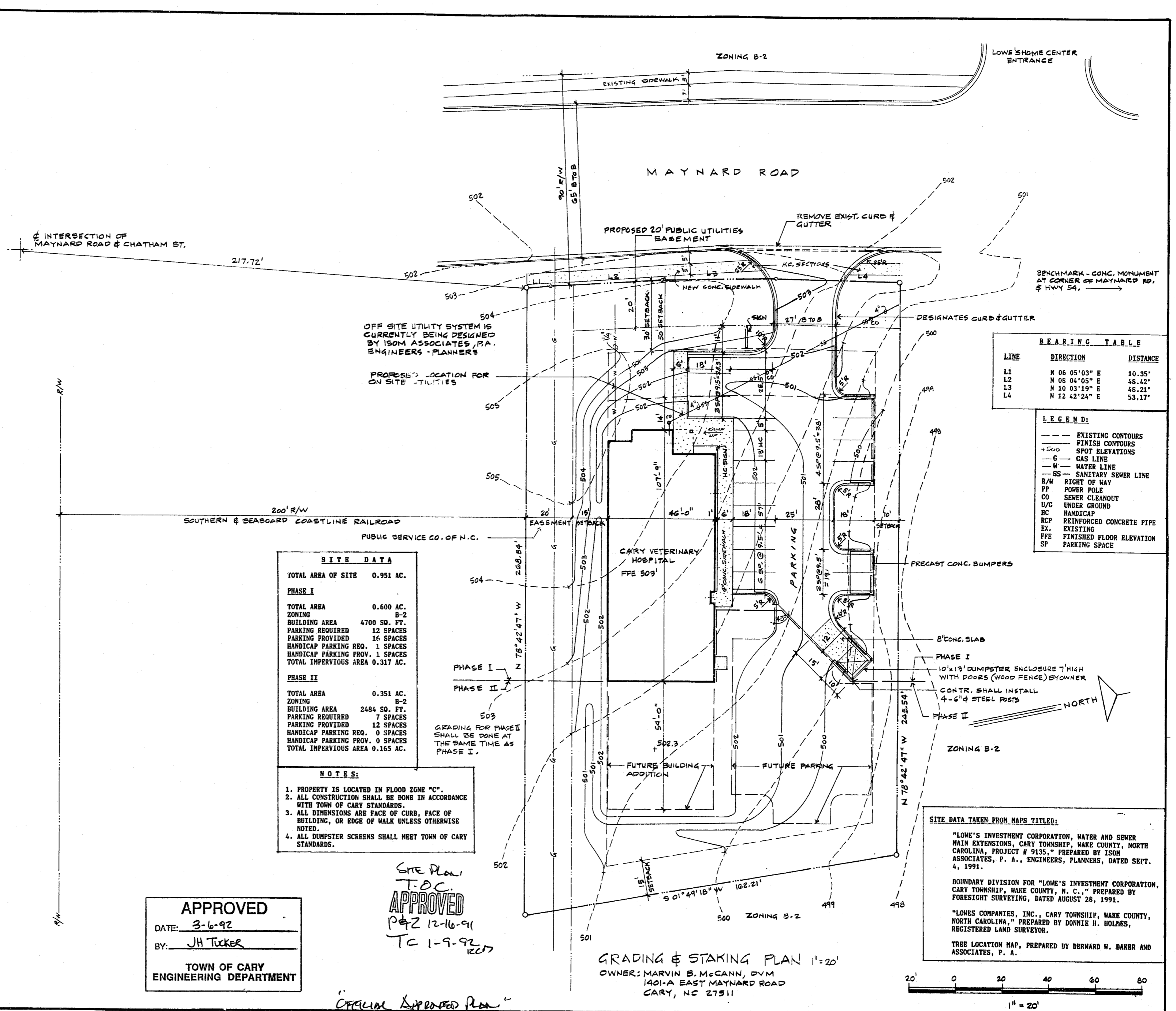

SITE DATA

TOTAL AREA OF SITE 0.951 AC.

PHASE I

TOTAL AREA 0.600 AC.
 ZONING B-2
 BUILDING AREA 4700 SQ. FT.
 PARKING REQUIRED 12 SPACES
 PARKING PROVIDED 16 SPACES
 HANDICAP PARKING REQ. 1 SPACES
 TOTAL IMPERVIOUS AREA 0.317 AC.

PHASE II

TOTAL AREA 0.351 AC.
 ZONING B-2
 BUILDING AREA 2484 SQ. FT.
 PARKING REQUIRED 7 SPACES
 PARKING PROVIDED 12 SPACES
 HANDICAP PARKING REQ. 0 SPACES
 TOTAL IMPERVIOUS AREA 0.165 AC.

- NOTES:**
- PROPERTY IS LOCATED IN FLOOD ZONE "C".
 - ALL CONSTRUCTION SHALL BE DONE IN ACCORDANCE WITH TOWN OF CARY STANDARDS.
 - ALL DIMENSIONS ARE FACE OF CURB, FACE OF BUILDING, OR EDGE OF WALK UNLESS OTHERWISE NOTED.
 - ALL DUMPSTER SCREENS SHALL MEET TOWN OF CARY STANDARDS.

APPROVED
 DATE: 3-6-92
 BY: JH Tucker
 TOWN OF CARY
 ENGINEERING DEPARTMENT

SITE Plan
 T.B.C.
APPROVED
 P&Z 12-16-91
 TC 1-9-92

GRADING & STAKING PLAN 1"=20'
 OWNER: MARVIN B. McCANN, DVM
 1401-A EAST MAYNARD ROAD
 CARY, NC 27511

BEARING TABLE

LINE	DIRECTION	DISTANCE
L1	N 06°05'03" E	10.35'
L2	N 08°04'05" E	48.42'
L3	N 10°03'21" E	48.21'
L4	N 12°42'24" E	53.17'

- LEGEND:**
- EXISTING CONTOURS
 - FINISH CONTOURS
 - +500 SPOT ELEVATIONS
 - G GAS LINE
 - W WATER LINE
 - SS SANITARY SEWER LINE
 - R/W RIGHT OF WAY
 - PP POWER POLE
 - CO SEWER CLEANOUT
 - U/G UNDER GROUND
 - RC HANDICAP
 - RCP REINFORCED CONCRETE PIPE
 - EX. EXISTING
 - FFE FINISHED FLOOR ELEVATION
 - SP PARKING SPACE

SITE DATA TAKEN FROM MAPS TITLED:

"LOWE'S INVESTMENT CORPORATION, WATER AND SEWER MAIN EXTENSIONS, CARY TOWNSHIP, WAKE COUNTY, NORTH CAROLINA, PROJECT # 9135," PREPARED BY ISOM ASSOCIATES, P. A., ENGINEERS, PLANNERS, DATED SEPT. 4, 1991.

BOUNDARY DIVISION FOR "LOWE'S INVESTMENT CORPORATION, CARY TOWNSHIP, WAKE COUNTY, N. C.," PREPARED BY FORESIGHT SURVEYING, DATED AUGUST 28, 1991.

"LOWES COMPANIES, INC., CARY TOWNSHIP, WAKE COUNTY, NORTH CAROLINA," PREPARED BY DONNIE H. HOLMES, REGISTERED LAND SURVEYOR.

TREE LOCATION MAP, PREPARED BY DERWARD W. BAKER AND ASSOCIATES, P. A.

FLY THE CONSTRUCTION CO.
 GENERAL CONTRACTOR
 RALEIGH, NORTH CAROLINA

CARY VETERINARY HOSPITAL
 NORTHEAST MAYNARD ROAD
 CARY, N. C.

DATE: 29 OCT 1991
 20 NOV 1991
 15 JAN 1992
 24 FEB 1992

TRUMAN L. NEWBERRY JR.
 ARCHITECT
 5013 WILEY O'NEAL ROAD RALEIGH, N.C. 27606

SHEET NO: **S-1**