

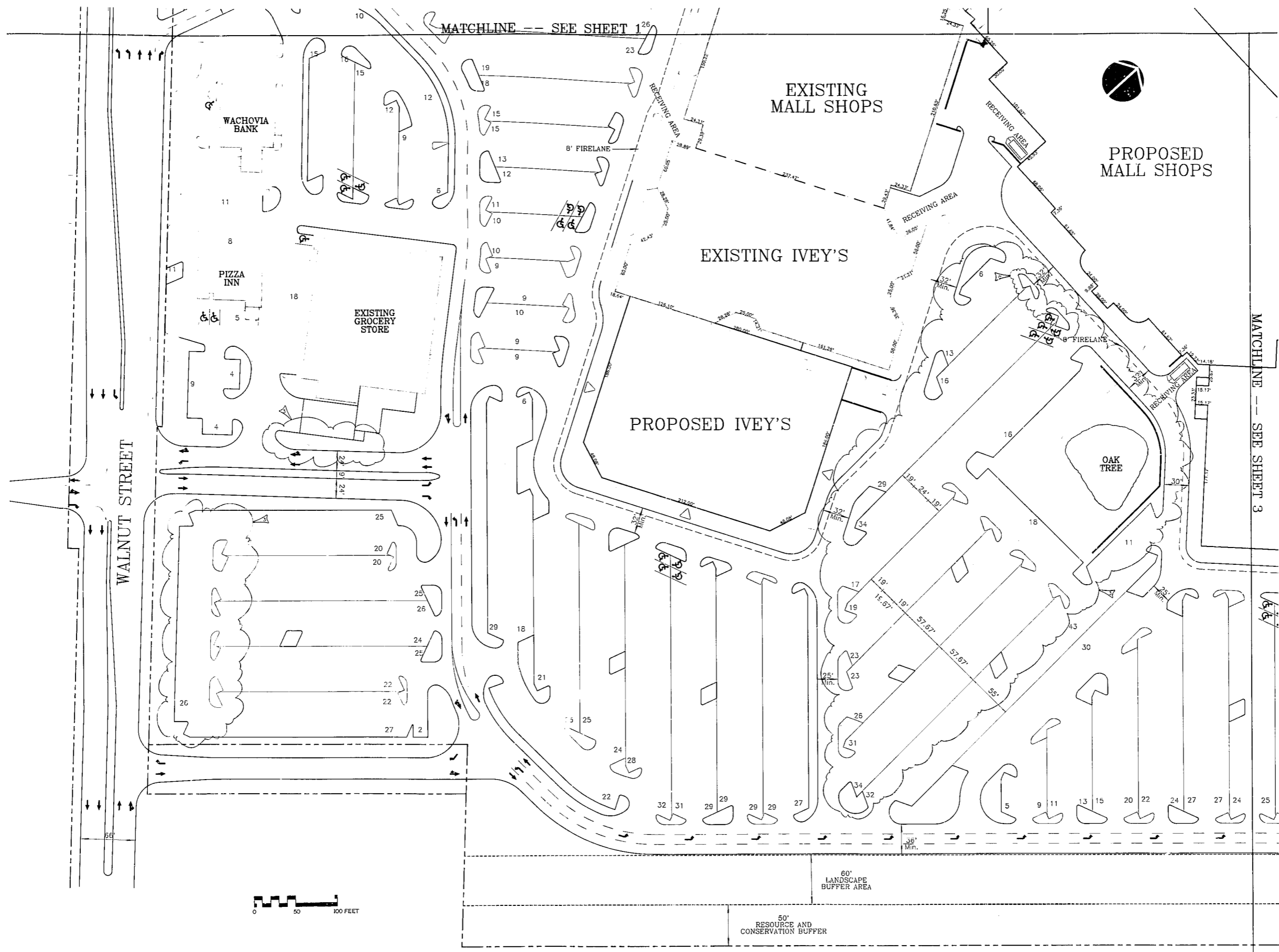

- Revisions
 2) MARCH 19, 1990- T.O.C. FIRST REVIEW
 3) APRIL 9, 1990- REVISED PARKING LOT AT OAK TREE AND WALNUT STREET, REDUCED RETAINING WALL AT OAK TREE
 5) REVISED ISLANDS AT PROPOSED MALL SHOPS ENTRANCE.



NOT ISSUED FOR CONSTRUCTION

Project
CARY VILLAGE MALL
SITE PLAN

Date
MARCH 16, 1990

Scale
 1" = 50'

Sheet
S2