

**THRUST RESTRAINT CALCULATIONS**

- NOTES:  
 1. LENGTHS FOR THRUST INCLUDE 5' DEISTANCE BETWEEN VALVE AND TEE  
 2. LENGTHS FOR BENDS ARE TYPICAL FOR EACH SIDE

NODE	DESCRIPTION	JOINT LENGTH
1	DEAD END	34'
2	THRUST (TEE)	28'
3	DEAD END	34'
4	22.5 BEND	8'
5	22.5 BEND	8'
6	VALVE	34'
7	11.25 BEND	4'
8	11.25 BEND	4'
9	11.25 BEND	4'
10	22.5 BEND	8'
11	22.5 BEND	8'
12	VALVE	34'
13	*THRUST (TEE)	28'

\* SINCE 8" DI WATERLINE IS IN STEEL ENCASEMENT PIPE, NO RESTRAINT IS NECESSARY

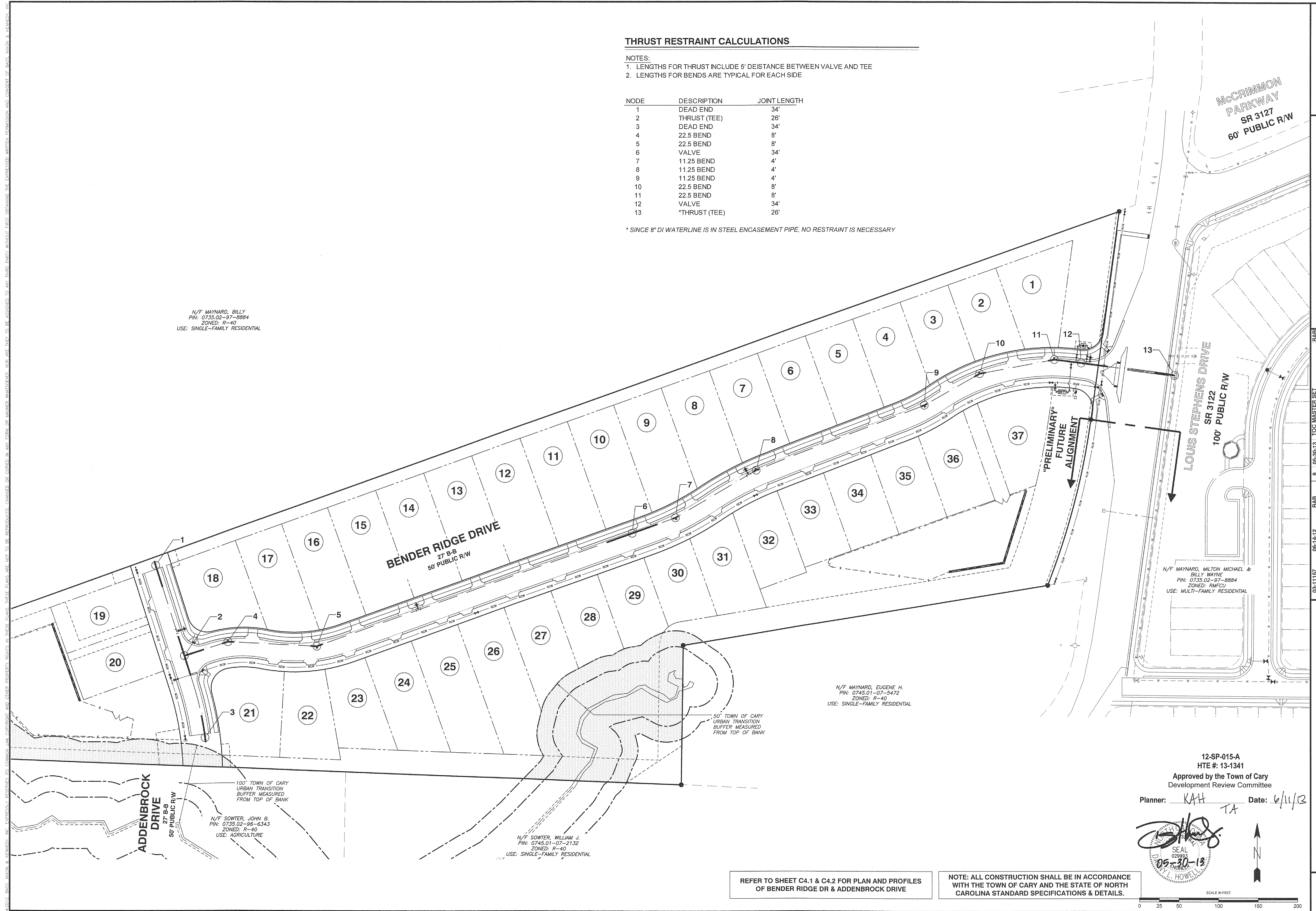

P:\2011-03\08\11152008 - 4\plans\08\Construction\Reference\Draw\11152008\_02.2. 3/26/2013 12:03:39 PM  
 BASS, NIXON & KENNEDY, INC. ENGINEERS, ARCHITECTS, RESERVES ITS COMMON LAW COPYRIGHT AND OTHER PROPERTY RIGHTS IN THESE PLANS. THESE PLANS ARE NOT TO BE REPRODUCED, CHANGED OR COPIED IN ANY MANNER WHATSOEVER, NOR ARE THEY TO BE ASSIGNED TO ANY THIRD PARTY WITHOUT FIRST OBTAINING THE EXPRESSED WRITTEN PERMISSION AND CONSENT OF BASS, NIXON & KENNEDY, INC.

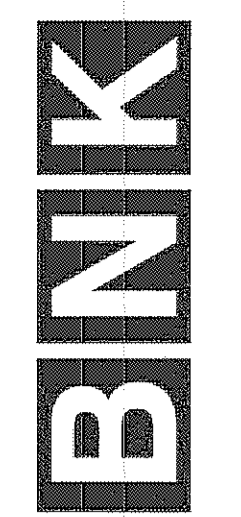

**BASS, NIXON & KENNEDY, INC.**  
**CONSULTING ENGINEERS**  
 6310 CHAPEL HILL ROAD, SUITE 250, RALEIGH, NC 27607  
 TELEPHONE: (919)851-4422 OR (800)354-1879 FAX: (919)851-8968  
 CERTIFICATION NUMBERS: NCBELS (C-0110); NCBLA (C-0267)

NO.	DATE	DESCRIPTION	BY
8	05-30-13	TOC MASTER SET	RAB
7	05-08-13	TOC MASTER SET - KB REVISION	RAB
6	01-28-13	TOC MASTER SET - REVISION	DLH
5	01-24-13	TOC MASTER SET	RAB
4	12-13-12	PER TOC COMMENTS	RAB

**THRUST RESTRAINT PLAN**

03-11157 JOB NO. DATE: 06-14-12 DRAWN BY: RAB

12-SP-015-A HTE #: 13-1341  
 Approved by the Town of Cary Development Review Committee  
 Planner: KAH Date: 6/11/13  
 TA

**SEAL**  
 029993  
 05-30-13  
 HOWELL

SCALE: 1" = 50'

**CEDAR BEND**  
**4925 LOUIS STEPHENS DRIVE**  
 TOWN OF CARY, WAKE COUNTY, NORTH CAROLINA

SHEET **C2.2**  
 9 OF 28

REFER TO SHEET C4.1 & C4.2 FOR PLAN AND PROFILES OF BENDER RIDGE DR & ADDENBROCK DRIVE

NOTE: ALL CONSTRUCTION SHALL BE IN ACCORDANCE WITH THE TOWN OF CARY AND THE STATE OF NORTH CAROLINA STANDARD SPECIFICATIONS & DETAILS.

TOWN OF CARY PROJECT NO. 12-SP-015-A