

TOWN LIMITS IS BOUNDARY OF THE FLOOD POOL OF LAKE CRABTREE.

PLANT LIST

Botanical Name	Common Name	Caliper	Height	Root	Remarks	Quant	Symbols
ACER RUBRUM	RED MAPLE	2 1/2"	6-8'			5	AR
BETULA NIGRA	RIVER BIRCH	2 1/2"	6-8'			3	BN
PLATANUS OCCIDENTALIS	SYCAMORE	2 1/2"	6-8'			10	PO
SHRUBS							
MYRICA CERIFERA	WAX MYRTLE	3 GAL				16	MC

NOTE:
PHASE II SITE BOUNDARIES DO NOT REQUIRE LANDSCAPE BUFFERS BECAUSE OF VACANT ADJACENT LAND OR IS CONTIGUOUS WITH EXISTING SITE, WITH THE EXCEPTION OF THE NW SECTION.

LANDSCAPE BUFFER "TYPE B"

THE BUFFER AREA'S EXISTING VEGETATION AND WIDTH EXCEEDS THE REQUIREMENT FOR A TYPE B SEMI OPAQUE BUFFER.

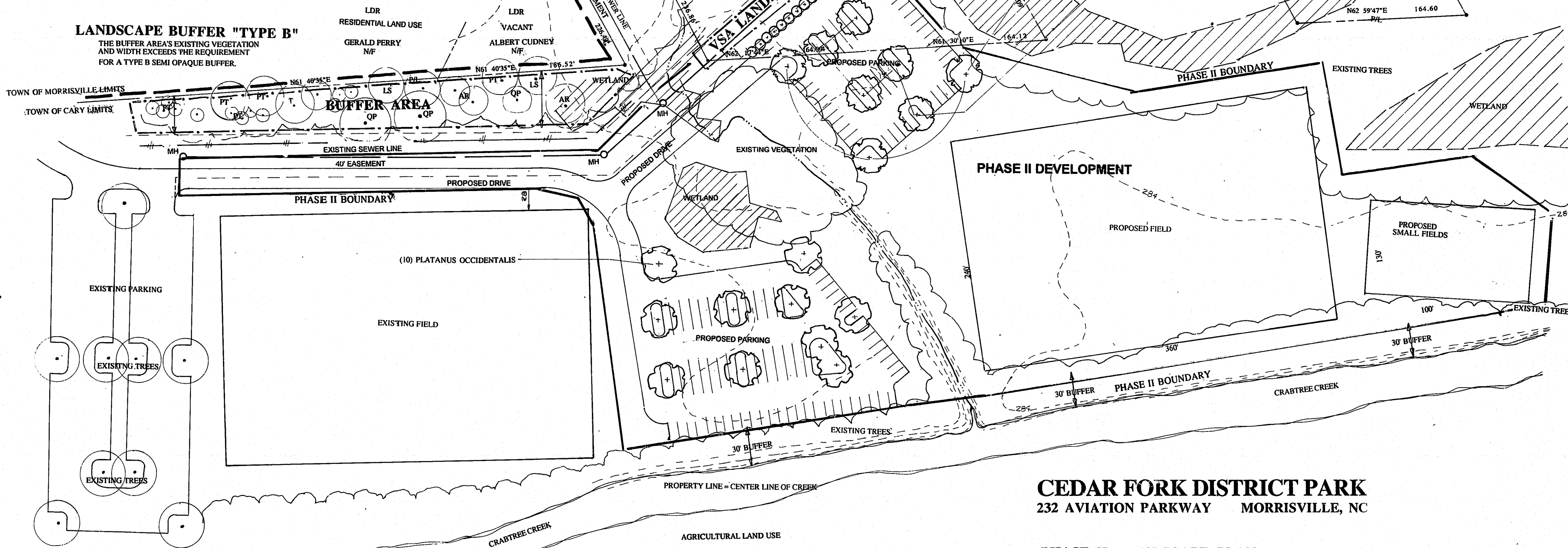

CEDAR FORK DISTRICT PARK
232 AVIATION PARKWAY MORRISVILLE, NC

PHASE II LANDSCAPE PLAN

OWNER:
WAKE COUNTY PARKS AND RECREATION
P.O. BOX 550
RALEIGH, N.C. 27601
LEASEE:
CAPITAL AREA SOCCER LEAGUE
3344 HILLSBOROUGH STREET
RALEIGH, N.C. 27207

NORTH

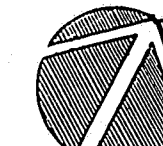

SCALE 1" = 50'



FOR CONSTRUCTION

SHEET 5 OF 6

PHASE II LANDSCAPE CALCULATIONS

AREA IN PARCEL 6.14 ACRES
VEHICULAR SURFACE AREA 1.29 ACRES
TREES PROVIDED 18 TREES
SCREENING PROVIDED 16 SHRUBS
BUFFER AREA REQUIRED TYPE B 10' WIDTH
THE BUFFER AREA'S EXISTING VEGETATION AND WIDTH EXCEEDS THE REQUIREMENT.
THE FOLLOWING SIGNIFICANT VEGETATION WAS IDENTIFIED IN THE BUFFER AREA:
1-3" DBH ACER RUBRUM
1-11" DBH ACER RUBRUM
2-9" DBH LIQUIDAMBER STYRACIFLUA
4-9" DBH PINUS TAEDA
1-10" DBH QUERCUS PHELLOS
1-84" DBH QUERCUS PHELLOS
1-120" DBH QUERCUS PHELLOS
THE EXISTING BUFFER ALSO CONTAINS OTHER VEGETATION CONSISTING OF DECIDUOUS AND EVERGREEN SAPLINGS AND UNDERGROWTH.

PHASE II SITE DATA:

ZONING RESOURCE & CONSERVATION
TRACT ACREAGE 6.14 ACRES
TOTAL SQUARE FOOTAGE OF VEHICULAR USE AREA 56,458 SF (1.29 AC)
NUMBER OF PARKING SPACES PROPOSED 147 SPACES
NUMBER OF HANDICAP PARKING SPACES PROPOSED 5 SPACES

TOTAL SITE DATA:

SITE ACREAGE 33.6 ACRES
VEHICULAR SURFACE AREA SF 160,558 SF (3.68 AC)
TOTAL # OF PARKING SPACES 443 SPACES
TOTAL # OF HANDICAP SPACES 12 SPACES

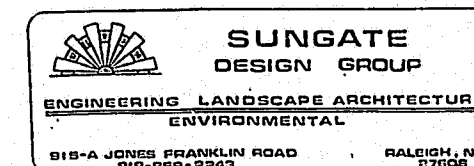
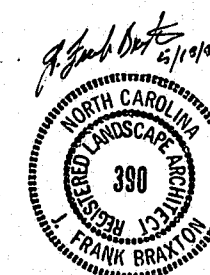

REVISIONS