

02/15/01 TOWN OF CARY COMMENTS	4
SKL-6 PLANTING BID 2	99-137 8/01/00
DENOTES CHANGES	
CENTREGREEN PARK AT WESTON 900 CENTREGREEN WAY CARY, NORTH CAROLINA	CENTRAL PARK - LANDSCAPE PLAN (BID #2)
CMSS ARCHITECTS, P.C.	

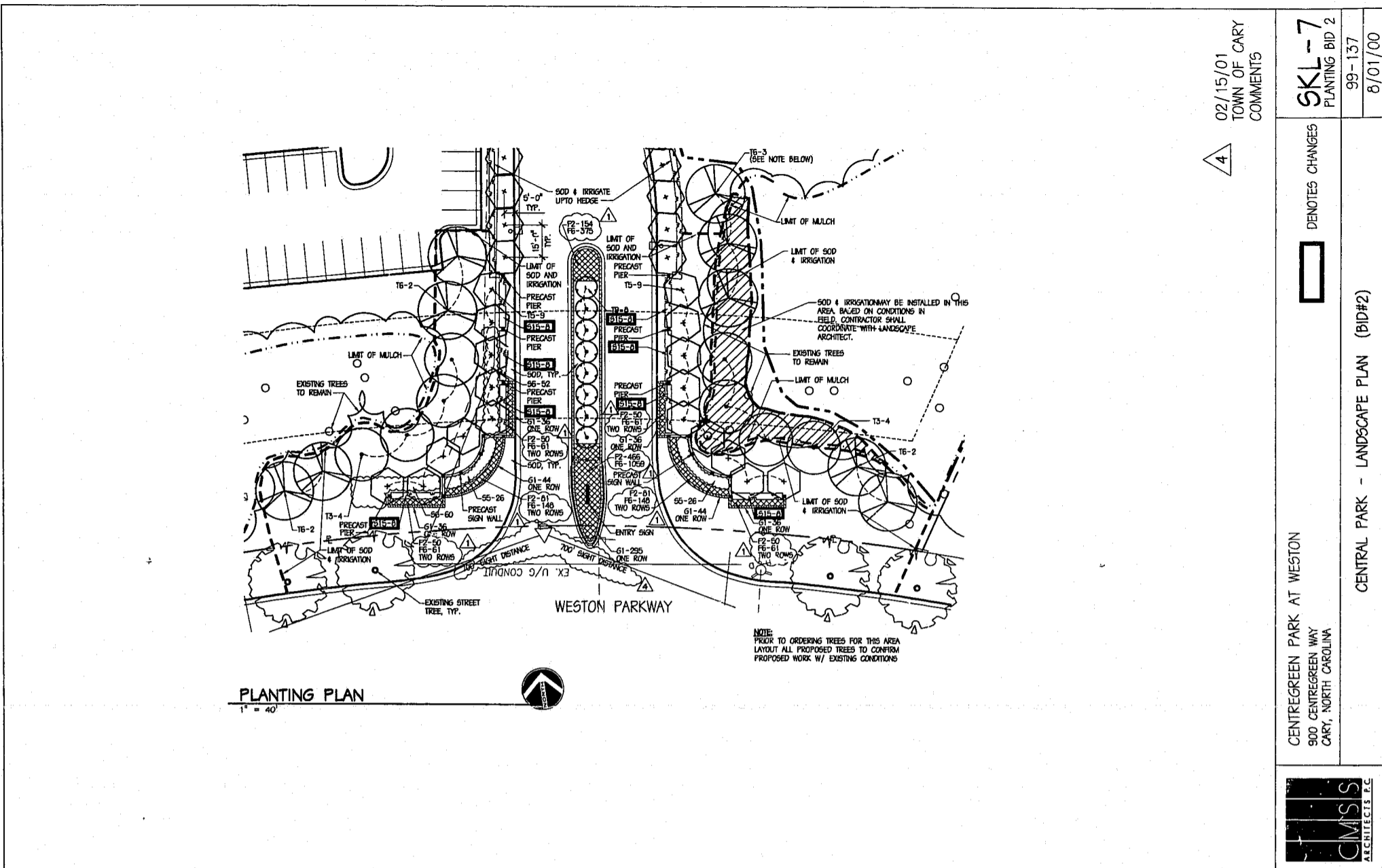

02/15/01 TOWN OF CARY COMMENTS	4
SKL-7 PLANTING BID 2	99-137 8/01/00
DENOTES CHANGES	
CENTREGREEN PARK AT WESTON 900 CENTREGREEN WAY CARY, NORTH CAROLINA	CENTRAL PARK - LANDSCAPE PLAN (BID#2)
CMSS ARCHITECTS, P.C.	

CMSS Architects, P.C. reserves the rights under common law copyright and ownership rights in connection with the designs, concepts, and drawings presented in this document. This document(s) and/or design(s) shall not be reproduced, changed, or copied in any form or any manner, whatsoever, nor shall they be assigned to any third party without expressed written consent of CMSS Architects, P.C. © 2000.

CMSS Architects, P.C. reserves the rights under common law copyright and ownership rights in connection with the designs, concepts, and drawings presented in this document. This document(s) and/or design(s) shall not be reproduced, changed, or copied in any form or any manner, whatsoever, nor shall they be assigned to any third party without expressed written consent of CMSS Architects, P.C. © 2000.

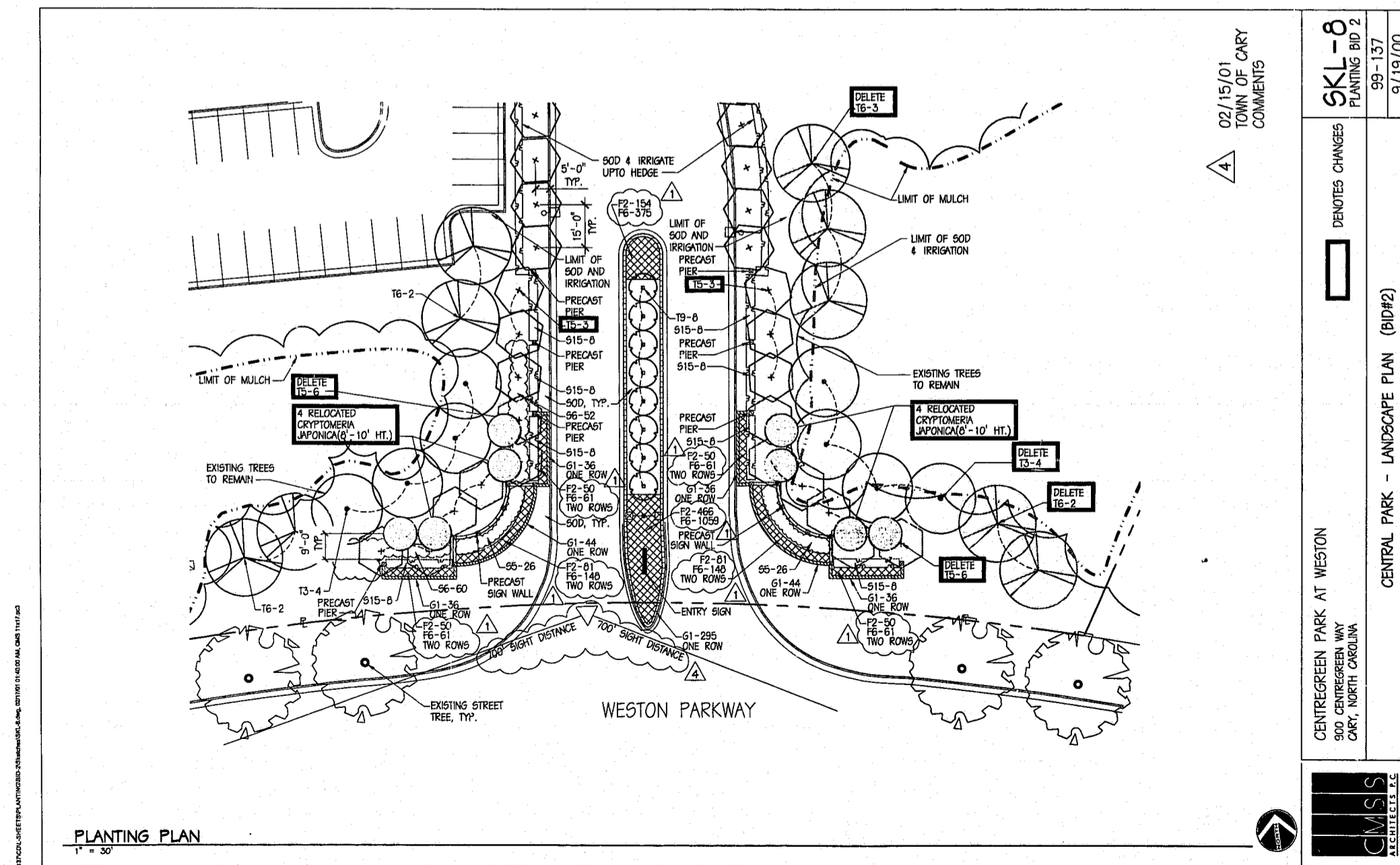

02/15/01 TOWN OF CARY COMMENTS	4
SKL-8 PLANTING BID 2	99-137 9/19/00
DENOTES CHANGES	
CENTREGREEN PARK AT WESTON 900 CENTREGREEN WAY CARY, NORTH CAROLINA	CENTRAL PARK - LANDSCAPE PLAN (BID#2)
CMSS ARCHITECTS, P.C.	

CMSS Architects, P.C. reserves the rights under common law copyright and ownership rights in connection with the designs, concepts, and drawings presented in this document. This document(s) and/or design(s) shall not be reproduced, changed, or copied in any form or any manner, whatsoever, nor shall they be assigned to any third party without expressed written consent of CMSS Architects, P.C. © 2000.

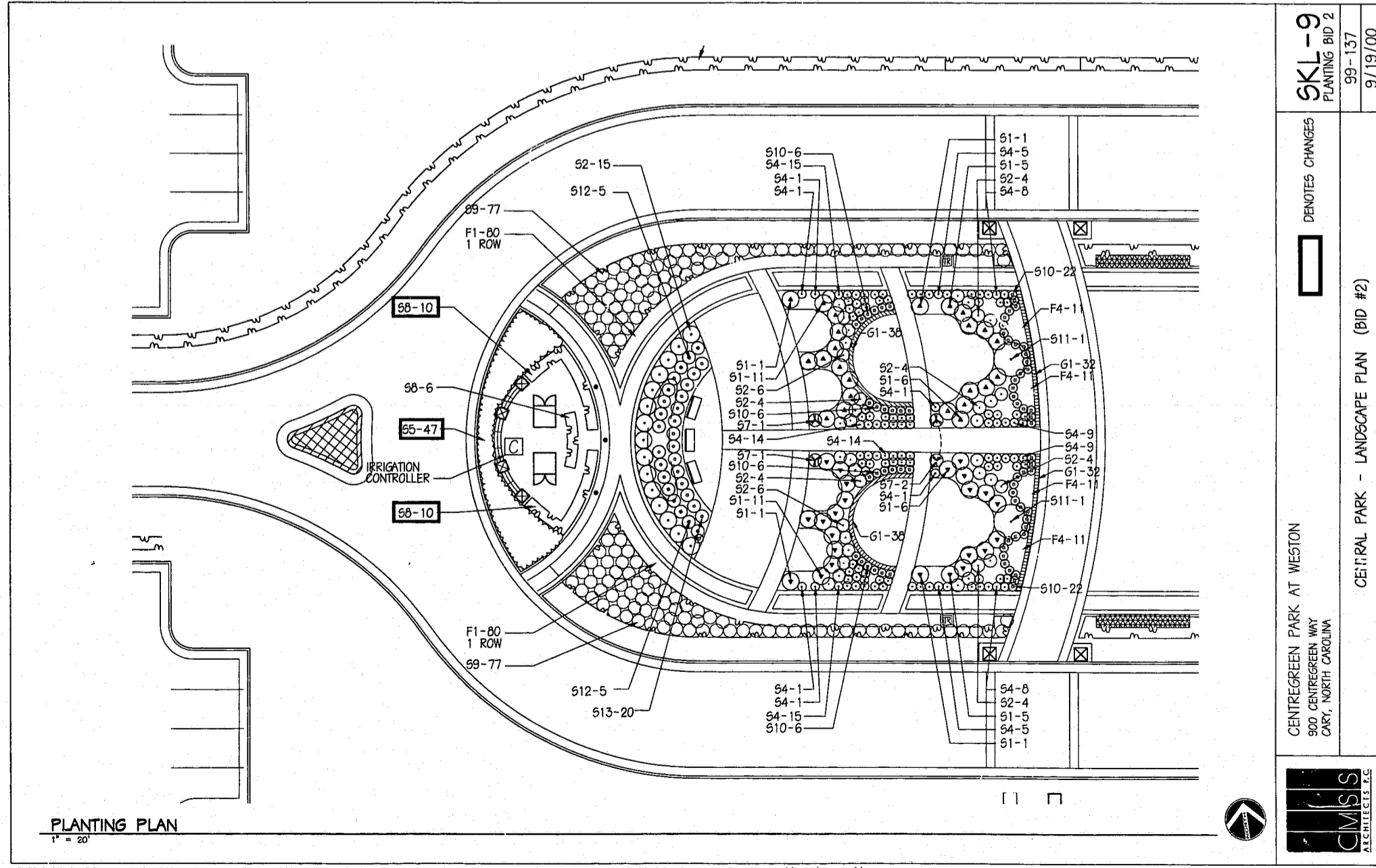

02/15/01 TOWN OF CARY COMMENTS	4
SKL-9 PLANTING BID 2	99-137 9/19/00
DENOTES CHANGES	
CENTREGREEN PARK AT WESTON 900 CENTREGREEN WAY CARY, NORTH CAROLINA	CENTRAL PARK - LANDSCAPE PLAN (BID #2)
CMSS ARCHITECTS, P.C.	

CMSS Architects, P.C. reserves the rights under common law copyright and ownership rights in connection with the designs, concepts, and drawings presented in this document. This document(s) and/or design(s) shall not be reproduced, changed, or copied in any form or any manner, whatsoever, nor shall they be assigned to any third party without expressed written consent of CMSS Architects, P.C. © 2000.

PLANTING BID 2.