

**ENTRY SIGN**

**PARK SIGN**

**1 ENLARGED SIGN PLANS**  
SCALE: 1/8" = 1'-0"

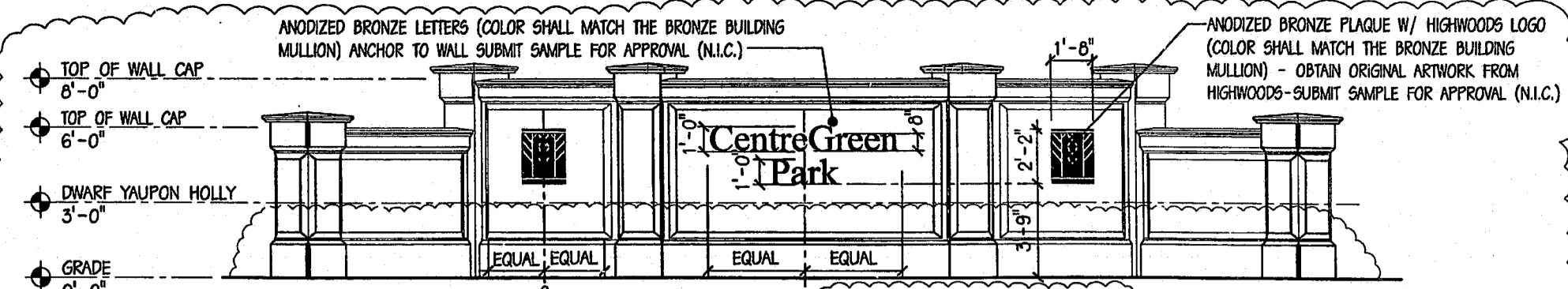

**2 ENTRY SIGN ELEVATION (2 TOTAL)**  
SCALE: 1/4" = 1'-0"

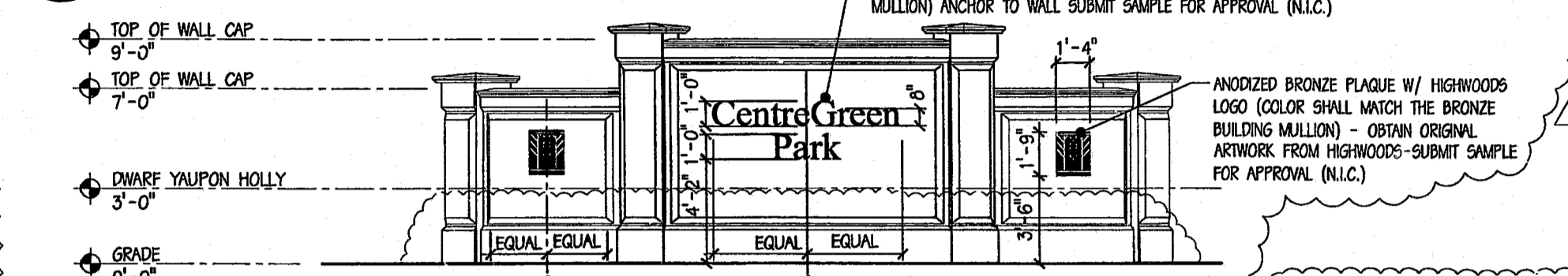

**3 CENTRAL PARK SIGN ELEVATION (1 TOTAL)**  
SCALE: 1/4" = 1'-0"

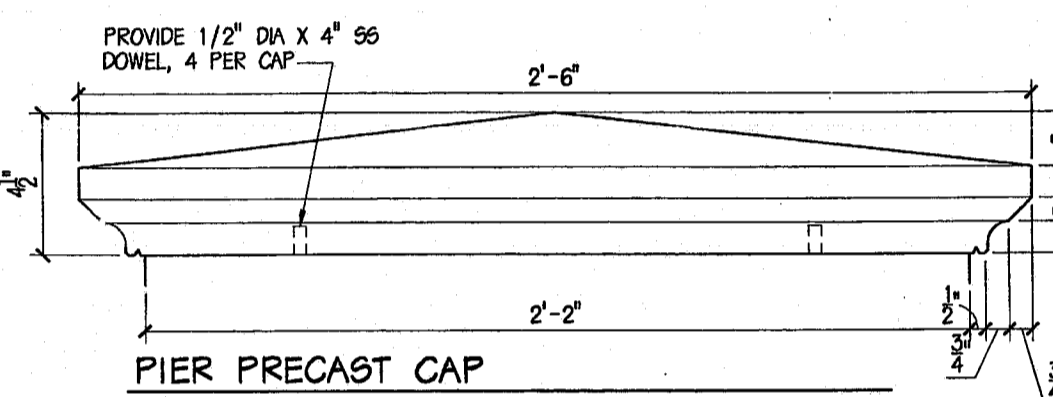

**PIER PRECAST CAP**

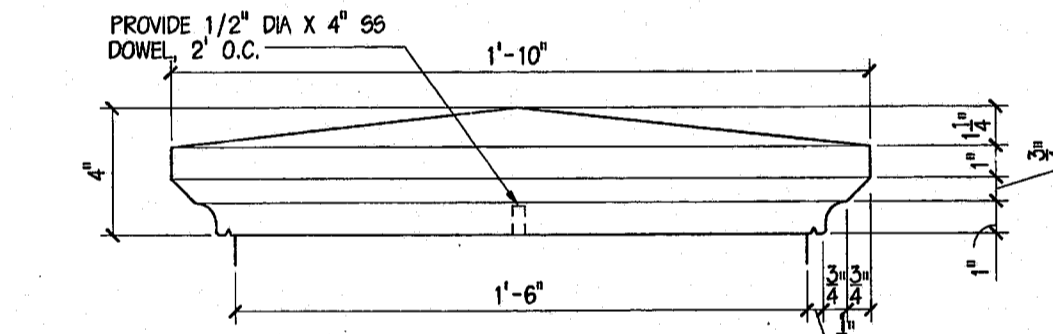

**WALL PRECAST CAP**

**4 PRECAST CAP DETAILS**  
SCALE: 3" = 1'-0"

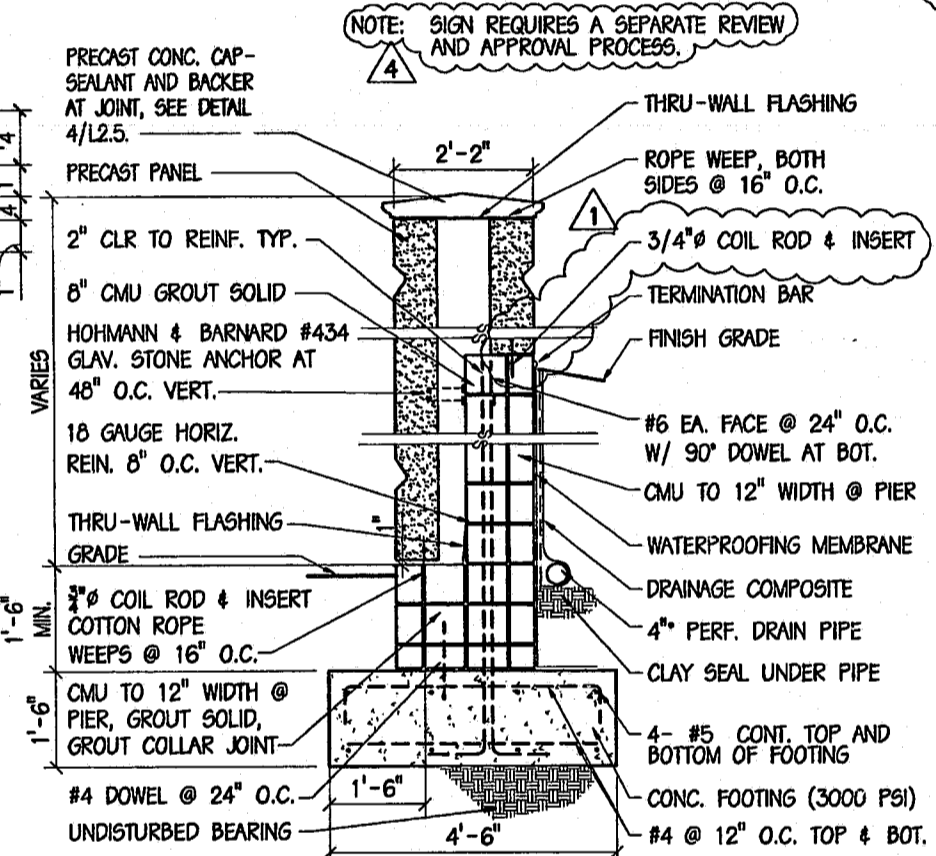

**5 SECTION @ RETAINING SIGN PIER**  
SCALE: 1/2" = 1'-0"

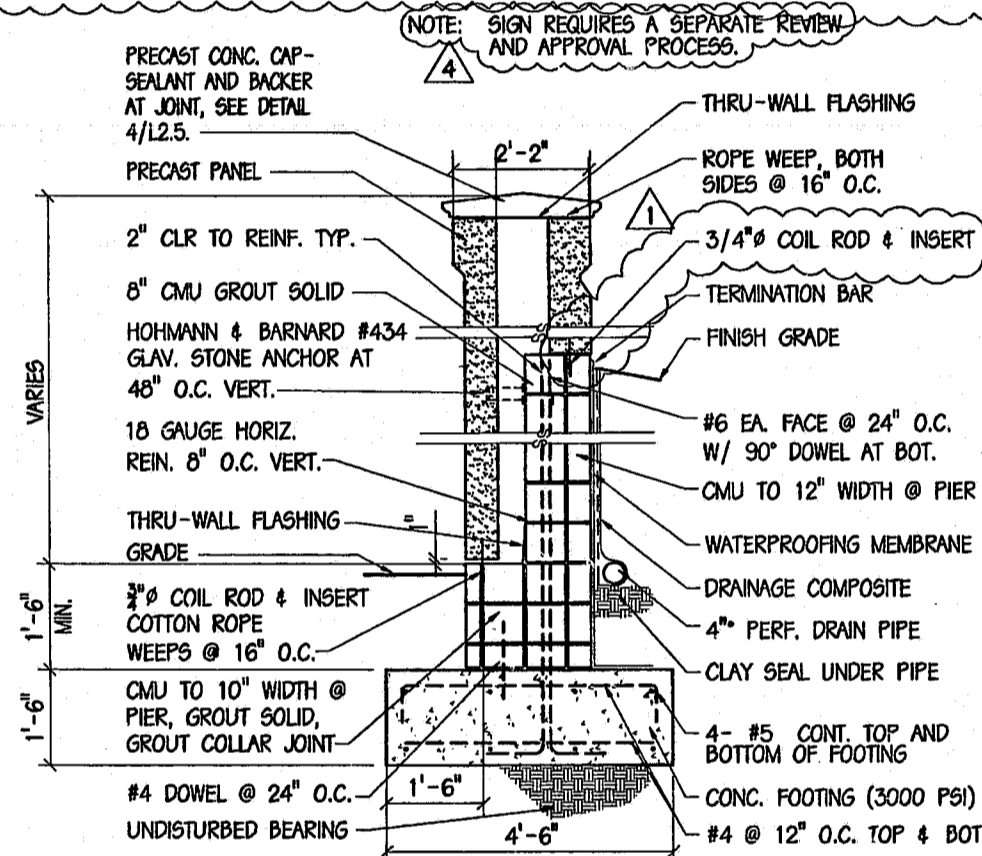

**6 SECTION @ RETAINING SIGN PIER**  
SCALE: 1/2" = 1'-0"

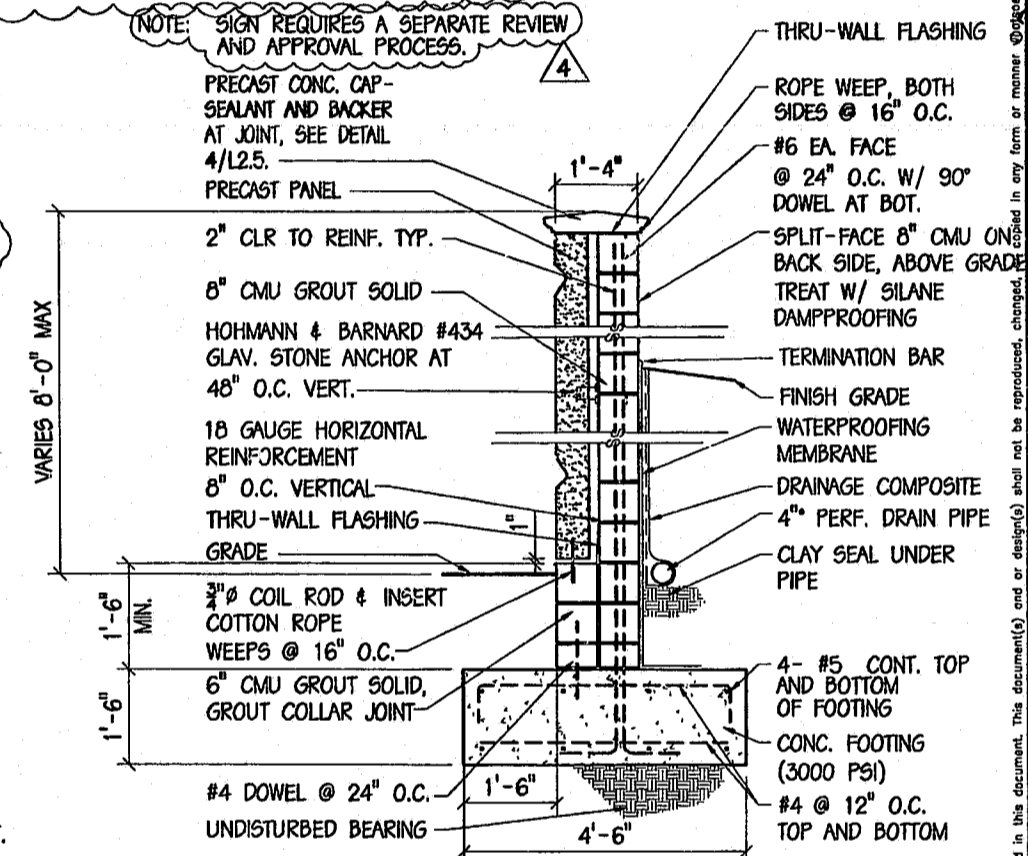

**7 SECTION @ RETAINING SIGN WALL**  
SCALE: 1/2" = 1'-0"

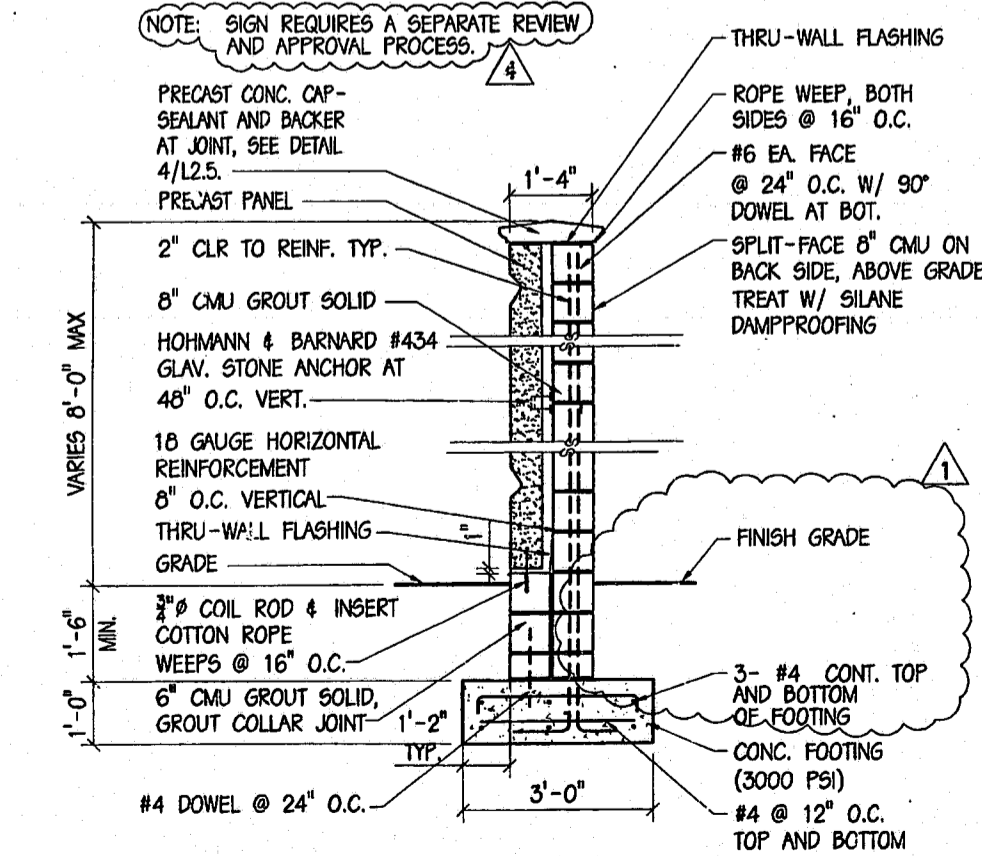

**8 SECTION @ SIGN WALL**  
SCALE: 1/2" = 1'-0"

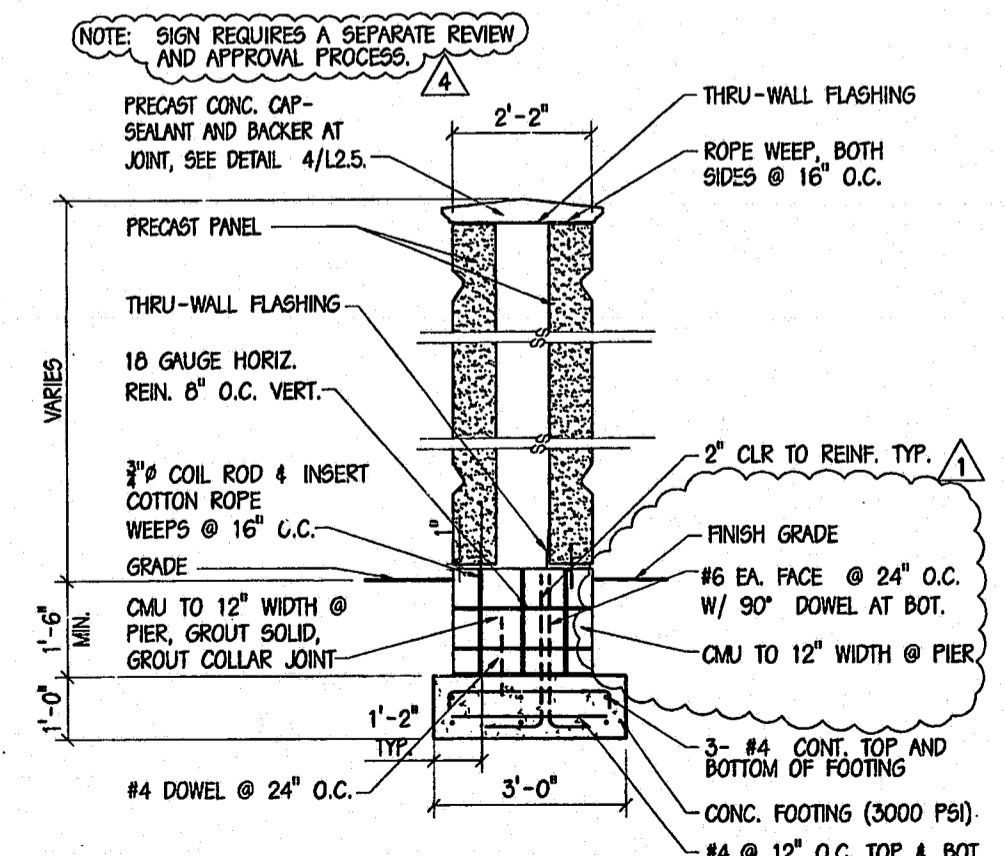

**9 SECTION @ SIGN PIER**  
SCALE: 1/2" = 1'-0"

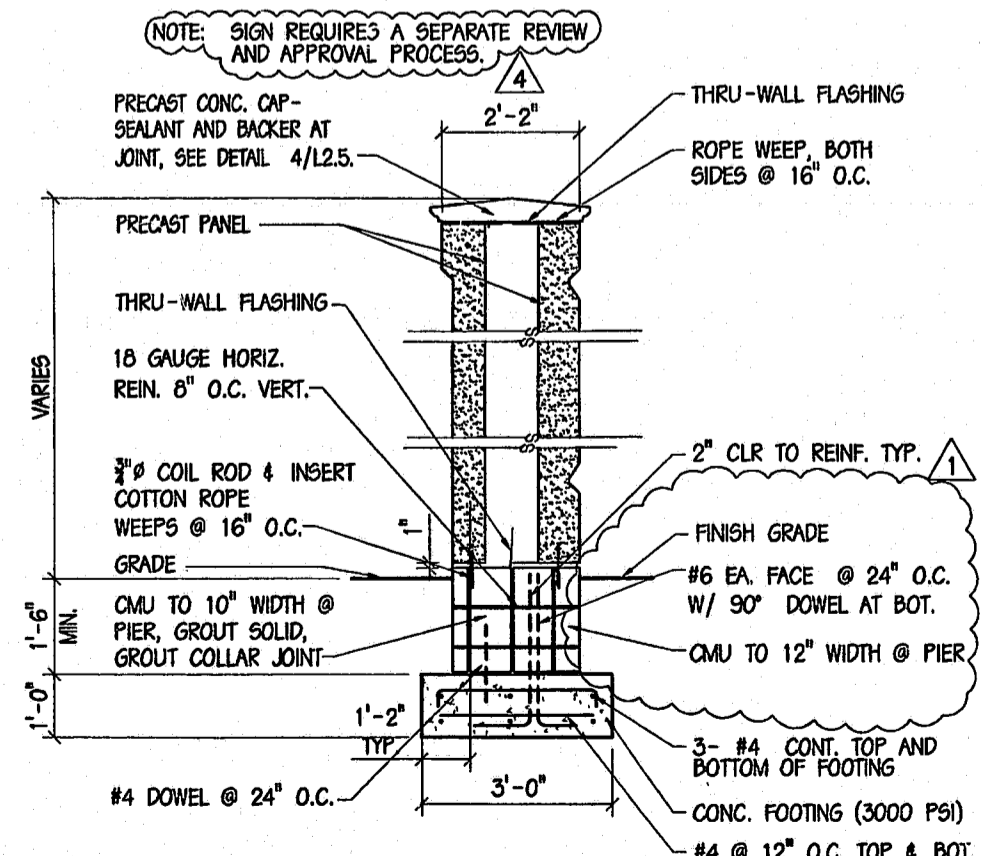

**10 SECTION @ SIGN PIER**  
SCALE: 1/2" = 1'-0"

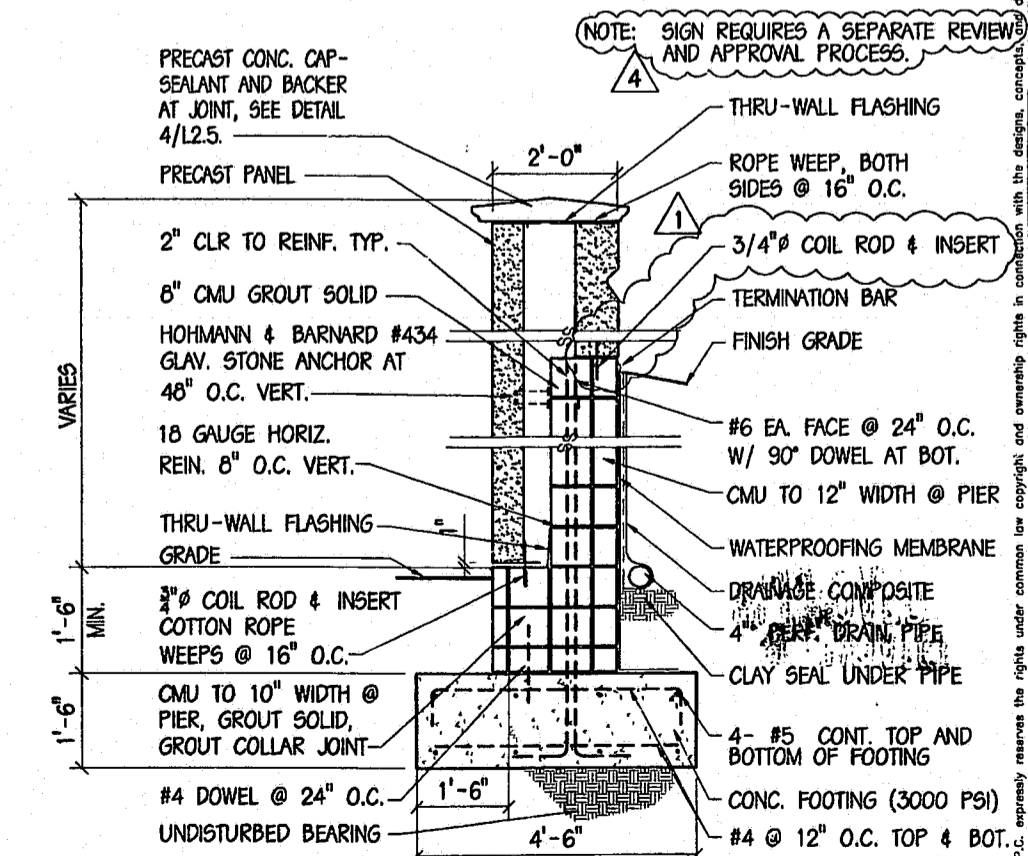

**11 SECTION @ RETAINING SIGN PIER**  
SCALE: 1/2" = 1'-0"



SUITE 200  
5041 CORPORATE WOODS DRIVE  
VIRGINIA BEACH, VIRGINIA 23462  
(757) 222-2010

DES. MU DR. PW,CHK. JJC

DATE MAR. 31, 2000

REVISIONS

1	4/07/00
2	6/11/00
4	02/15/01 T.O.C. COMMENTS

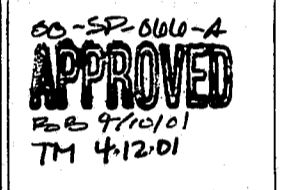
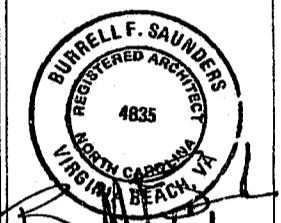

**CENTRAL PARK AT CENTREGREEN**  
CARY, NORTH CAROLINA  
900 CENTREGREEN WAY

**SIGN PLANS & SECTIONS**

PROJECT NO. 99-137

**L2.5**

HARDSCAPE PLAN  
SHEET OF