

CMSS Architects, P.C. reserves the rights under common law copyright and ownership rights in connection with the design, concepts, and drawings presented in this document. This document(s) and/or design(s) shall not be reproduced, changed, or copied in any form or any manner, whatsoever, nor shall they be assigned to any third party without expressed written consent of CMSS Architects, P.C. © 2000.

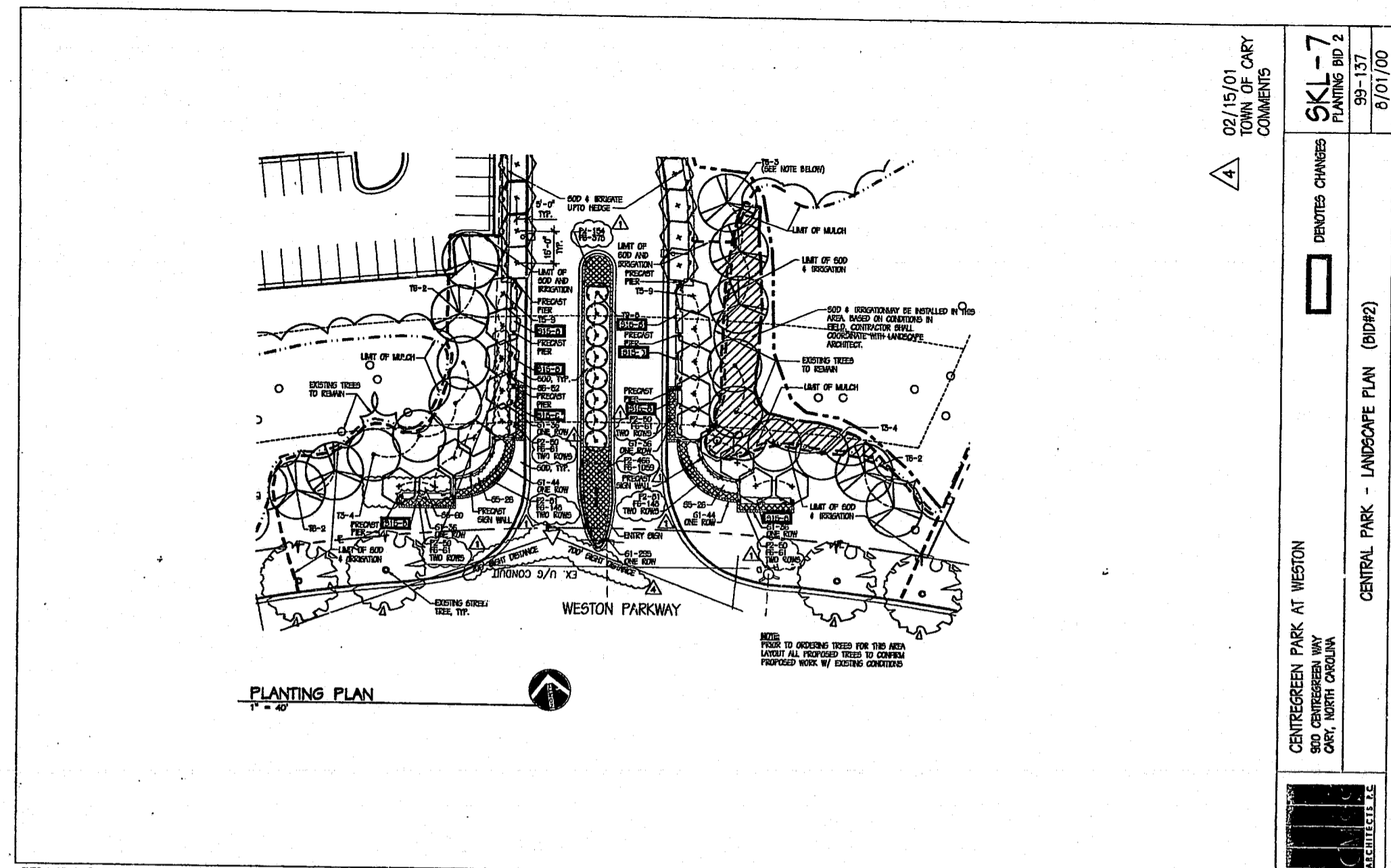

CMSS Architects, P.C. reserves the rights under common law copyright and ownership rights in connection with the design, concepts, and drawings presented in this document. This document(s) and/or design(s) shall not be reproduced, changed, or copied in any form or any manner, whatsoever, nor shall they be assigned to any third party without expressed written consent of CMSS Architects, P.C. © 2000.

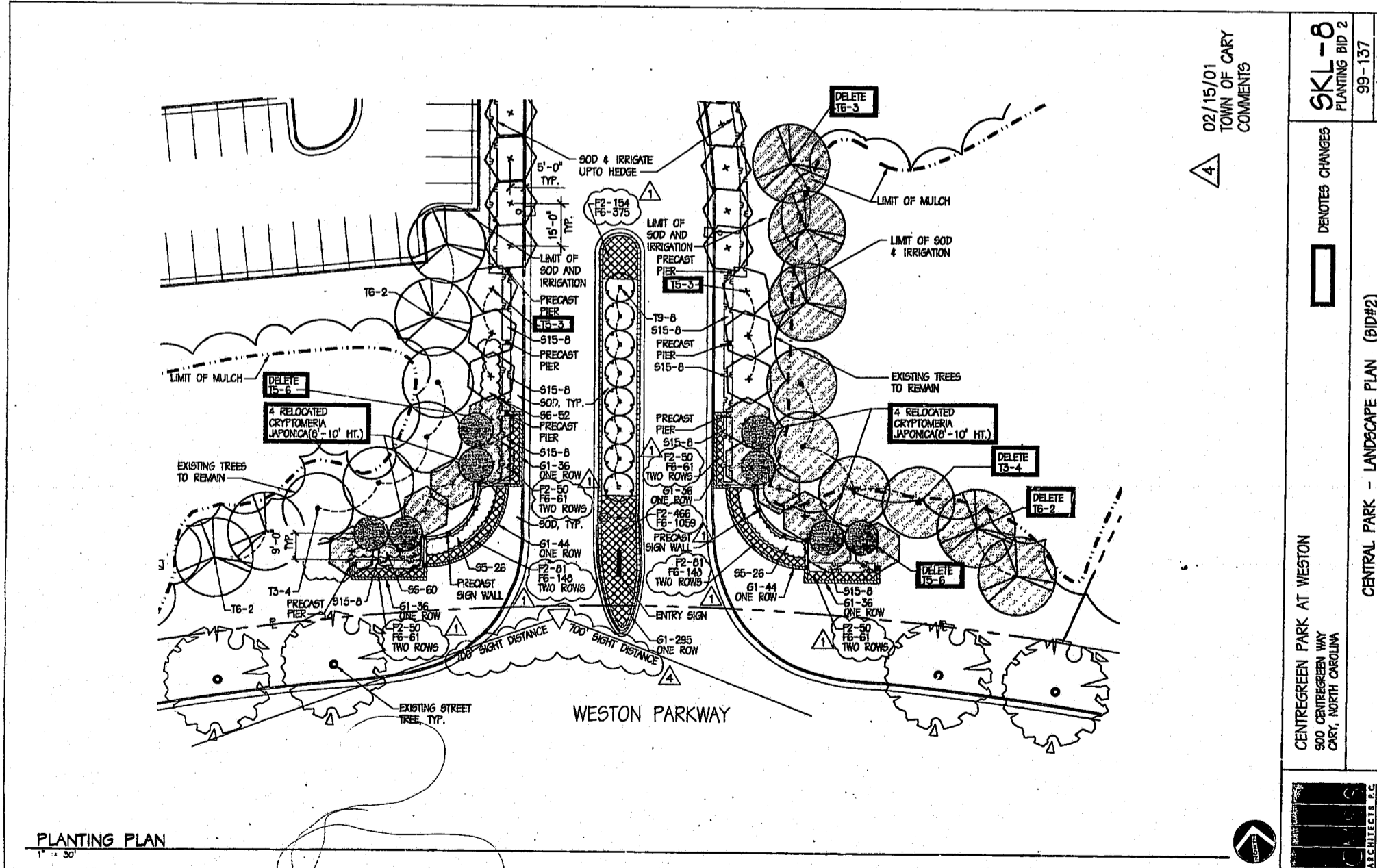

CMSS Architects, P.C. reserves the rights under common law copyright and ownership rights in connection with the design, concepts, and drawings presented in this document. This document(s) and/or design(s) shall not be reproduced, changed, or copied in any form or any manner, whatsoever, nor shall they be assigned to any third party without expressed written consent of CMSS Architects, P.C. © 2000.

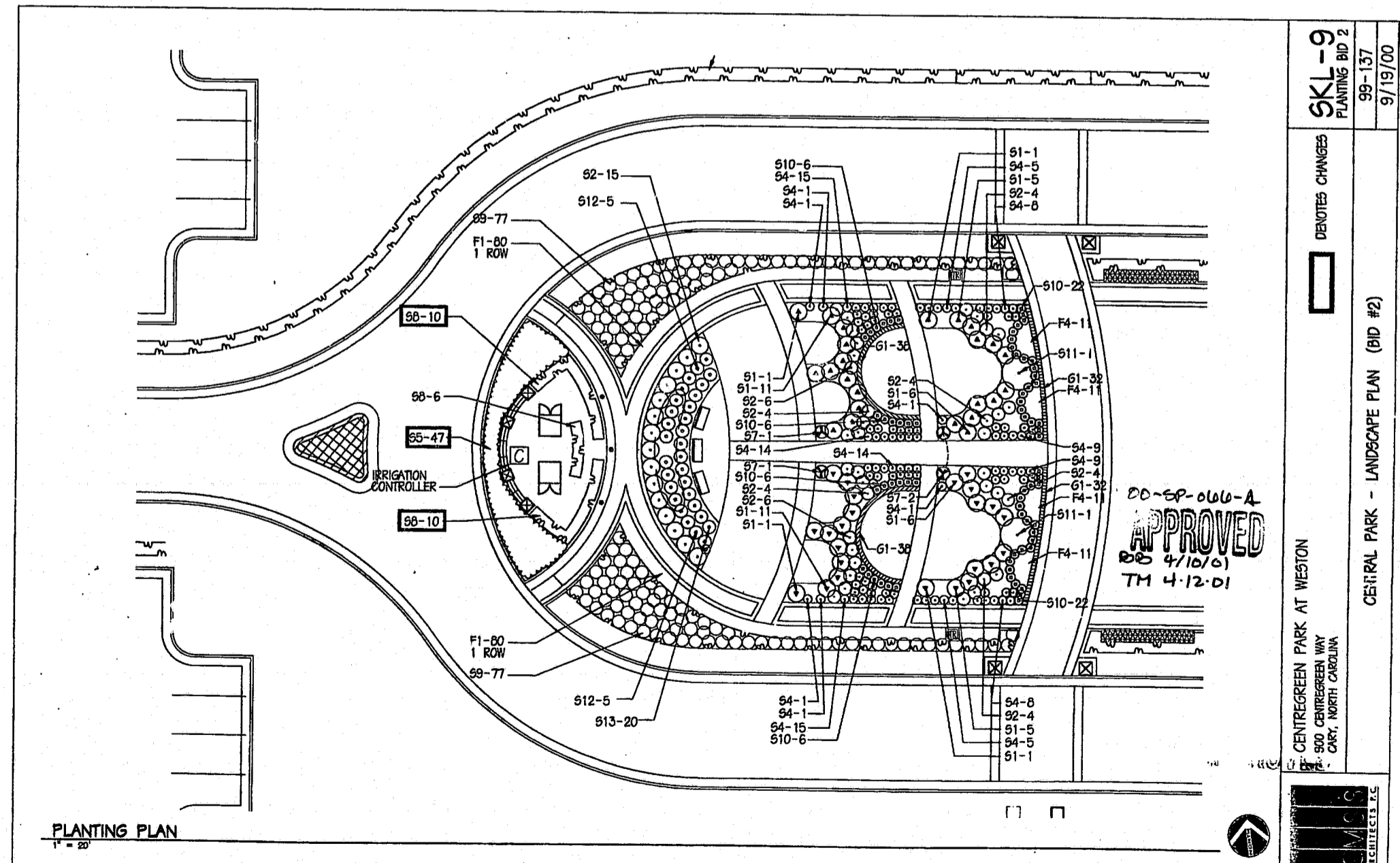

CMSS Architects, P.C. reserves the rights under common law copyright and ownership rights in connection with the design, concepts, and drawings presented in this document. This document(s) and/or design(s) shall not be reproduced, changed, or copied in any form or any manner, whatsoever, nor shall they be assigned to any third party without expressed written consent of CMSS Architects, P.C. © 2000.

PLANTING BID 2.