

NOTE: WATER AND SEWER SERVICE LOCATIONS SHALL BE COORDINATED WITH THE DEVELOPER. WATER METER SIZE SHALL BE DETERMINED BASED ON DEMAND FOR EACH LOT. (TO BE DETERMINED AS EACH LOT IS DEVELOPED)

IT'S THE LAW!  
AS OF JANUARY 1, 1986, NORTH CAROLINA STATE LAW REQUIRES ANYONE EXCAVATING WITH MECHANICAL EQUIPMENT ON HIGHWAY RIGHTS-OF-WAY, PRIVATE UTILITY EASEMENTS, OR PUBLIC SPACES TO NOTIFY ALL UTILITIES TWO (2) WORKING DAYS PRIOR TO DIGGING.

200' VC  
C.V.P.I. STA = 11+50  
C.V.P.I. ELEV = 385.87  
CURVE LEN = 200.00  
K = 35.42  
E = -1.41

CURVE 00  
R = 900.00  
DELTA = 192°49'52"  
L = 207.87  
E = -104.89  
CHORD = 206.84

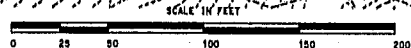

ALL CONSTRUCTION SHALL CONFORM TO CURRENT TOWN OF CARY STANDARDS AND SPECIFICATIONS.

SCALE: HOR. 1" = 60'  
VERT. 1" = 6'

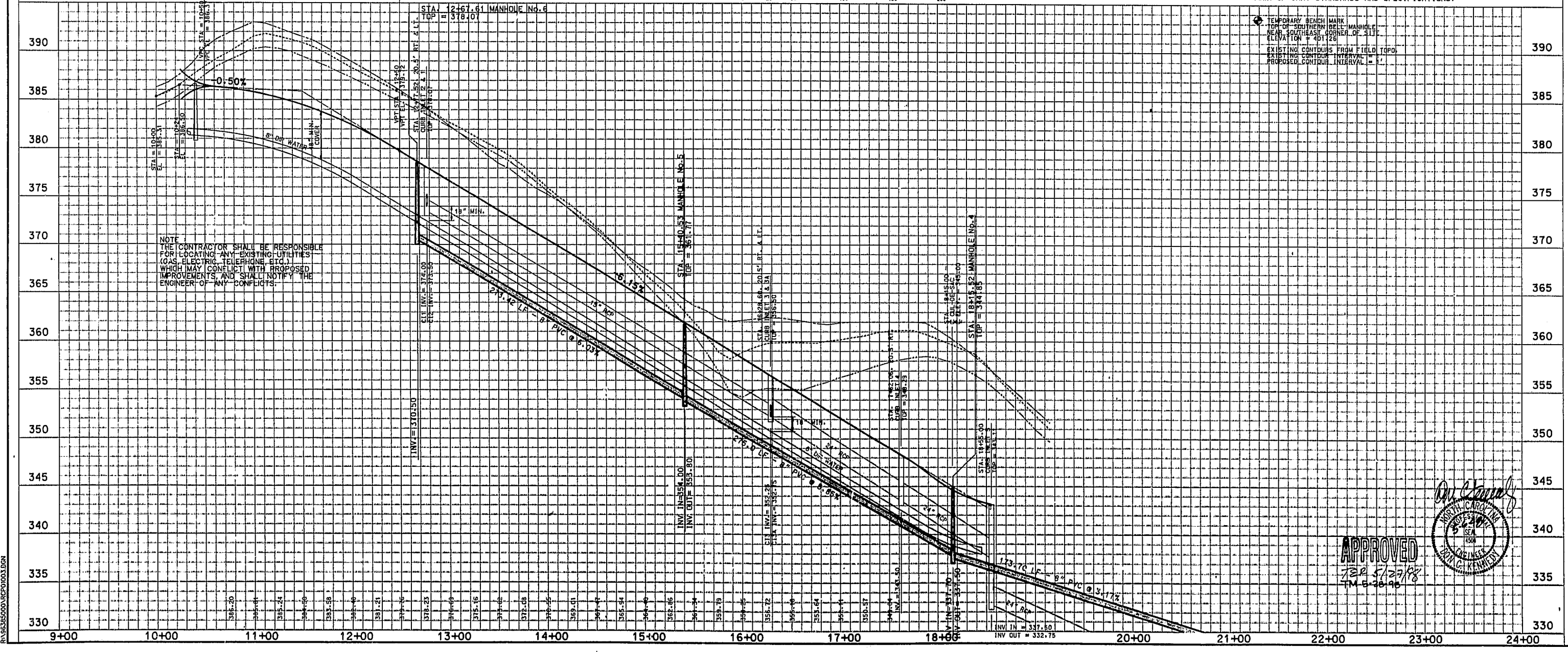

TEMPORARY BENCH MARK  
TOP OF SOUTHERN BELL MANHOLE  
NEAR SOUTHEAST CORNER OF 3112  
ELEVATION = 401.26  
EXISTING CONTOURS FROM FIELD TOPO.  
ELEVATION INTERVAL = 1'  
PROPOSED CONTOUR INTERVAL = 1'

NOTE:  
THE CONTRACTOR SHALL BE RESPONSIBLE FOR LOCATING ANY EXISTING UTILITIES (GAS, ELECTRIC, TELEPHONE, ETC.) WHICH MAY CONFLICT WITH PROPOSED IMPROVEMENTS, AND SHALL NOTIFY THE ENGINEER OF ANY CONFLICTS.

APPROVED  
722 5/27/88  
TM 6-28-96



**BNK**

BASS, NIXON, & KENNEDY, INC., CONSULTING ENGINEERS  
919-851-4422 7416 CHAPEL HILL ROAD, RALEIGH, N. C. 27607

JOB NO.	DATE	DRAWN BY	NO.	DATE	REVISIONS
			1	5/4/98	

**PLAN & PROFILE**

SCALE: 1" = 50' H., 1" = 5' V

**CENTREWEST SOUTH**  
CARY, WAKE COUNTY, NORTH CAROLINA

**PERMITTED FOR CONSTRUCTION**

SHEET **C41**  
5 OF 7

QUADE DRIVE