

© JERRY TURNER & ASSOCIATES, INC. THIS DOCUMENT IS THE PROPERTY OF JERRY TURNER & ASSOCIATES, INC. ANY REPRODUCTION, REPRODUCTION, OR OTHER USE OF THIS DOCUMENT WITHOUT THE PRIOR PERMISSION OF JERRY TURNER & ASSOCIATES IS EXPRESSLY PROHIBITED.

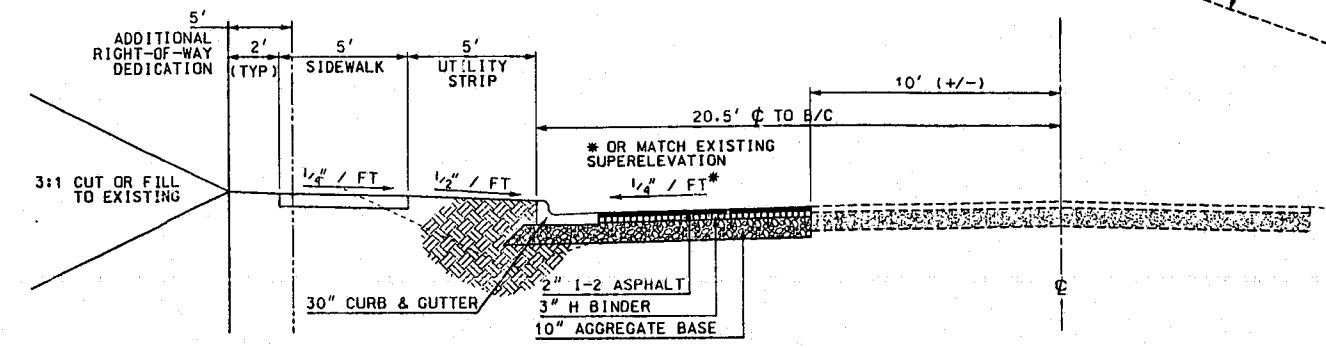

**TYPICAL CROSS SECTION
PINEY PLAINS ROAD WIDENING**
1" = 5'

IT'S THE LAW!
AS OF JANUARY 1, 1986, NORTH CAROLINA STATE LAW
REQUIRES ANYONE EXCAVATING WITH MECHANICAL
EQUIPMENT ON HIGHWAY RIGHTS-OF-WAY, PRIVATE
UTILITY EASEMENTS, OR PUBLIC SPACES TO NOTIFY
ALL UTILITIES TWO (2) WORKING DAYS PRIOR TO
DIGGING.

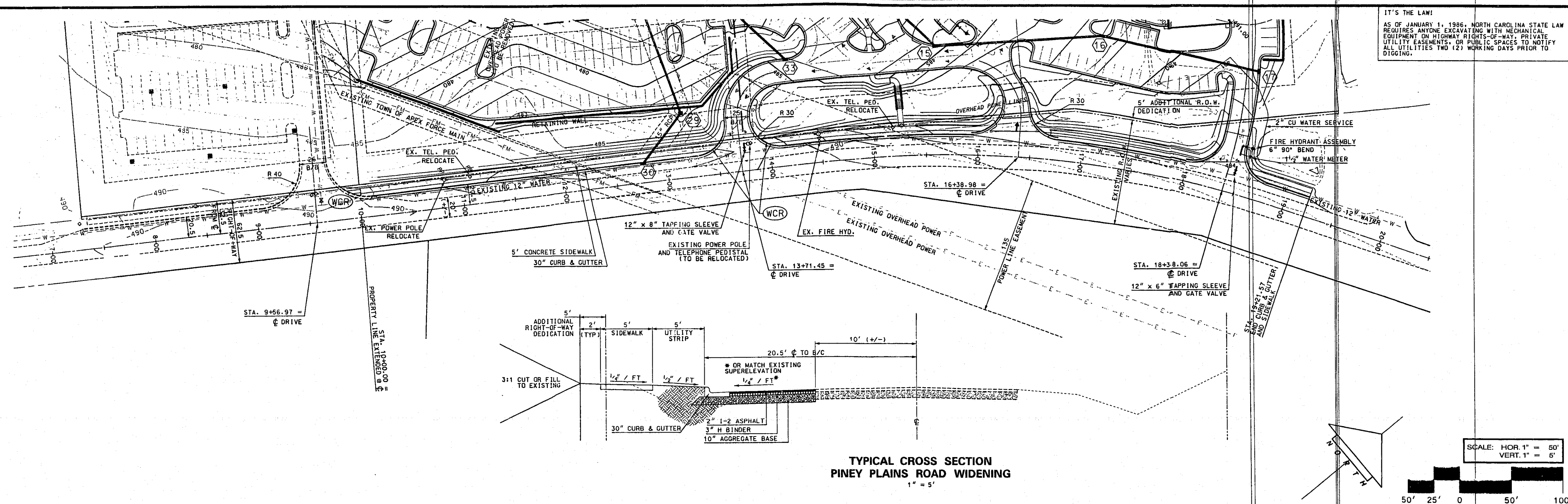

JERRY TURNER & ASSOCIATES, INC.

Landscape Architecture
Land Planning
Environmental Design

905 Jones Franklin Road
Raleigh, North Carolina 27606
(919) 851-7150 fax: (919) 851-7547

277 S.E. 5th Avenue
Delray Beach, Florida 33483
(561) 276-0453 fax: (561) 272-7593

PROJECT
**CROSSROADS
FORD
SERVICE
CENTER**
1660 PINEY PLAINS ROAD
CARY, NORTH CAROLINA

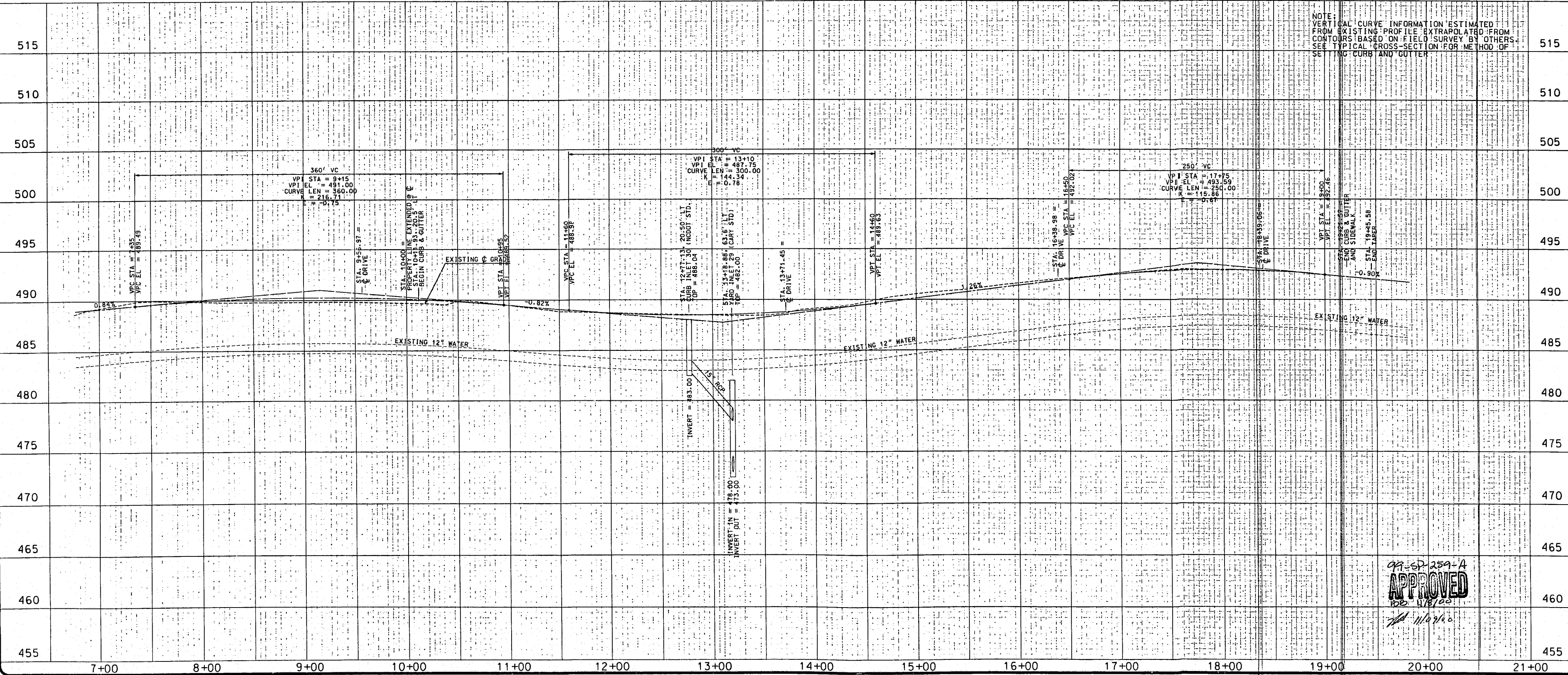
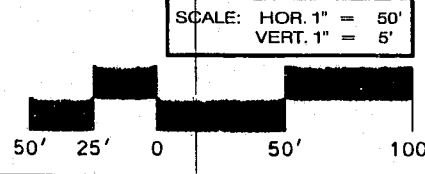

NOTE: VERTICAL CURVE INFORMATION ESTIMATED
FROM EXISTING PROFILE EXTRAPOLATED FROM
CONTOURS BASED ON FIELD SURVEY BY OTHERS.
SEE TYPICAL CROSS-SECTION FOR METHOD OF
SETTING CURB AND GUTTER.



BASS, NIXON, & KENNEDY, INC.
CONSULTING ENGINEERS
7416 CHAPEL HILL ROAD
RALEIGH, NC 27607
PHONE: (919) 851-4422
FAX: (919) 851-8968

REVISIONS
MARCH 6, 2000 (SHEET ADDED)
APRIL 17, 2000
MAY 15, 2000
SEPTEMBER 18, 2000

DRAWN: BCB CHECKED: WHM
SCALE: DATE: 12/06/99
1" = 50'

TITLE
**PLAN &
PROFILE
(PINEY PLAINS
ROAD)
(SR 1423)**

FILE NO. JOB NO.
SCALE: JTA # 2351.02
1" = 50' BNK # 99472000
SHEET NO.

APPROVED
11/10/00



SITE-10