

**EROSION CONTROL NARRATIVE:**  
 THE DYNASTY RIDGE SITE IS TO BE A MULTI-FAMILY DEVELOPMENT. THE SITE IS PART OF THE BLACKHAWK PLANNED UNIT DEVELOPMENT. APPROXIMATELY 4.7 ACRES OF THE 12 ACRE SITE WILL BE DEVELOPED. THE SITE WAS PREVIOUSLY CLEARED AND PARTIALLY GRADED WITH THE CONSTRUCTION OF THE CHESAPEAKE LANDING RECREATION CENTER. THE RECREATION CENTER CAN BE ACCESSED VIA WEISBURG DRIVE WHICH RUNS FROM WEST DYNASTY DRIVE TO THE RECREATION CENTER.

**ENERGY DISSIPATOR SUMMARY - 3/31/94**  
 DYNASTY RIDGE

STRUCTURE #	DIMENSIONS		CLASS	
	LENGTH (FEET)	WIDTH (FEET)	DEPTH (FEET)	RIP RAP
FES1	12	14	2.5	2
FES3	8	10	2.5	2
FES4	8	10	2.5	2
FES5	8	10	2.5	2

WILL BE LAID ON MIRAFI 140L GEOTEXTILE.

**EROSION CONTROL SYMBOLS**

- FILTER BASIN
- TEMPORARY DIVERSION
- ROCK CHECK DAM
- SILT FENCE
- BLOCK AND GRAVEL FILTER
- RIP RAP CHANNEL/DISSIPATOR
- FILTER BERM BASIN
- STRAW MAT
- GRAVEL CONSTRUCTION ENTRANCE

**STORM DRAINAGE SUMMARY 3/31/94**  
 DYNASTY RIDGE

FROM	TO	TYPE/RIM	DIA (IN)	LTH (FT)	SV	AREA (AC)	C	Q10 (CFB)	INVERT DOWN	INVERT UP
FES1	CB2	CB2/424.0	12	70	9.00	1.2	0.8	6.9	413.70	420.00
FES3	CB4	CB4/414.0	12	46	8.70	0.7	0.8	4.0	406.00	410.00
FES5	CB6	CB6/407.0	12	40	28.00	0.4	0.8	2.3	391.00	402.20
FES7	CB8	CB8/394.4	12	40	26.00	0.5	0.8	2.9	380.00	390.40

**NOTES:**  
 -RIM ELEVATION GIVEN FOR GI IS TOP OF GRATE (TOC STD 8.02)  
 -RIP ELEVATION GIVEN FOR CB IS TOP OF CURB (TOC STD 8.03)  
 -UNLESS NOTED OTHERWISE ALL PIPE IS TYPE 115 RCP.  
 -# DENOTES CORRUGATED METAL PIPE.  
 -ALL CONSTRUCTION WILL BE IN ACCORDANCE WITH CURRENT TOWN OF CARY STANDARD SPECIFICATIONS AND DETAILS.  
 -NO 100 YEAR FLOOD PLAIN EXISTS ON SITE AS PER FEDERAL EMERGENCY MANAGEMENT AGENCY FLOOD INSURANCE RATE MAP NUMBER 37183C0311E, MARCH 3, 1992.  
 -THE RECEIVING WATERCOURSE IS AN UNNAMED TRIBUTARY OF CRABTREE CREEK.

**SEDIMENT DEVICE SUMMARY 12/29/93**  
 DYNASTY RIDGE

STR #	DEVELOPED AREA (AC)	DRAIN AREA (AC)	FLOW Q10 (CFB)	BASIN LENGTH (FT)	BASIN WIDTH (FT)	PROP. VOLUME (CF)	CLEAROUT REQ'D (MONTHS)	REQ'D VOLUME (CF)	WTR. LENGTH (FT)
FB1	1.0	1.6	4.6	3	30	20	1800	12	1800
FB2	0.2	0.7	2.0	3	12	10	360	12	360
FB3	0.7	0.8	2.3	4	20	15	1280	12	1280
FB4	0.5	0.8	2.3	3	20	15	900	12	900
FB5	0.5	0.7	2.0	3	20	15	900	12	900

**NOTES:**  
 -110 = 7.22 IN/HR  
 -C = 0.40  
 -TOTAL DEVELOPED AREA = 3.7 ACRES  
 -FB IS FILTER BASIN (TOC STD 4.03)  
 -FEB IS FILTER BERM BASIN (TOC STD 4.04)  
 -SB IS SEDIMENT/RIP RAP BASIN (TOC STD 4.02)  
 -VOLUMES SHOWN ARE FOR SEDIMENT STORAGE ZONE. FLOOD STORAGE ZONE IS ONE FOOT ABOVE SEDIMENT STORAGE ZONE AS PER DETAIL.  
 -EROSION CONTROL INSPECTOR CAN REQUIRE ADDITIONAL EROSION CONTROL MEASURES AS NECESSARY.  
 -ALL SEWER SERVICE TRENCHES ARE TO BE SEEDED AND MULCHED IMMEDIATELY UPON COMPLETION OF BACKFILL.  
 -SEE SHEET 9 FOR CONSTRUCTION SEQUENCE, SEEDING SCHEDULE, SEEDING PREPARATION AND RELATED DETAILS.  
 -ALL CONSTRUCTION IS TO BE IN ACCORDANCE WITH CURRENT TOWN OF CARY STANDARDS AND SPECIFICATIONS.

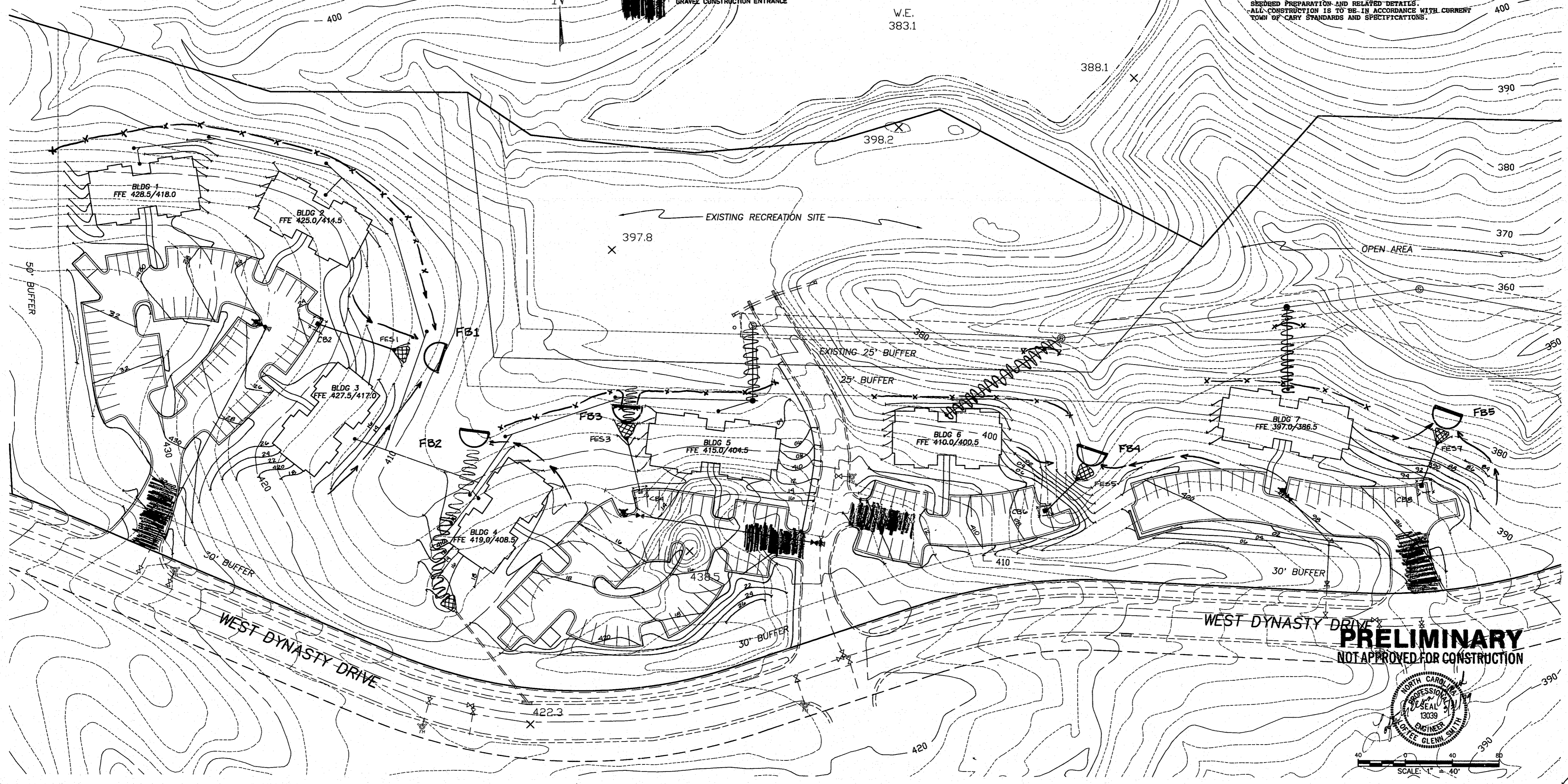

**PRELIMINARY**  
 NOT APPROVED FOR CONSTRUCTION



SCALE: 1" = 40'

**Withers & Ravenel, P.A.**  
 CONSULTING ENGINEERS

**Revisions**

No.	Description	Date	By
1	DEL. COMM. BLDG & EDIT P.LOT	3/31/94	ATB

**DYNASTY RIDGE**

**GRADING, EROSION CONTROL AND STORM DRAINAGE PLAN**

Designer: LGS	Scale: 1" = 40'	CAD File: EHC\SH4
Drawn By: ATB	Date: 12/29/93	Sheet No. 4 of 10
Checked By: LGS	Job No. 93103	