

SANITARY SEWER OUTFALL 'B'

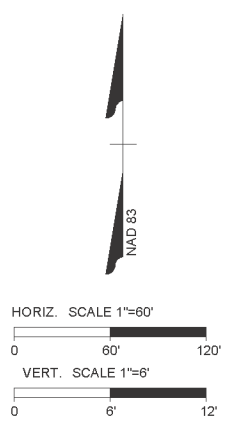

SANITARY SEWER OUTFALL 'C'

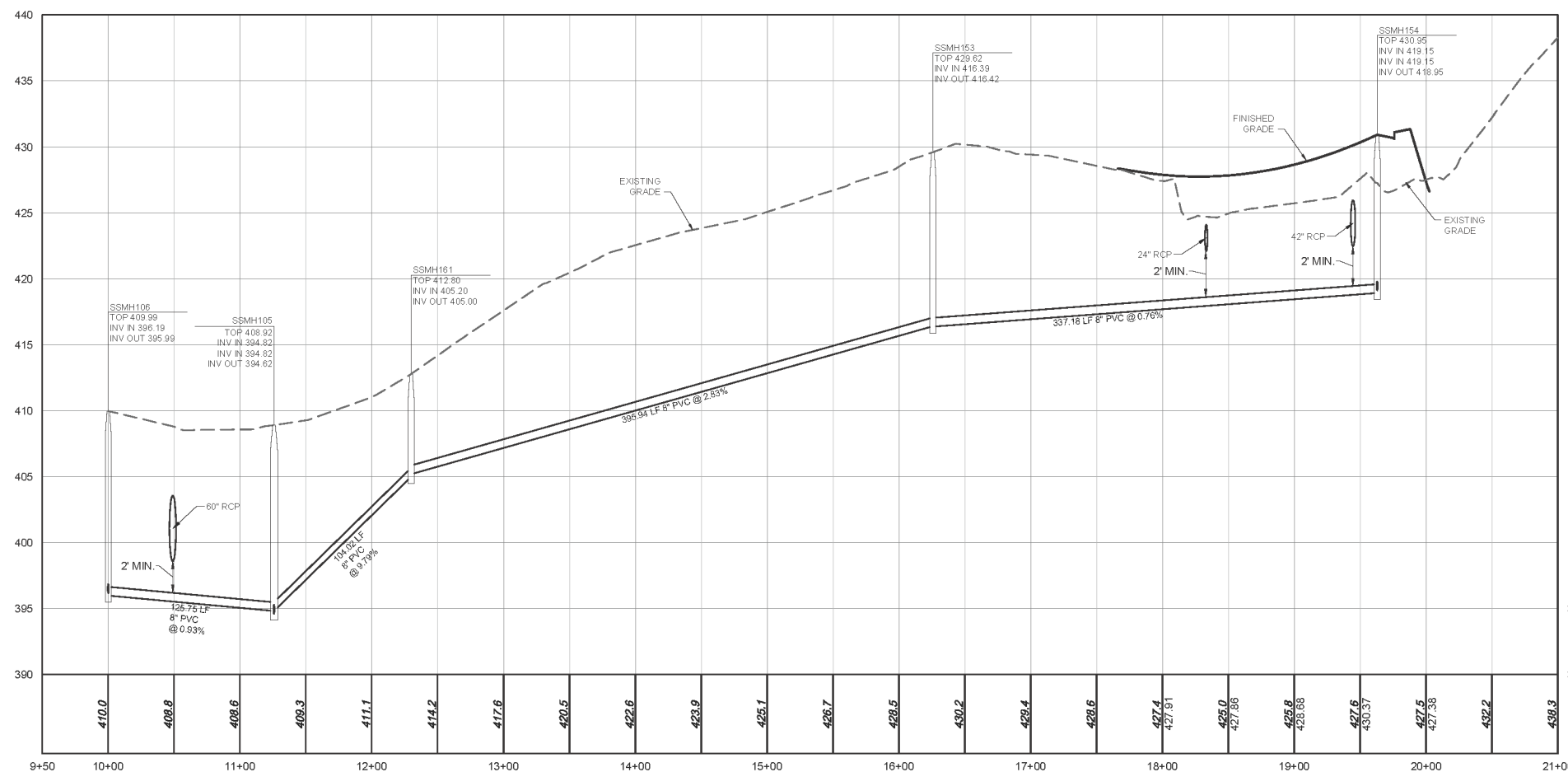
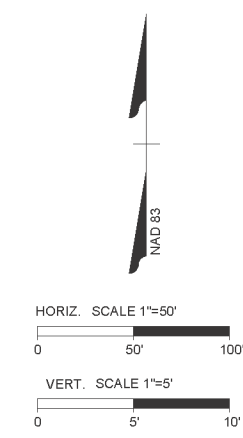
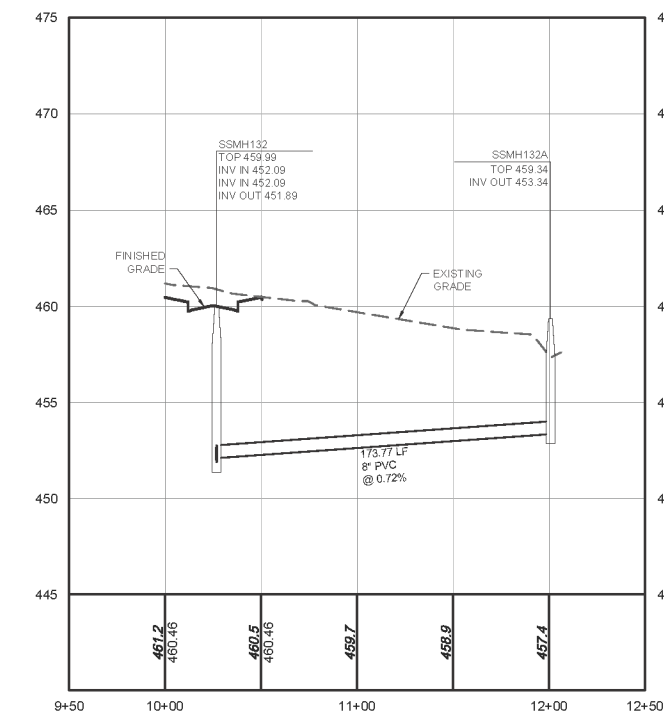

Approved by the Town of Cary  
 Development Review Committee  
 Case Number: 16-SB-002  
 HTE #: 16-0791  
 Date: 5/05/2017



Lindsay Darden, Planner II



THIS DRAWING PREPARED AT THE  
**RALEIGH OFFICE**  
 5410 Trinity Road, Suite 02 | Raleigh, NC 27607  
 TEL 919.866.9551 FAX 919.833.8124 www.timmons.com

YOUR VISION ACHIEVED THROUGH OURS.

DATE	REVISION DESCRIPTION
08-23-2016	REVISED PER TOC REVIEW COMMENTS
10-27-2016	REVISED PER TOC REVIEW COMMENTS
02-21-2017	REVISED PER TOC REVIEW COMMENTS
03-23-2017	REVISED PER TOC REVIEW COMMENTS

DESIGNED BY  
 CHECKED BY  
 SCALE

DATE  
 01/14/2016

DRAWN BY  
 ---

CHECKED BY  
 ---

SCALE  
 ---

**TIMMONS GROUP**  
 NORTH CAROLINA LICENSE NO. C-1652  
 FAIRVIEW PARK  
 TOWN OF CARY - WAKE COUNTY - NORTH CAROLINA  
 SANITARY SEWER OUTFALL B & C

JOB NO.	35556
SHEET NO.	C7.1

These plans and associated documents are the exclusive property of TIMMONS GROUP and may not be reproduced in whole or in part and shall not be used for any purpose whatsoever, inclusive, but not limited to construction, bidding, and/or construction staking without the express written consent of TIMMONS GROUP.