

WEST LAKE ROAD - PUBLIC 60' RW - PLAN VIEW

HIGH POINT ELEV = 478.34
 PVI STA = 15+21.71
 PVI ELEV = 480.47
 A.D. = -5.11%
 K = 69.24
 354' VC

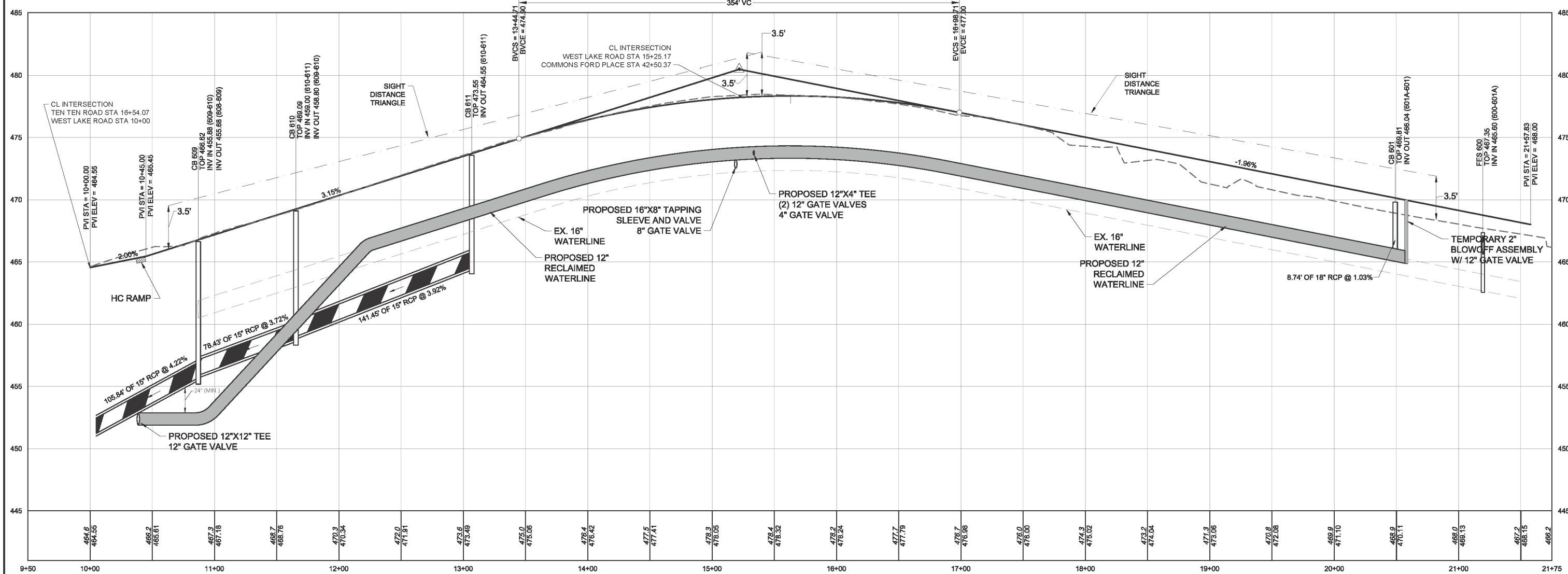

WEST LAKE ROAD - PUBLIC 60' RW - PROFILE VIEW

THIS DRAWING PREPARED AT THE
RALEIGH OFFICE
 5410 Trinity Road, Suite 02 | Raleigh, NC 27607
 TEL 919.866.9551 FAX 919.833.8124 www.timmons.com

YOUR VISION ACHIEVED THROUGH OURS.

DATE	REVISION DESCRIPTION
08-23-2016	REVISED PER TOC REVIEW COMMENTS
10-27-2016	REVISED PER TOC REVIEW COMMENTS
02-21-2017	REVISED PER TOC REVIEW COMMENTS
03-23-2017	REVISED PER TOC REVIEW COMMENTS

DATE	08/25/2016
DRAWN BY	BLM
DESIGNED BY	BLM
CHECKED BY	KMR
SCALE	1" = 40'

TIMMONS GROUP
 NORTH CAROLINA LICENSE NO. C-1652
 FAIRVIEW PARK
 TOWN OF CARY - WAKE COUNTY - NORTH CAROLINA
 WESTLAKE ROAD WIDENING PLAN AND PROFILE

JOB NO.	35556
SHEET NO.	C8.1



Approved by the Town of Cary
 Development Review Committee
 Case Number: 16-SB-002
 HTE #: 16-0791
 Date: 5/05/2017

Lindsay Darden
 Lindsay Darden, Planner II

These plans and associated documents are the exclusive property of TIMMONS GROUP and may not be reproduced in whole or in part and any such use, without the express written consent of TIMMONS GROUP, for any purpose whatsoever, including, but not limited to construction, bidding, and/or construction staking without the express written consent of TIMMONS GROUP.