



THIS DRAWING PREPARED AT THE  
**RALEIGH OFFICE**  
 5410 Trinity Road, Suite 02 | Raleigh, NC 27607  
 TEL 919.866.9551 FAX 919.833.8124 www.timmons.com

YOUR VISION ACHIEVED THROUGH OURS.

DATE: 08/25/2016  
 DRAWN BY: ATB  
 DESIGNED BY: ATB  
 CHECKED BY: SBT  
 SCALE: ---

**TIMMONS GROUP**  
 NORTH CAROLINA LICENSE NO. C-1652  
**FAIRVIEW PARK**  
 TOWN OF CARY - WAKE COUNTY - NORTH CAROLINA  
**LAWDRAKER ROAD & TEN TEN ROAD WIDENING AND STRIPING**

JOB NO. 35556  
 SHEET NO. C8.5

These plans and associated documents are the exclusive property of TIMMONS GROUP and may not be reproduced in whole or in part and any such use without the express written consent of TIMMONS GROUP.

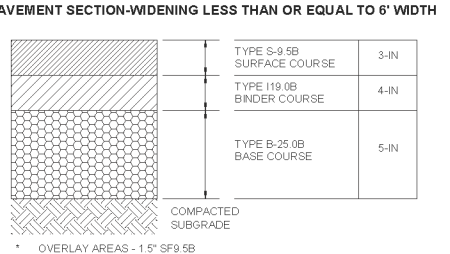
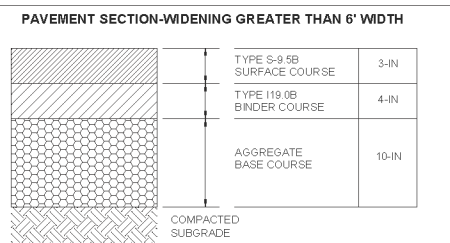
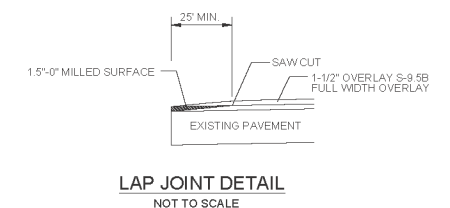

- NOTES:
1. PREPARING, GRADING, SHAPING, AND COMPACTION OF SUBGRADE SOILS SHOULD BE PERFORMED IN ACCORDANCE WITH DIVISION 5, SECTION 501 OF THE NCDOT STANDARD SPECIFICATIONS FOR ROADS AND STRUCTURES (2006). PREPARING, GRADING, SHAPING, AND COMPACTION OF AGGREGATE BASE COURSE (ABC) STONE SHOULD BE PERFORMED IN ACCORDANCE WITH DIVISION 5, SECTION 520 OF THE NCDOT STANDARD SPECIFICATIONS FOR ROADS AND STRUCTURES (2006). PLACEMENT AND COMPACTION OF THE BITUMINOUS CONCRETE SHOULD BE PERFORMED IN ACCORDANCE WITH DIVISION 6, SECTION 600 OF THE NCDOT STANDARD SPECIFICATIONS FOR ROADS AND STRUCTURES (2006). PROPER SUBGRADE COMPACTION, ADHERENCE TO THE NCDOT SPECIFICATIONS, AND COMPLIANCE WITH PROJECT PLANS AND SPECIFICATIONS ARE CRITICAL TO THE PERFORMANCE OF THE CONSTRUCTED PAVEMENT.
  2. THE CONTRACTOR MAY CHOOSE TO INSTALL INTERMEDIATE COURSES OF PAVEMENT TO STABILIZE THE SITE DURING CONSTRUCTION AT NO ADDITIONAL COST. THE CONTRACTOR IS RESPONSIBLE FOR DETERMINING THE ADEQUATE THICKNESS REQUIRED FOR INTERMEDIATE PAVING. INCREASES IN THE DESIGN PAVEMENT SECTION TO FACILITATE INTERMEDIATE PAVING SHALL BE PROVIDED AT NO ADDITIONAL COST.
  3. THE CONTRACTOR SHALL BE RESPONSIBLE FOR REPAIRING ANY DAMAGES TO SUBGRADE, INSTALLED BASE COURSE AND/OR INTERMEDIATE PAVING PRIOR TO PLACING SUBSEQUENT PAVEMENT LIFTS AT NO ADDITIONAL COST.
  4. THE CONTRACTOR SHALL BE RESPONSIBLE FOR PROTECTING PAVEMENT DURING ALL PHASES OF WORK. THE FINAL SURFACE OF PAVEMENT SHALL BE FREE OF ALL DEFECTS OR DAMAGE.

**ASPHALT PAVEMENT SECTION**  
 NOT TO SCALE

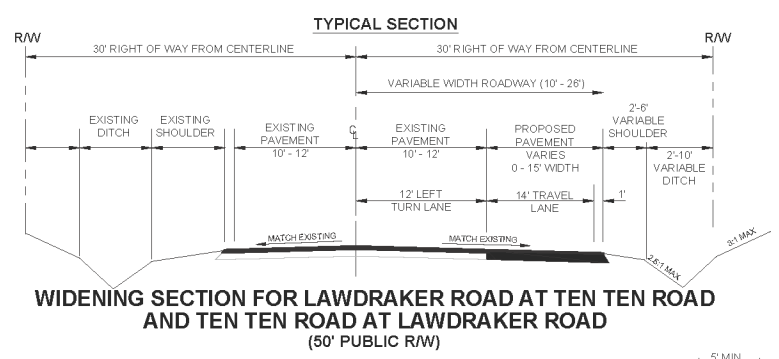
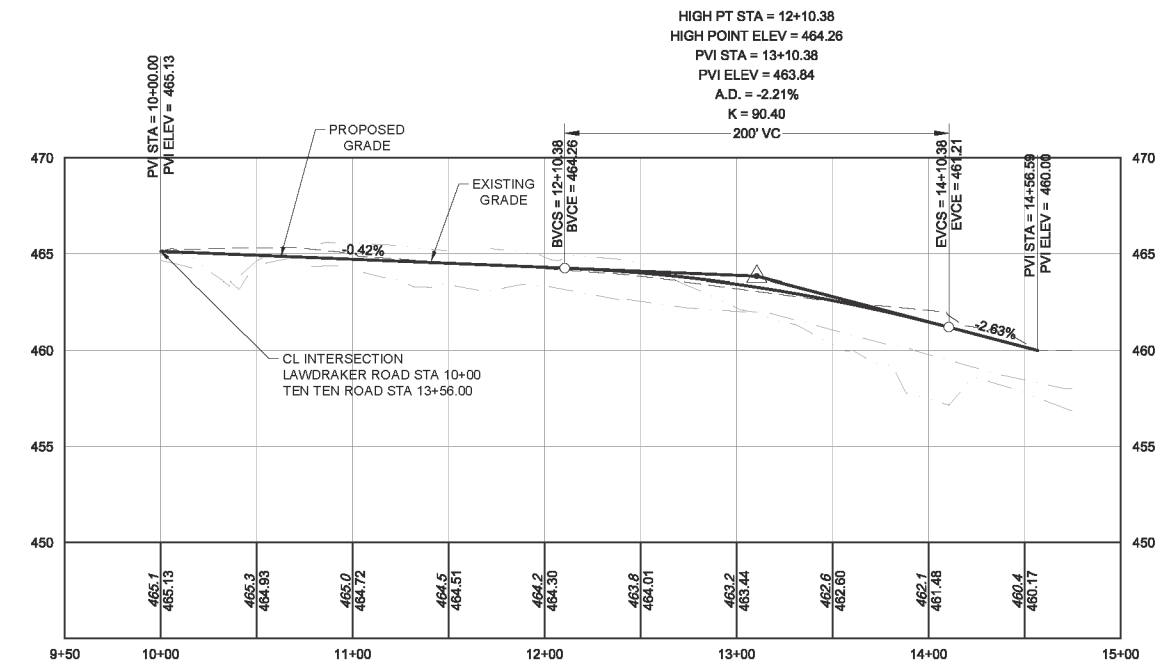
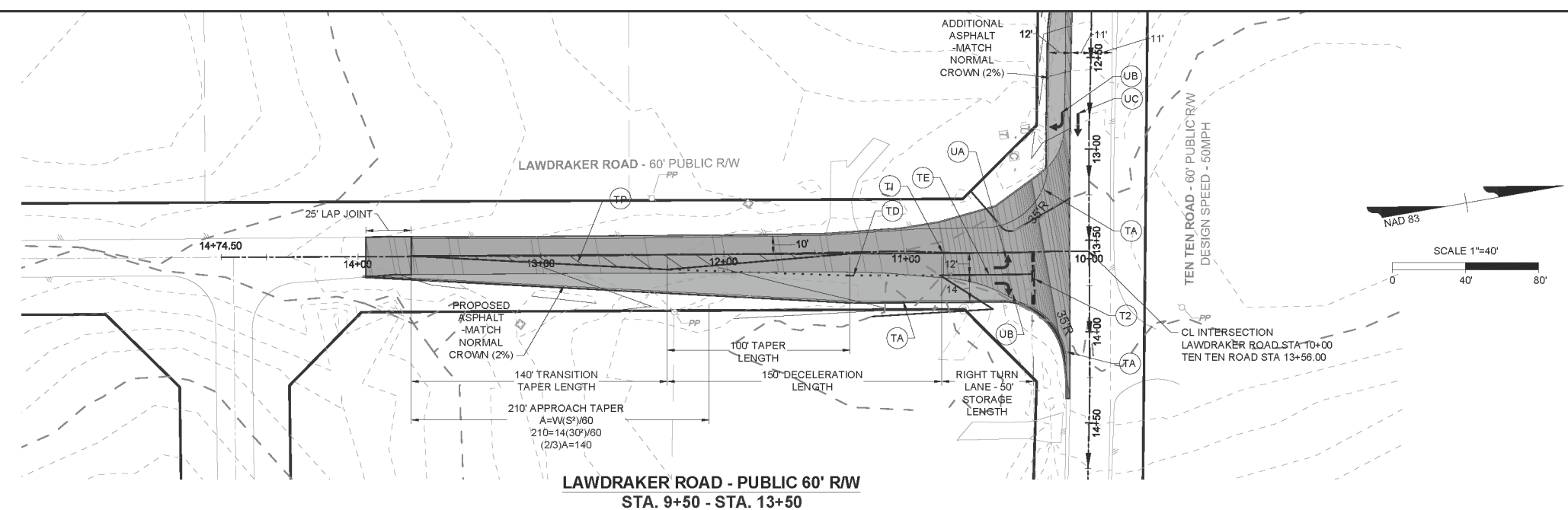

**WIDENING SECTION FOR LAWDRAKER ROAD AT TEN TEN ROAD AND TEN TEN ROAD AT LAWDRAKER ROAD (50' PUBLIC RW)**

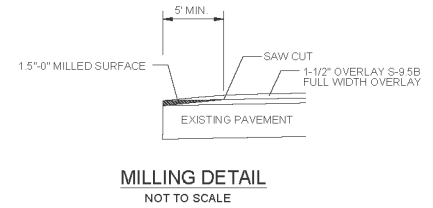

THE CONTRACTOR SHALL PROVIDE AND INSTALL ALL THERMOPLASTIC MARKINGS AND RAISED REFLECTIVE PAVEMENT MARKERS FOR NEWLY CONSTRUCTED TURN LANES TO NCDOT SPECIFICATIONS AND DIMENSIONAL STANDARDS. RAISED PAVEMENT MARKERS TO BE APPROVED AND INSTALLED PER NCDOT STANDARDS.

- PAVEMENT MARKING NOTES**
1. LOCATION OF PAVEMENT MARKINGS SHALL CONFORM TO NCDOT PAVEMENT MARKING STANDARDS. APPLICATION OF PAVEMENT MARKINGS SHALL BE DONE IN ACCORDANCE WITH SECTION 1205 OF THE N.C. DIVISION OF HIGHWAYS STANDARD SPECIFICATIONS FOR ROADS AND STRUCTURES HANDBOOK (2012 EDITION) WITH REVISION(S) THERETO.
  2. ALL EXISTING PAVEMENT MARKINGS SHALL BE ERADICATED PER NCDOT SPECIFICATIONS PRIOR TO PLACEMENT OF MARKING SHOWN HEREIN.
  3. THE CONTRACTOR SHALL BE REQUIRED TO PRE-MARK THE PAVEMENT PRIOR TO ACTUAL APPLICATION OF MARKINGS WITHIN THE NCDOT RIGHT OF WAY. THE CONTRACTOR SHALL SCHEDULE A PRE-MARKING INSPECTION REVIEW WITH THE NCDOT DISTRICT ENGINEER AT LEAST ONE WEEK PRIOR TO MARKING. PAVEMENT MARKINGS SHALL NOT BE INSTALLED UNTIL AFTER FIELD REVIEW AND APPROVAL BY THE NCDOT DISTRICT ENGINEER.
  4. PAVEMENT MARKINGS SHALL MATCH TO AND ALIGN WITH EXISTING CONDITIONS AND MARKINGS. THE CONTRACTOR SHALL PROVIDE THERMOPLASTIC MARKINGS ON ROADWAYS.
  5. INSTALLATION OF PAVEMENT MARKINGS AND RAISED REFLECTIVE PAVEMENT MARKERS FOR NEWLY CONSTRUCTED TURN LANES SHALL BE THE RESPONSIBILITY OF THE CONTRACTOR.
  6. ALL PAVEMENT MARKINGS WITHIN NCDOT RIGHT-OF-WAY SHALL BE LONG LIFE THERMOPLASTIC.
  7. CONTACT NCDOT TRAFFIC SERVICES FOR PAVEMENT MARKING LAYOUT.

**PAVEMENT MARKING LEGEND**  
 THERMOPLASTIC

(T2)	WHITE STOP BAR (24", 120 MIL)
(T3)	WHITE CROSSWALK LINE (24", 120 MIL)
(T8)	2 FT. - 6 FT. /SP WHITE MINISKIP (4", 120 MIL)
(TA)	WHITE EDGELINE (4", 90 MIL)
(TD)	3 FT. - 9 FT. /SP WHITE MINISKIP (4", 120 MIL)
(TE)	WHITE SOLID LANE LINE (4", 120 MIL)
(TI)	YELLOW DOUBLE CENTER (4", 120 MIL)
(TN)	WHITE GORE LINE (8" 90 MIL)
(TO)	WHITE DIAGONAL (8", 90 MIL)
(TP)	YELLOW DIAGONAL (8", 90 MIL)
(UA)	LEFT TURN ARROW (90 MIL)
(UB)	RIGHT TURN ARROW (90 MIL)
(UC)	STRAIGHT ARROW (90 MIL)
(UE)	COMBO, RIGHT/STRAIGHT ARROW (90 MIL)

**LEGEND**

---	4" SINGLE SOLID WHITE LINE
- - -	4" WHITE SINGLE DASHED LINE MINI-SKIP
▨	PROPOSED ASPHALT WIDENING
▩	PROPOSED ASPHALT OVERLAY



Approved by the Town of Cary  
 Development Review Committee  
 Case Number: 16-58-002  
 ITE #: 16-0791  
 Date: 5/05/2017

*Lindsay Darden*  
 Lindsay Darden, Planner II

