



THIS DRAWING PREPARED AT THE
RALEIGH OFFICE
 5410 Trinity Road, Suite 02 | Raleigh, NC 27607
 TEL 919.866.9551 FAX 919.833.8124 www.timmons.com

YOUR VISION ACHIEVED THROUGH OURS.

DATE
 08/25/2016

DRAWN BY

DESIGNED BY

CHECKED BY

SCALE

REVISION DESCRIPTION
 DATE
 REVISED PER TOC REVIEW COMMENTS
 08-25-2016
 REVISED PER TOC REVIEW COMMENTS
 10-27-2016
 REVISED PER TOC REVIEW COMMENTS
 02-21-2017
 REVISED PER TOC REVIEW COMMENTS
 03-23-2017

TIMMONS GROUP

FAIRVIEW PARK
 TOWN OF CARY - WAKE COUNTY - NORTH CAROLINA
 LAWDRAKER ROAD WIDENING AND STRIPING
 NORTH CAROLINA LICENSE NO. C-1652

JOB NO.
35556

SHEET NO.
C8.7

These plans and associated documents are the exclusive property of TIMMONS GROUP and may not be reproduced in whole or in part and shall not be used for any purpose whatsoever, inclusive, but not limited to construction, bidding, and/or construction staking without the express written consent of TIMMONS GROUP.

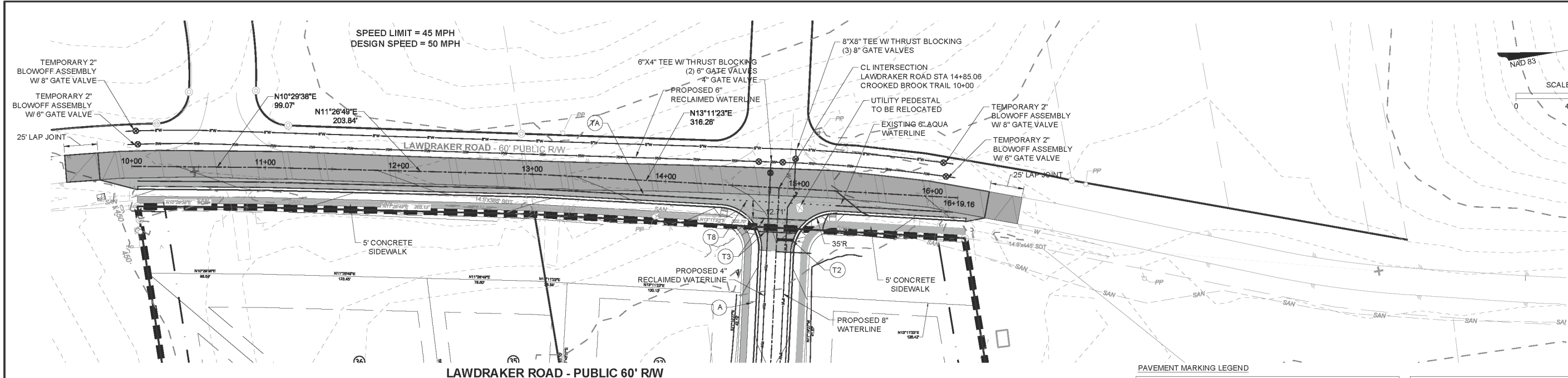

LAWDRAKER ROAD - PUBLIC 60' RW

PAVEMENT MARKING LEGEND

THERMOPLASTIC	
(T2)	WHITE STOP BAR (24", 120 MIL)
(T3)	WHITE CROSSWALK LINE (24", 120 MIL)
(T8)	2 FT. - 6 FT./SP WHITE MINISKIP (4", 120 MIL)
(TA)	WHITE EDGELINE (4", 90 MIL)
(TD)	3 FT. - 9 FT./SP WHITE MINISKIP (4", 120 MIL)
(TE)	WHITE SOLID LANE LINE (4", 120 MIL)
(TI)	YELLOW DOUBLE CENTER (4", 120 MIL)
(TN)	WHITE GORE LINE (8" 90 MIL)
(TO)	WHITE DIAGONAL (8", 90 MIL)
(TP)	YELLOW DIAGONAL (8", 90 MIL)
(UA)	LEFT TURN ARROW (90 MIL)
(UB)	RIGHT TURN ARROW (90 MIL)
(UC)	STRAIGHT ARROW (90 MIL)
(UE)	COMBO, RIGHT/STRAIGHT ARROW (90 MIL)

PAVEMENT SECTION-WIDENING GREATER THAN 6' WIDTH

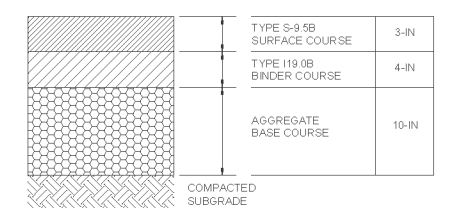

PAVEMENT SECTION-WIDENING LESS THAN OR EQUAL TO 6' WIDTH

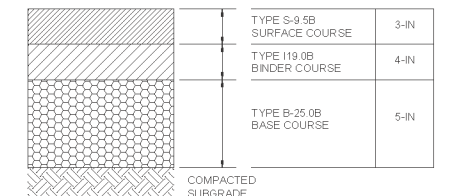

NOTES:
 1. PREPARING, GRADING, SHAPING, AND COMPACTION OF SUBGRADE SOILS SHOULD BE PERFORMED IN ACCORDANCE WITH DIVISION 5, SECTION 501 OF THE NCDOT STANDARD SPECIFICATIONS FOR ROADS AND STRUCTURES (2006). PREPARING, GRADING, SHAPING, AND COMPACTION OF AGGREGATE BASE COURSE (ABC) STONE SHOULD BE PERFORMED IN ACCORDANCE WITH DIVISION 5, SECTION 520 OF THE NCDOT STANDARD SPECIFICATIONS FOR ROADS AND STRUCTURES (2006). PLACEMENT AND COMPACTION OF THE BITUMINOUS CONCRETE SHOULD BE PERFORMED IN ACCORDANCE WITH DIVISION 6, SECTION 600 OF THE NCDOT STANDARD SPECIFICATIONS FOR ROADS AND STRUCTURES (2006). PROPER SUBGRADE COMPACTION, ADHERENCE TO THE NCDOT SPECIFICATIONS, AND COMPLIANCE WITH PROJECT PLANS AND SPECIFICATIONS ARE CRITICAL TO THE PERFORMANCE OF THE CONSTRUCTED PAVEMENT.
 2. THE CONTRACTOR MAY CHOOSE TO INSTALL INTERMEDIATE COURSES OF PAVEMENT TO STABILIZE THE SITE DURING CONSTRUCTION AT NO ADDITIONAL COST. THE CONTRACTOR IS RESPONSIBLE FOR DETERMINING THE ADEQUATE THICKNESS REQUIRED FOR INTERMEDIATE PAVING. INCREASES IN THE DESIGN PAVEMENT SECTION TO FACILITATE INTERMEDIATE PAVING SHALL BE PROVIDED AT NO ADDITIONAL COST.
 3. THE CONTRACTOR SHALL BE RESPONSIBLE FOR REPAIRING ANY DAMAGES TO SUBGRADE, INSTALLED BASE COURSE AND/OR INTERMEDIATE PAVING PRIOR TO PLACING SUBSEQUENT PAVING LIFTS AT NO ADDITIONAL COST.
 4. THE CONTRACTOR SHALL BE RESPONSIBLE FOR PROTECTING PAVEMENT DURING ALL PHASES OF WORK. THE FINAL SURFACE OF PAVEMENT SHALL BE FREE OF ALL DEFECTS OR DAMAGE.

ASPHALT PAVEMENT SECTION
 NOT TO SCALE

LEGEND

---	4" SINGLE SOLID WHITE LINE
- - -	4" WHITE SINGLE DASHED LINE MINI-SKIP
▨	PROPOSED ASPHALT WIDENING
▩	PROPOSED ASPHALT OVERLAY



Approved by the Town of Cary
 Development Review Committee
 Case Number: 16-58-002
 HTE #: 16-0791
 Date: 5/05/2017

Lindsay Darden
 Lindsay Darden, Planner II

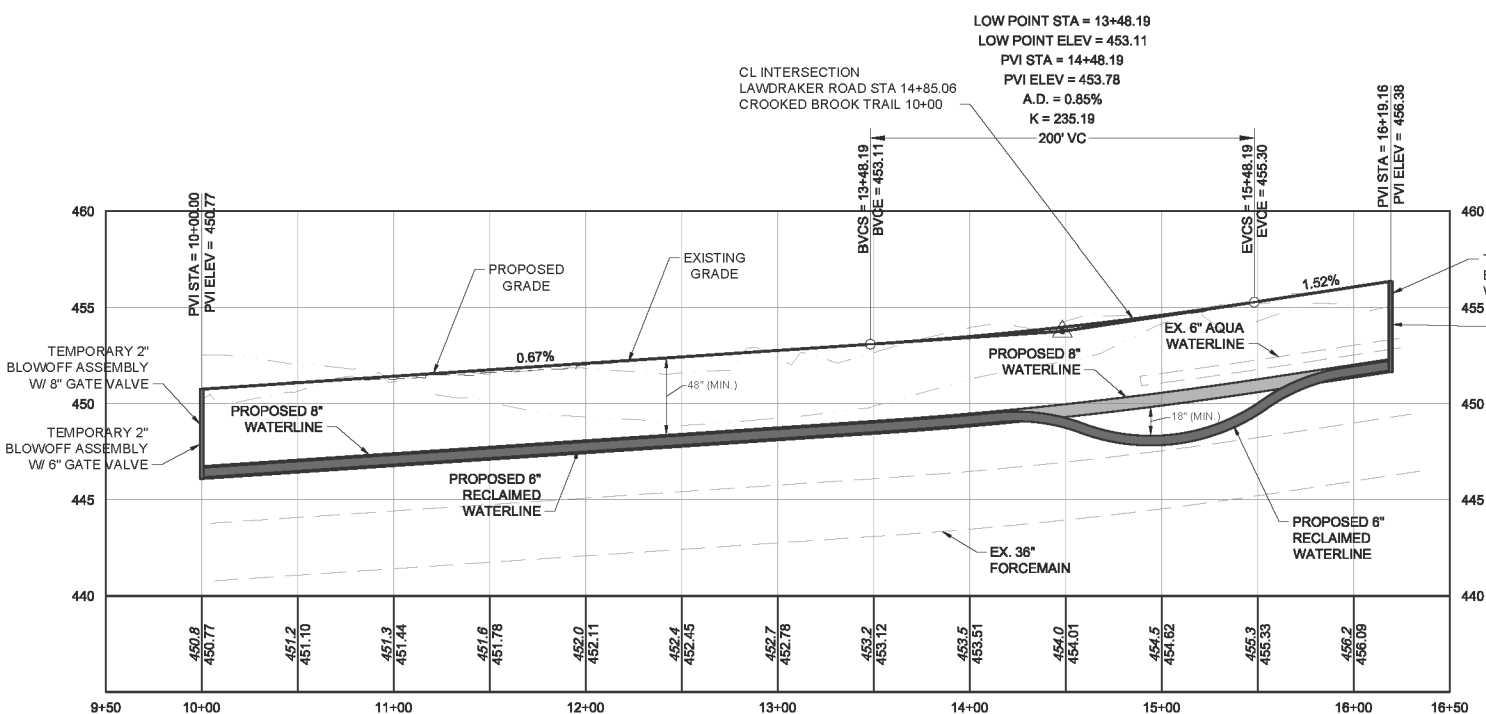

TYPICAL SECTION

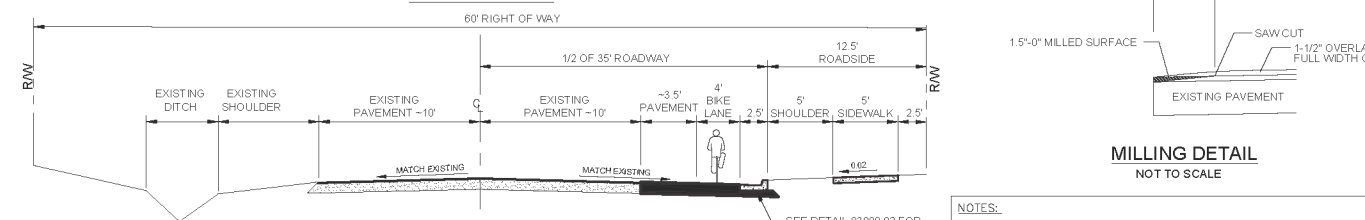

WIDENING SECTION FOR LAWDRAKER ROAD
 (60' PUBLIC RW - 35' B-B)

- NOTES:
1. NORMAL CROWN OF 0.02' PER FOOT UNLESS OTHERWISE DIRECTED BY DIRECTOR OF ENGINEERING.
 2. PAVEMENT DESIGN SHALL BE ASH SHOWN OR AS CALCULATED ACCORDING TO SPECIFICATIONS, WHICHEVER IS GREATER.
 3. REVIEW QUALIFYING CRITERIA AND CROSS SECTIONS FOR "COLLECTOR STREETS".

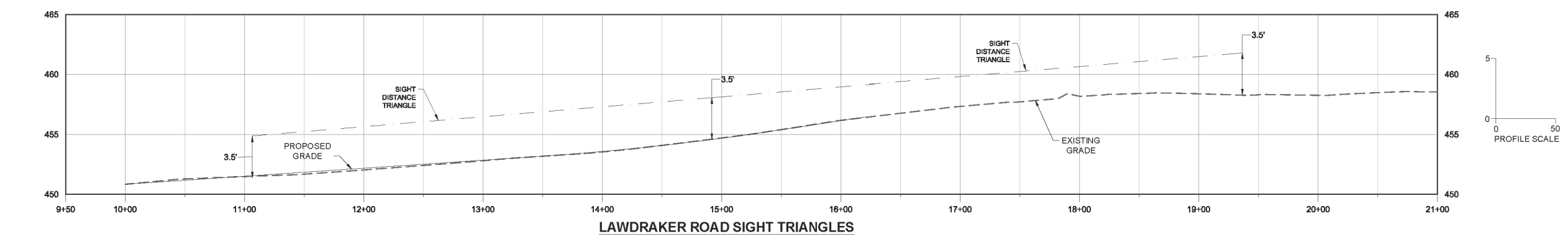

LAWDRAKER ROAD SIGHT TRIANGLES