

- NOTES:**
- PUMP POND DOWN PRIOR TO EXCAVATING FOR ANTI-SEEP COLLAR AND MAINTAIN WATER LEVEL BELOW EXCAVATED AREA UNTIL CONCRETE HAS SET (UP TO 24 HR. MIN.)
 - EXCAVATE TO 3" BELOW EXISTING 30" RCP & BACKFILL WITH 3000 PSI CONCRETE (FULL TRENCH WIDTH) TO A POINT 2" ABOVE PIPE
 - ALLOW CONCRETE TO CURE 24 HRS (MIN.) BEFORE BACKFILLING ABOVE ANTI-SEEP COLLAR. MAINTAIN WATER LEVEL BELOW ANTI-SEEP COLLAR BY PUMPING WATER OUT OF POND DURING CONCRETE CURE.
 - BACKFILL ABOVE ANTI-SEEP COLLAR WITH CH OR CL SOILS. RESEED AND STABILIZE DISTURBED AREAS.

ANTI-SEEP COLLAR
N.T.S.

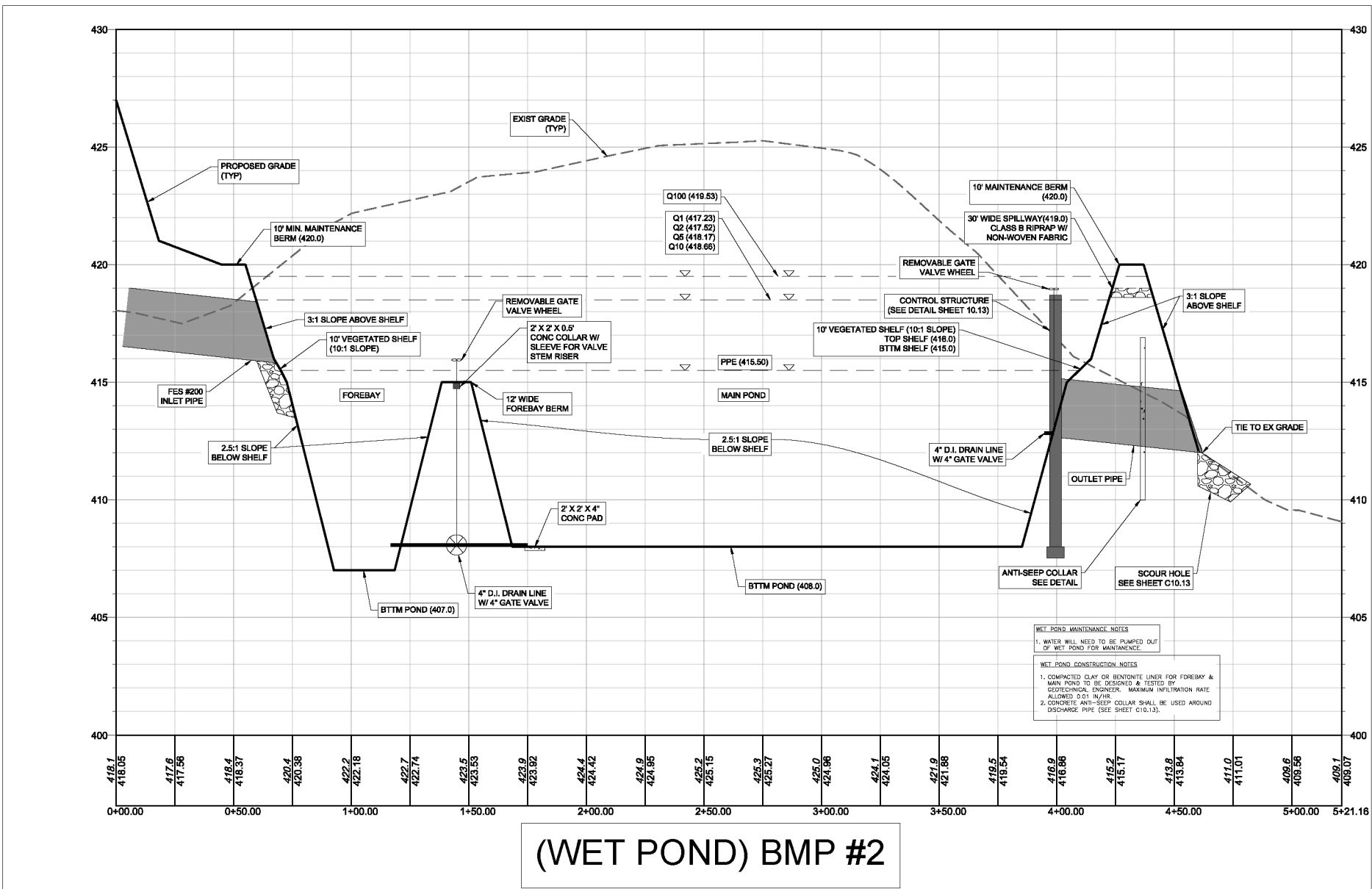
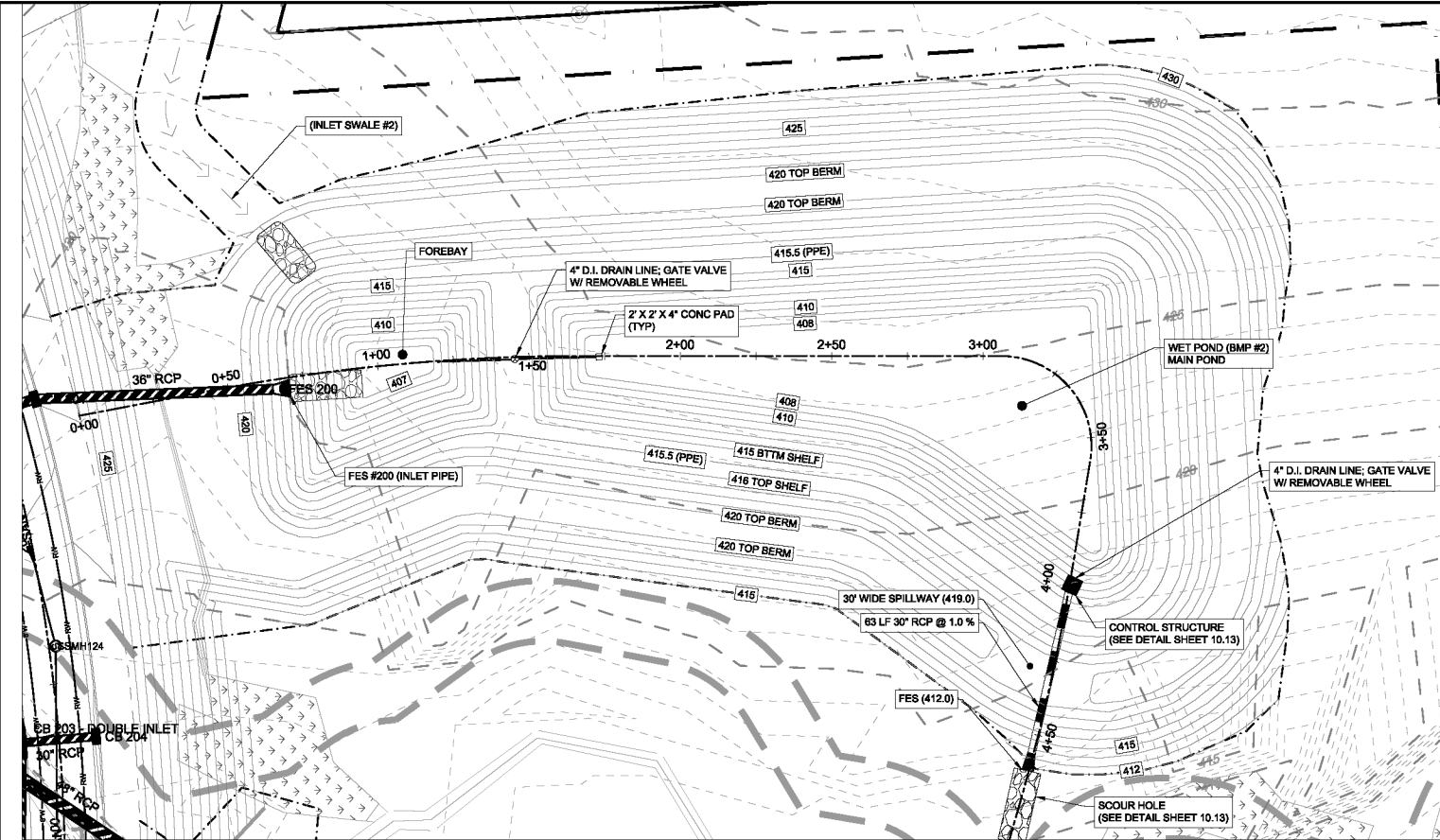

Approved by the Town of Cary
Development Review Committee
Case Number: 16-SB-002
HTE #: 16-0791
Date: 5/05/2017

Lindsay Darden
Lindsay Darden, Planner II

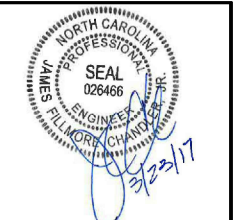

THIS DRAWING PREPARED AT THE
RALEIGH OFFICE
5410 Trinity Road, Suite 02 | Raleigh, NC 27607
TEL 919.866.9551 FAX 919.833.8124 www.timmons.com

YOUR VISION ACHIEVED THROUGH OURS.

| DATE | REVISION DESCRIPTION |
|------------|---------------------------------|
| 08-23-2016 | REVISED PER TOC REVIEW COMMENTS |
| 10-27-2016 | REVISED PER TOC REVIEW COMMENTS |
| 02-21-2017 | REVISED PER TOC REVIEW COMMENTS |
| 03-23-2017 | REVISED PER TOC REVIEW COMMENTS |

| FOR REVIEW | DRAWN BY |
|-------------|------------|
| P. BARBEAU | P. BARBEAU |
| DESIGNED BY | P. BARBEAU |
| CHECKED BY | K. ROBERTS |
| SCALE | AS SHOWN |

TIMMONS GROUP

FAIRVIEW PARK
TOWN OF CARY - WAKE COUNTY - NORTH CAROLINA
NORTH CAROLINA LICENSE NO. C-1652
BMP 2 PLAN AND PROFILE

JOB NO.
35556

SHEET NO.
C10.11

These plans and associated documents are the exclusive property of TIMMONS GROUP and may not be reproduced in whole or in part and will not be used for any purpose whatsoever, inclusive, but not limited to construction, bidding, and/or construction staking without the express written consent of TIMMONS GROUP.