

PHASE I DETAIL-FIGURE 1

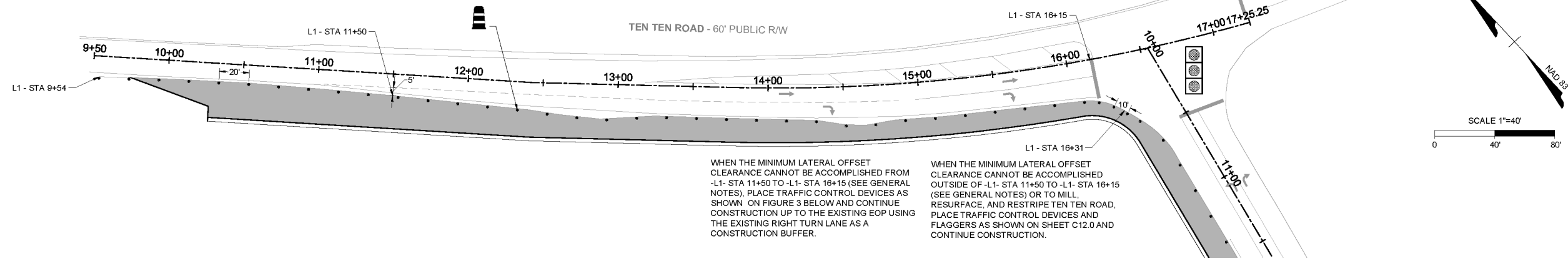

WHEN THE MINIMUM LATERAL OFFSET CLEARANCE CANNOT BE ACCOMPLISHED FROM -L1- STA 11+50 TO -L1- STA 16+15 (SEE GENERAL NOTES), PLACE TRAFFIC CONTROL DEVICES AS SHOWN ON FIGURE 3 BELOW AND CONTINUE CONSTRUCTION UP TO THE EXISTING EOP USING THE EXISTING RIGHT TURN LANE AS A CONSTRUCTION BUFFER.

WHEN THE MINIMUM LATERAL OFFSET CLEARANCE CANNOT BE ACCOMPLISHED OUTSIDE OF -L1- STA 11+50 TO -L1- STA 16+15 (SEE GENERAL NOTES) OR TO MILL, RESURFACE, AND RESTRIPE TEN TEN ROAD, PLACE TRAFFIC CONTROL DEVICES AND FLAGGERS AS SHOWN ON SHEET C12.0 AND CONTINUE CONSTRUCTION.

TEN TEN ROAD - PUBLIC 60' RW

PHASE I DETAIL-FIGURE 2

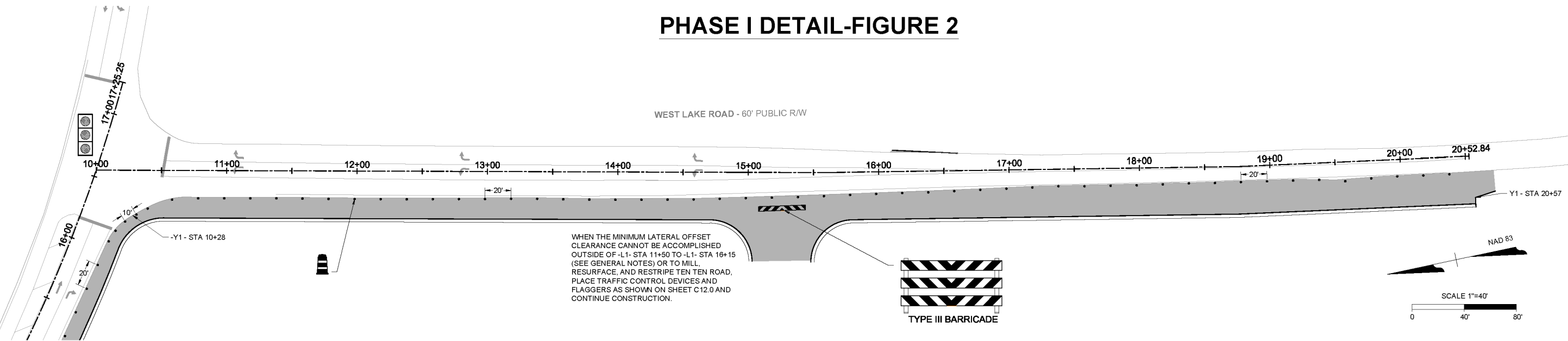

WHEN THE MINIMUM LATERAL OFFSET CLEARANCE CANNOT BE ACCOMPLISHED OUTSIDE OF -L1- STA 11+50 TO -L1- STA 16+15 (SEE GENERAL NOTES) OR TO MILL, RESURFACE, AND RESTRIPE TEN TEN ROAD, PLACE TRAFFIC CONTROL DEVICES AND FLAGGERS AS SHOWN ON SHEET C12.0 AND CONTINUE CONSTRUCTION.

TYPE III BARRICADE

WEST LAKE ROAD - PUBLIC 60' RW

PHASE I DETAIL-FIGURE 3

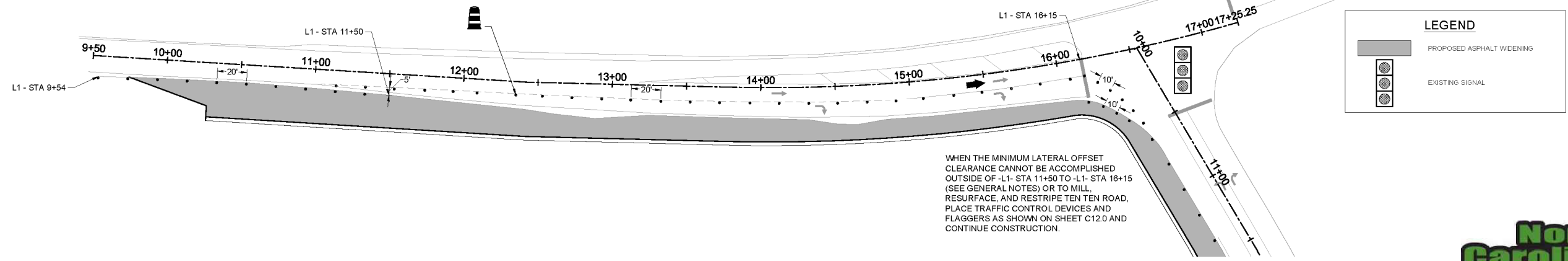

WHEN THE MINIMUM LATERAL OFFSET CLEARANCE CANNOT BE ACCOMPLISHED OUTSIDE OF -L1- STA 11+50 TO -L1- STA 16+15 (SEE GENERAL NOTES) OR TO MILL, RESURFACE, AND RESTRIPE TEN TEN ROAD, PLACE TRAFFIC CONTROL DEVICES AND FLAGGERS AS SHOWN ON SHEET C12.0 AND CONTINUE CONSTRUCTION.

TEN TEN ROAD - PUBLIC 60' RW

LEGEND

- PROPOSED ASPHALT WIDENING
- EXISTING SIGNAL



Approved by the Town of Cary
Development Review Committee
Case Number: 16-58-002
ITE #: 16-0791
Date: 5/05/2017

Lindsay Darden
Lindsay Darden, Planner II

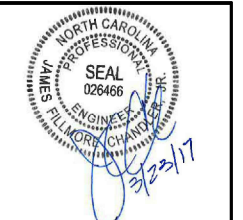

THIS DRAWING PREPARED AT THE
RALEIGH OFFICE
5410 Trinity Road, Suite 02 | Raleigh, NC 27607
TEL 919.866.9551 FAX 919.833.8124 www.timmons.com

YOUR VISION ACHIEVED THROUGH OURS.

DATE	REVISION DESCRIPTION
08-23-2016	REVISED PER TOC REVIEW COMMENTS
09-23-2016	REVISED PER TOC REVIEW COMMENTS
01-12-2017	REVISED PER TOC REVIEW COMMENTS
02-21-2017	REVISED PER TOC REVIEW COMMENTS
03-23-2017	REVISED PER TOC REVIEW COMMENTS

DATE	08/25/16
DRAWN BY	CEL
DESIGNED BY	CEL
CHECKED BY	JPL
SCALE	SEE PLAN

TIMMONS GROUP

FAIRVIEW PARK
TOWN OF CARY - WAKE COUNTY - NORTH CAROLINA
NORTH CAROLINA LICENSE NO. C-1652

TEN TEN ROAD & WESTLAKE ROAD PHASE I TRAFFIC CONTROL PLAN

JOB NO.	35556
SHEET NO.	C11.0

These plans and associated documents are the exclusive property of TIMMONS GROUP and may not be reproduced in whole or in part and may not be used for any purpose whatsoever, inclusive, but not limited to construction, bidding, and/or construction staking without the express written consent of TIMMONS GROUP.