

PHASE II DETAIL

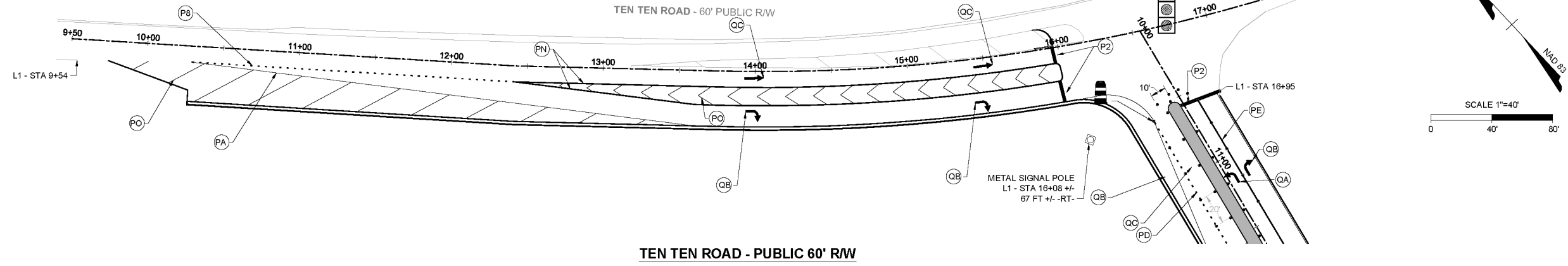

TEN TEN ROAD - PUBLIC 60' R/W

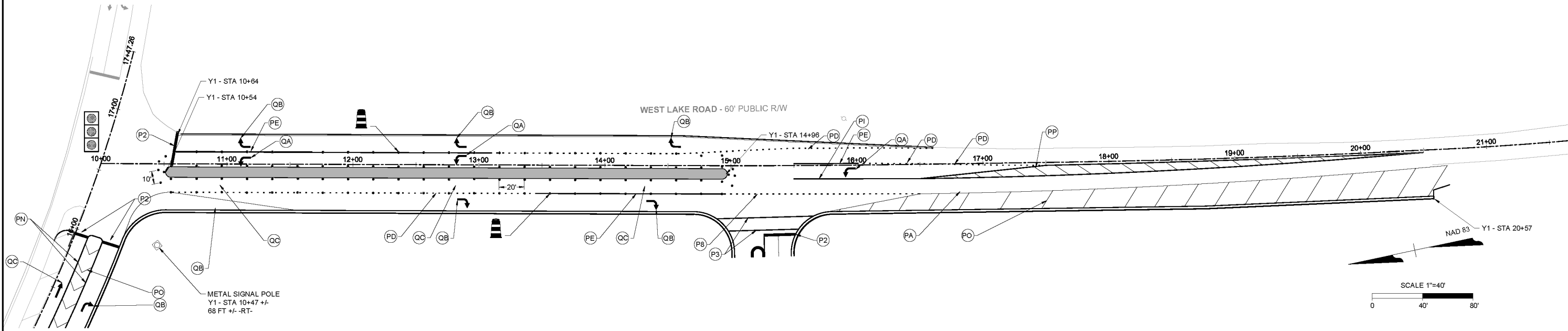

WEST LAKE ROAD - PUBLIC 60' R/W

TEMPORARY PAVEMENT MARKING LEGEND
PAINT

- P2 WHITE STOP BAR (24")
- P3 WHITE CROSSWALK LINE (24")
- P8 2FT. - 6FT./SP WHITE MINISKIP (4")
- PA WHITE EDGELINE (4")
- PD 3 FT. - 9 FT./SP WHITE MINISKIP (4")
- PE WHITE SOLID LANE LINE (4")
- PI YELLOW DOUBLE CENTER (4")
- PN WHITE GORE LINE (8")
- PO WHITE DIAGONAL (8")
- PP YELLOW DIAGONAL (8")
- QA LEFT TURN ARROW
- QB RIGHT TURN ARROW
- QC STRAIGHT ARROW

LEGEND



Approved by the Town of Cary
Development Review Committee
Case Number: 16-SB-002
HTE #: 16-0791
Date: 5/05/2017



Lindsay Darden
Lindsay Darden, Planner II



THIS DRAWING PREPARED AT THE
RALEIGH OFFICE
5410 Trinity Road, Suite 02 | Raleigh, NC 27607
TEL 919.866.9551 FAX 919.833.8124 www.timmons.com

YOUR VISION ACHIEVED THROUGH OURS.

DATE	REVISION DESCRIPTION
08-23-2016	REVISED PER TOC REVIEW COMMENTS
09-23-2016	REVISED PER TOC REVIEW COMMENTS
01-12-2017	REVISED PER TOC REVIEW COMMENTS
02-21-2017	REVISED PER TOC REVIEW COMMENTS
03-23-2017	REVISED PER TOC REVIEW COMMENTS

DATE
08/25/16

DRAWN BY
CEL

DESIGNED BY
CEL

CHECKED BY
JPH

SCALE
SEE PLAN

TIMMONS GROUP
NORTH CAROLINA LICENSE NO. C-1652

FAIRVIEW PARK
TOWN OF CARY - WAKE COUNTY - NORTH CAROLINA

TEN TEN ROAD & WESTLAKE ROAD PHASE II TRAFFIC CONTROL PLAN

JOB NO.
35556
SHEET NO.
C14.0

These plans and associated documents are the exclusive property of TIMMONS GROUP and may not be reproduced in whole or in part and shall not be used for any purpose whatsoever, inclusive, but not limited to construction, bidding, and/or construction staking without the express written consent of TIMMONS GROUP.