

INSET A

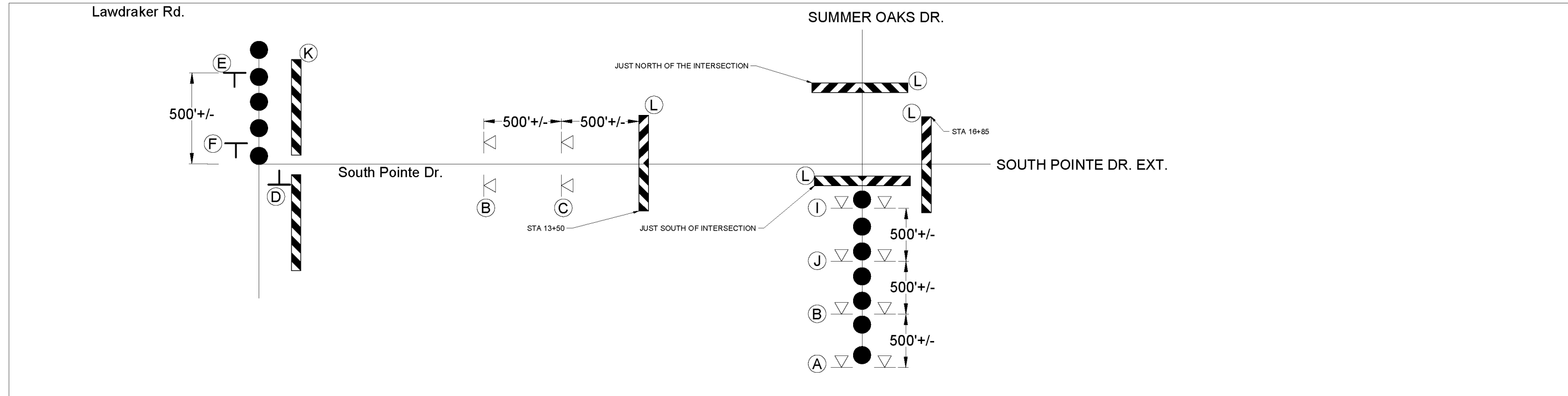

INSET B

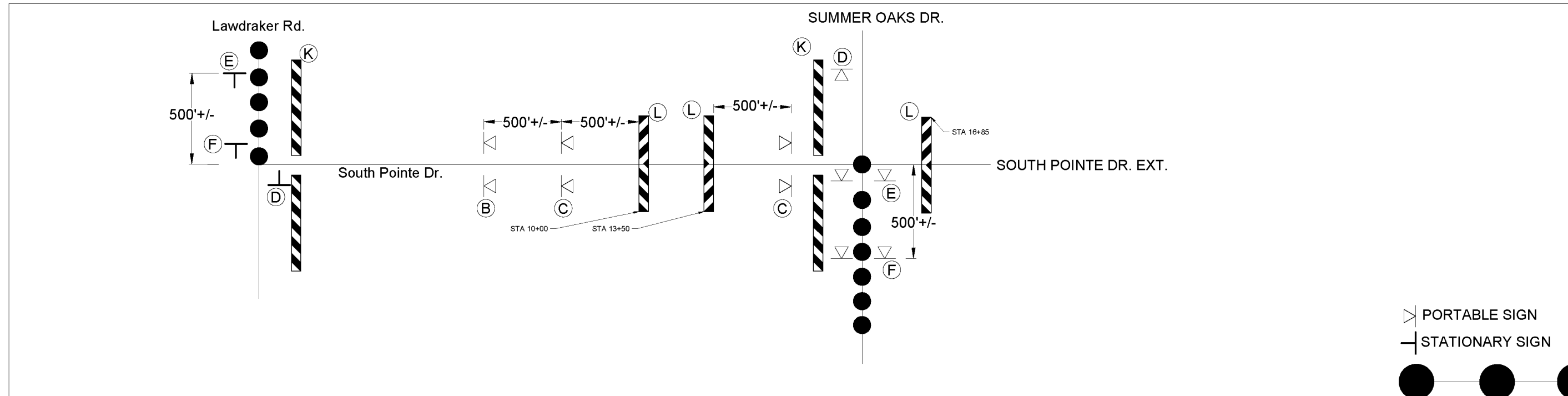

▽ PORTABLE SIGN
 ┆ STATIONARY SIGN



(SEE C18.0 FOR SIGN LEGEND)



Approved by the Town of Cary
 Development Review Committee
 Case Number: 16-58-002
 HTE #: 16-0791
 Date: 5/05/2017
 Lindsay Darden, Planner II

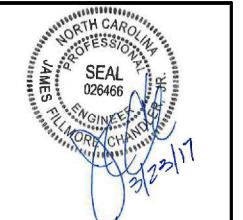

THIS DRAWING PREPARED AT THE
RALEIGH OFFICE
 5410 Trinity Road, Suite 02 | Raleigh, NC 27607
 TEL 919.866.9551 FAX 919.833.8124 www.timmons.com

YOUR VISION ACHIEVED THROUGH OURS.

DATE	REVISION DESCRIPTION
08-25-2016	REVISED PER TOC REVIEW COMMENTS
09-12-2016	REVISED PER TOC REVIEW COMMENTS
01-12-2017	REVISED PER TOC REVIEW COMMENTS
02-21-2017	REVISED PER TOC REVIEW COMMENTS
03-23-2017	REVISED PER TOC REVIEW COMMENTS

DATE	08/25/16
DRAWN BY	CEL
DESIGNED BY	CEL
CHECKED BY	JPH
SCALE	SEE PLAN

TIMMONS GROUP
 NORTH CAROLINA LICENSE NO. C-1652

FAIRVIEW PARK
 TOWN OF CARY - WAKE COUNTY - NORTH CAROLINA
SOUTH POINTE DRIVE ROAD CLOSURE

JOB NO. 35556
 SHEET NO. C19.0

These plans and associated documents are the exclusive property of TIMMONS GROUP and may not be reproduced in whole or in part and shall not be used for any purpose whatsoever, inclusive, but not limited to construction, bidding, and/or construction staking without the express written consent of TIMMONS GROUP.