

BUILDING TYPE II CBBC	
FIRST FLOOR	
LIVING	9,140 SQ. FT.
BREEZEWAYS	1,438 SQ. FT.
SUBTOTAL	10,578 SQ. FT.
SECOND FLOOR	
LIVING	9,140 SQ. FT.
BREEZEWAYS	1,544 SQ. FT.
SUBTOTAL	10,684 SQ. FT.
THIRD FLOOR	
LIVING	1,808 SQ. FT.
BREEZEWAYS	1,544 SQ. FT.
SUBTOTAL	3,352 SQ. FT.
BUILDING TOTAL	23,614 SQ. FT.

X-AREA

SELECTIVE CONDOC NOTES

GENERAL NOTES

- CONFIRM ALL FINISH GRADE AND FINISH FLOOR ELEVATIONS WITH APPROVED SITE ENGINEERING.
- CONFIRM PORCH AND STEP REQUIREMENTS WITH APPROVED CIVIL ENGINEERING. PROVIDE CONTINUOUS VENTED SOFFIT AT ALL OVERHANGS.
- INTERIOR AND EXTERIOR LOAD BEARING PARTITIONS AT GROUND FLOOR UNITS TO BE 3x4 STUDS AT 16" O.C. IN 3 STORY PORTIONS OF BUILDING PER CODE.
- REFER TO SITE WORK DRAWINGS FOR SIDEWALK LOCATIONS.
- VERIFY LOCATION OF FIRE RISER EQUIPMENT ACCESS PANEL WITH FIRE PROTECTION SYSTEMS ENGINEERS AND PLUMBERS.
- PROVIDE LOCATION AND INSPECTOR TEST VALVE ACCESS PANEL AS REQUIRED.
- SEE STRUCTURAL DRAWINGS FOR SLOPED FLOOR SLAB ELEVATIONS, TYPICAL ALL 1ST FLOOR BREEZEWAYS.
- PROVIDE 22"x36" ATTIC ACCESS AT TOP FLOOR UNITS ONLY.

X-NOTE A2

WALL LEGEND

- 3-1/2" STUDS W/ 1 LAYER OF 5/8" TYPE "X" GYP. BOARD ON EACH SIDE OF TENANT SEPARATION WALL. FILL WITH 3-1/2" MIN. BATT INSULATION BOTH SIDES.
- EXTERIOR WALL W/ 1 LAYER OF 5/8" TYPE "X" GYP. BOARD ON INTERIOR FACE.
- INTERIOR BEARING WALL W/ 1 LAYER OF 5/8" TYPE "X" GYP. BOARD ON EACH SIDE OF STUD WALL.
- 3-1/2" STUD W/ 1/2" GYPSUM BOARD BOTH SIDES AT INTERIOR WALLS.
- ATTIC DRAFTSTOPPING, 1 LAYER OF 1/2" GIB OR OSB ON ONE SIDE OF ROOF TRUSS.

X-ULLEG

01-50-012
APPROVED
 TOWN OF CARY
 Approved By: *DRC* Date: 5-22-02
 Planning: *DP* Date: 10-13-02
 Engineering: *TS* Date: 12-12-02

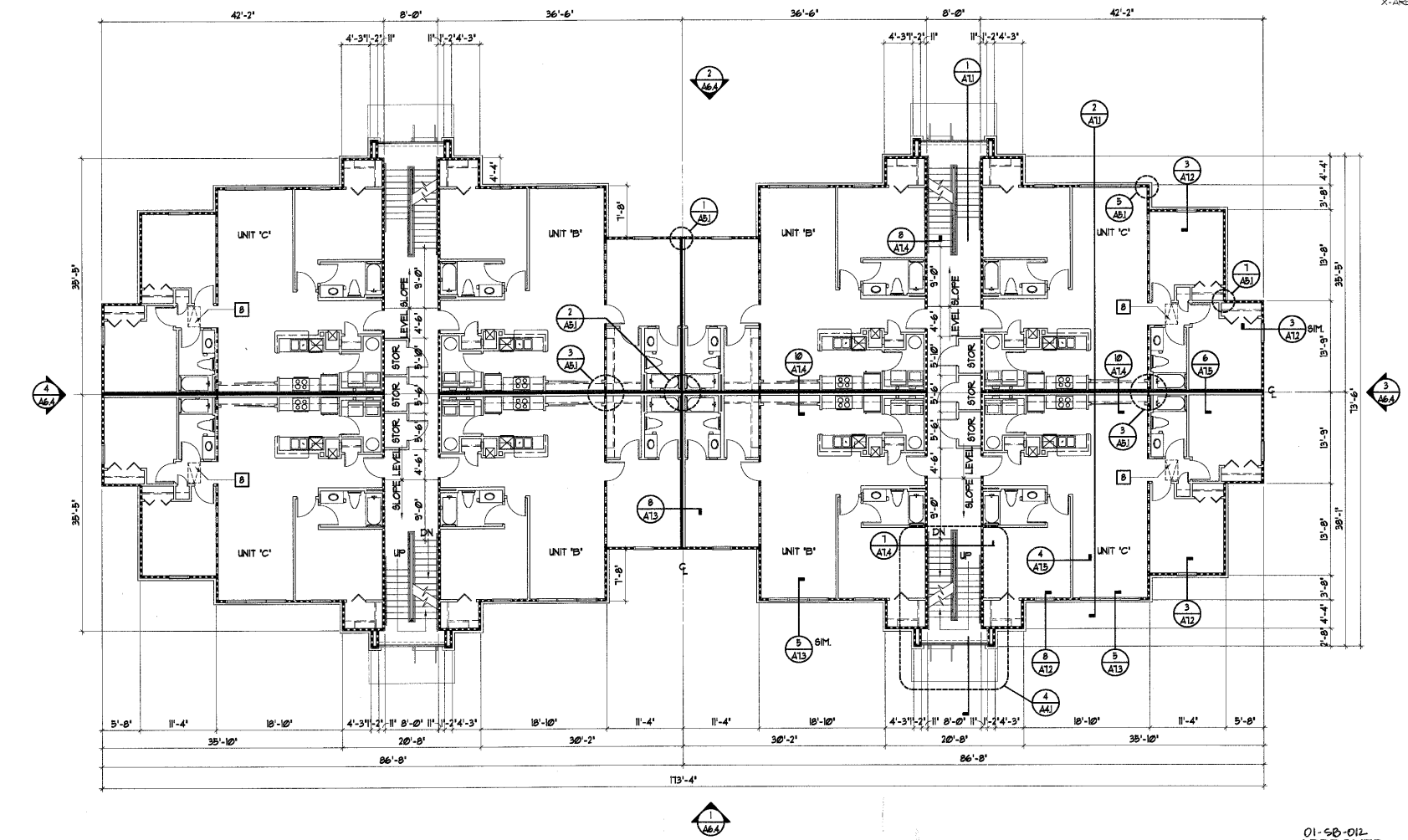

BUILDING TYPE II - SECOND FLOOR PLAN
 SCALE: 1/8" = 1'-0"

REVISIONS	PERMIT SET	BY
	3-26-02	

SLOCUM PLATTS
 ARCHITECTS DESIGN STUDIO, P.A.
 RANDALL J. SLOCUM AR 13350 WILLIAM P. PLATTS AR 13762
 3000 SOUTHWOOD DRIVE
 WINTER PARK, FLORIDA 32789
 TEL. (407)845-3019 FAX (407)845-2771

RANDALL J. SLOCUM
 NORTH CAROLINA

BLDG. TYPE II - 2ND FLOOR PLAN - CBBC (BLDG 1+2)
THE GROVES AT CARY PARK
APARTMENTS
 CARY
 NORTH CAROLINA

DATE	BY
3-26-02	

A2.14