

BUILDING TYPE II CBBC		
FIRST FLOOR		
LIVING	9,140	SQ. FT.
BREEZEWAYS	1,438	SQ. FT.
SUBTOTAL	10,578	SQ. FT.
SECOND FLOOR		
LIVING	9,140	SQ. FT.
BREEZEWAYS	1,184	SQ. FT.
SUBTOTAL	10,324	SQ. FT.
THIRD FLOOR		
LIVING	15,888	SQ. FT.
BREEZEWAYS	1,184	SQ. FT.
SUBTOTAL	17,072	SQ. FT.
BUILDING TOTAL	29,614	SQ. FT.

SELECTIVE CONDOC NOTES

GENERAL NOTES

- CONFIRM ALL FINISH GRADE AND FINISH FLOOR ELEVATIONS WITH APPROVED SITE ENGINEERING.
- CONFIRM PORCH AND STEP REQUIREMENTS WITH APPROVED CIVIL ENGINEERING. PROVIDE CONTINUOUS VENTED SOFFIT AT ALL OVERHANGS.
- INTERIOR AND EXTERIOR LOAD BEARING PARTITIONS AT GROUND FLOOR UNITS TO BE 3/4 STUDS AT 16" O.C. IN 3 STORY PORTIONS OF BUILDING PER CODE.
- REFER TO SITE WORK DRAWINGS FOR SIDEWALK LOCATIONS.
- VERIFY LOCATION OF FIRE RISER EQUIPMENT ACCESS PANEL WITH FIRE PROTECTION SYSTEMS ENGINEERS AND PLUMBING.
- PROVIDE LOCATION AND INSPECTOR TEST VALVE ACCESS PANEL AS REQUIRED.
- SEE STRUCTURAL DRAWINGS FOR SLOPED FLOOR SLAB ELEVATIONS, TYPICAL ALL 1ST FLOOR BREEZEWAYS.
- PROVIDE 22"x36" ATTIC ACCESS AT TOP FLOOR UNITS ONLY.

WALL LEGEND

- 3-1/2" STUDS w/ 1 LAYER OF 5/8" TYPE "X" GYP. BOARD ON EACH SIDE OF TENANT SEPARATION WALL. FILL WITH 3-1/2" MIN. BATT INSULATION BOTH SIDES.
- EXTERIOR WALL w/ 1 LAYER OF 5/8" TYPE "X" GYP. BOARD ON INTERIOR FACE.
- INTERIOR BEARING WALL w/ 1 LAYER OF 5/8" TYPE "X" GYP. BOARD ON EACH SIDE OF STUD WALL.
- 3-1/2" STUD WITH 1/2" GYPSUM BOARD BOTH SIDES AT INTERIOR WALLS.
- ATTIC DRAFTSTOPPING, 1 LAYER OF 1/2" GIB OR OSB ON ONE SIDE OF ROOF TRUSS.

01-50-012-
APPROVED
 TOWN OF CARY
 Approved By: DRL Date: 6-22-02
 Planning: ELP Date: 6-19-02
 Engineering: TS Date: 6-12-02

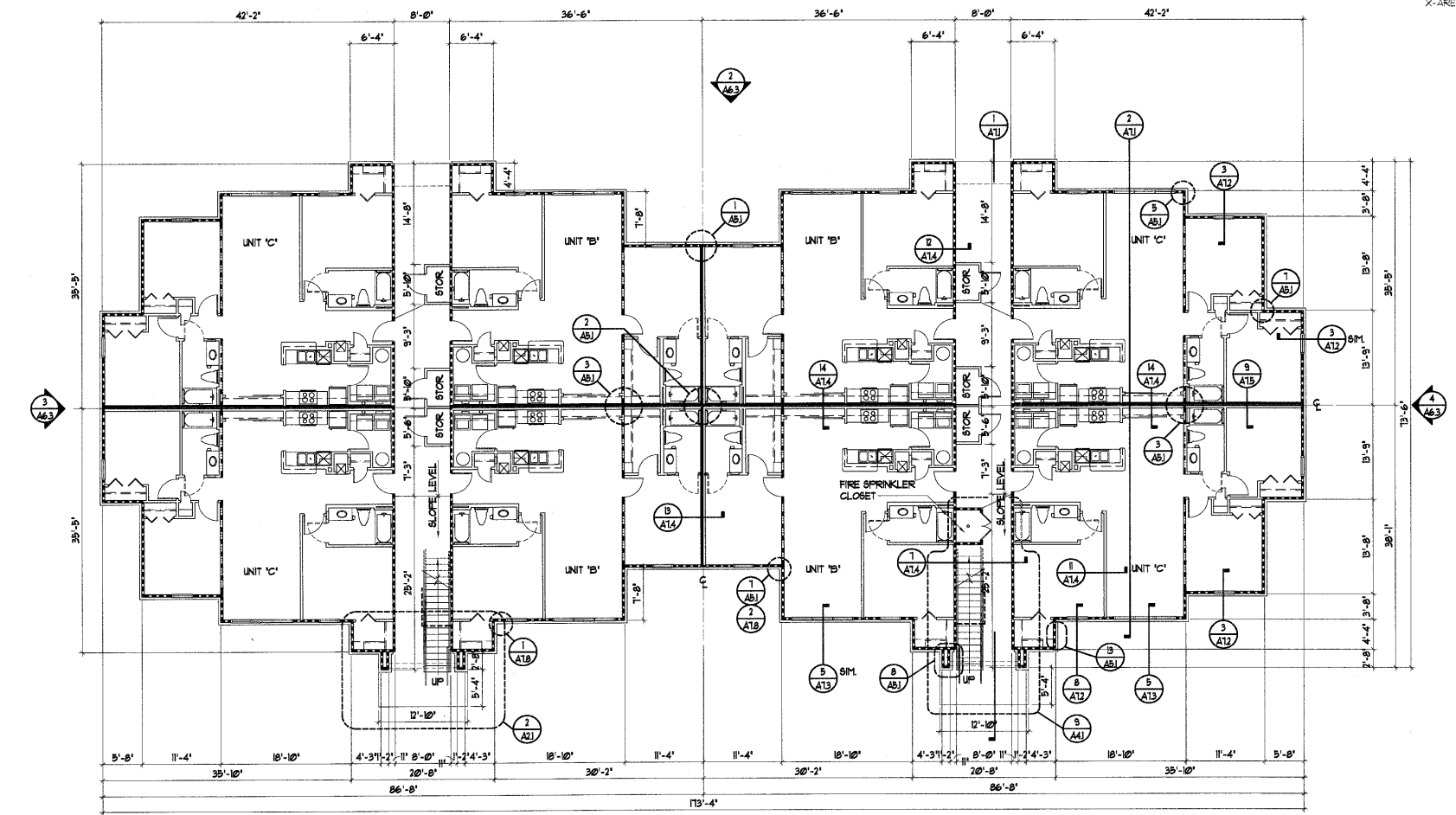

BUILDING TYPE II - FIRST FLOOR PLAN
 SCALE: 1/8" = 1'-0"

REVISIONS	BY
3-26-02	

SLOCUM • PLATTS
ARCHITECTS DESIGN STUDIO, P.A.
 RANDALL U. SLOCUM JR., 13358 WILLIAM P. PLATTS AVE., 13262
 300 SOUTH PARK AVE., SUITE 200
 WINTER PARK, FLORIDA 32789
 TEL. (407)845-3019 FAX (407)845-2771

BLDG. TYPE II - 1ST FLOOR PLAN - CBBC (BLDG. 3)
THE GROVES AT CARY PARK
APARTMENTS

NORTH CAROLINA

CARY

DRAWN: RFG
 CHECKED: LRP
 DATE: 3-26-02
 SCALE: AS NOTED
 JOB NO: 01-045
 SHEET

A2.9