

POND 1

NOTE:
THE SLOPES FOR BOTH PONDS SHALL BE STABILIZED WITH NORTH AMERICAN GREEN CISS LONG-TERM EROSION CONTROL LINING, AND SEEDED WITH WEEPING LOVE GRASS, RED FESCUE, OR OTHER TOWN OF CARY APPROVED LOW MAINTENANCE VEGETATION.

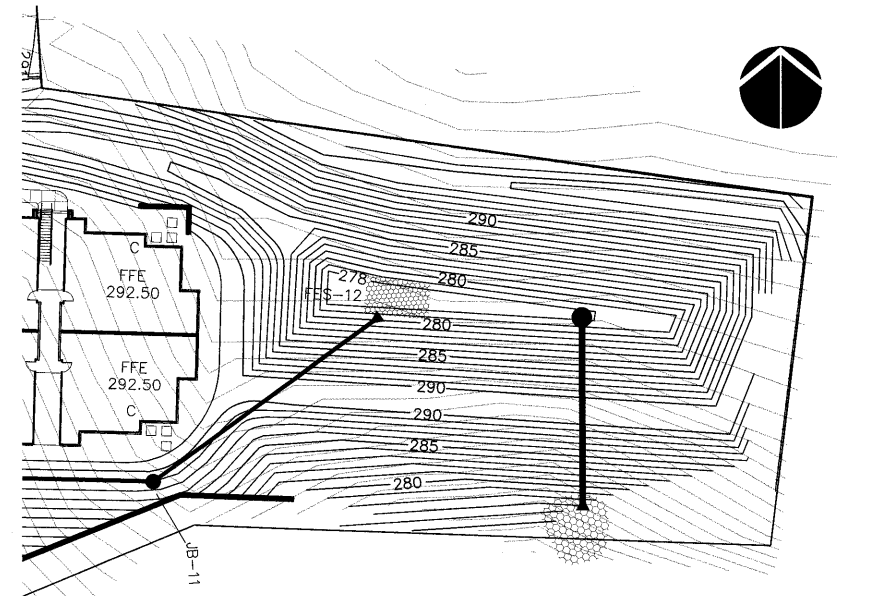

POND 2

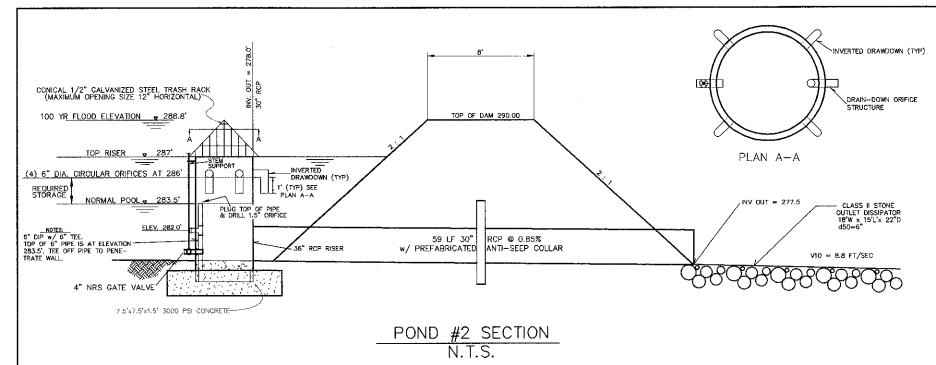
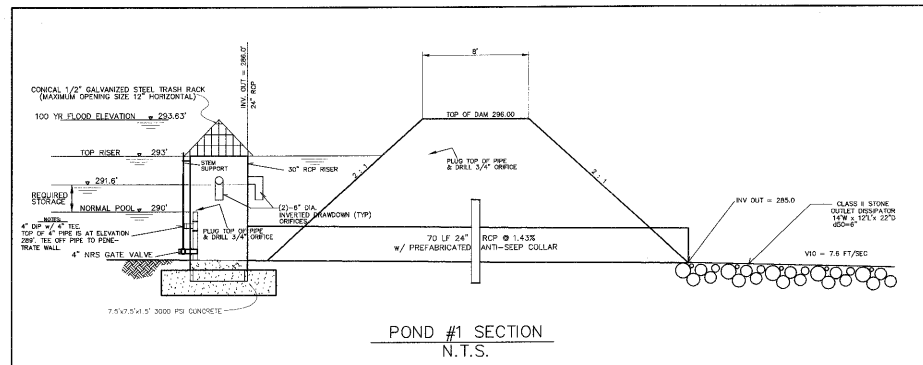

ALL CONSTRUCTION SHALL BE IN ACCORDANCE WITH CURRENT TOWN OF CARY STANDARD SPECIFICATIONS AND DETAILS

01-58-012-
APPROVED
TOWN OF CARY
Approved By: DEC Date: 5-22-02
Planning: PJC Date: 6-20-02
Engineering: JS Date: 6-12-02

SEAL
2484
ENGINEER
BRADLEY D. HART

Bradley D. Hart

No.	Revision	Date	By
1	PER TOC REVIEW	4/16/02	BCH
2	PER TOC REVIEW	6/2/02	BCH

Designer	BCH	Scale	1"=20'
Drawn By	BCH	Date	01MARCH02
Checked By	BCH	Job No.	201238.00

THE GROVE AT CARY PARK

POND DETAILS

WITHERS & RAVENEL
ENGINEERS | PLANNERS | SURVEYORS
111 MacKenzie Drive Cary, North Carolina 27511 tel: 919-469-3340 fax: 919-467-6006 www.wITHERSRAVENEL.COM

Sheet No.
C-9