

H:\Projects\grove at Cary Park\Submittal 04-22-02\SitePlan2.dwg Mon Jun 03 11:15:47 2002 R. Thomas

© JERRY TURNER & ASSOCIATES, INC. THIS DOCUMENT IS THE PROPERTY OF JERRY TURNER & ASSOCIATES. ALL RIGHTS ARE RESERVED AND ANY POSSESSION, REPRODUCTION, OR OTHER USE OF THIS DOCUMENT WITHOUT THE PRIOR PERMISSION OF JERRY TURNER & ASSOCIATES IS EXPRESSLY PROHIBITED.

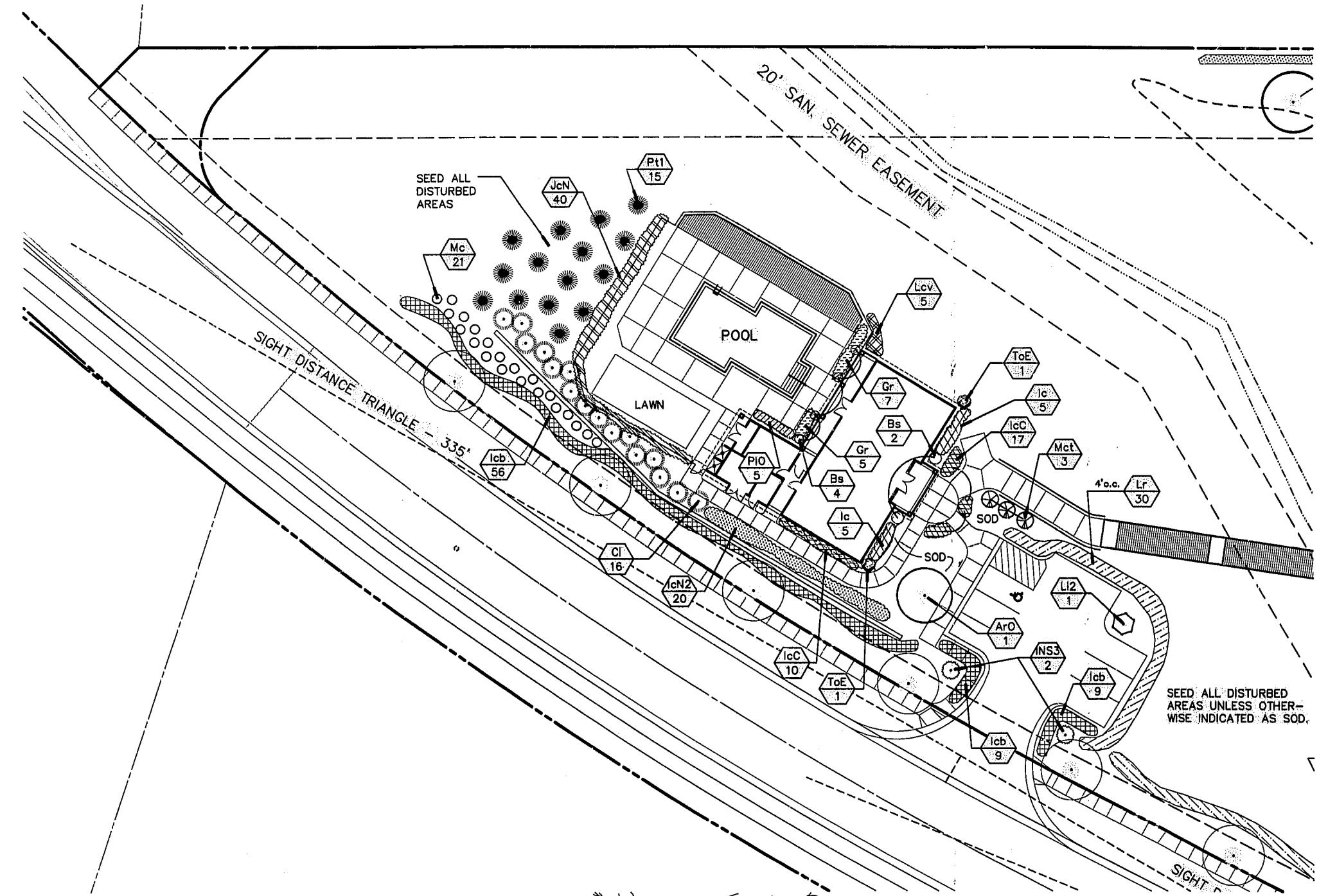

"THE OWNERS OF THE PROPERTY AND THEIR AGENTS, HEIRS OR ASSIGNS SHALL BE RESPONSIBLE FOR THE INSTALLATION, PRESERVATION AND MAINTENANCE OF ALL PLANTINGS AND PHYSICAL FEATURES SHOWN ON THIS PLAN. THE OWNERS SHALL BE RESPONSIBLE FOR ANNUAL MAINTENANCE OF THE VEGETATION TO INCLUDE BUT NOT BE LIMITED TO:

A. FERTILIZATION: LAWN: FERTILIZE LAWN TWICE PER YEAR (FEBRUARY 15-MARCH 15 AND AGAIN SEPT. 1-OCTOBER 31) ACCORDING TO SOIL TEST. FERTILIZE WARM SEASON GRASSES ONCE DURING GROWING SEASON PER SOIL TEST.

B. PRUNING: PRUNING SHALL BE LIMITED TO REMOVAL OF DEAD WOOD OR BRANCHES FOR TREES OR FOR SIGHT DISTANCE/SAFETY REASONS; THE SHIGO STANDARDS SHOULD BE ADHERED TO. THE PRUNING OF SHRUBS SHALL BE LIMITED TO THE PRUNING NECESSARY TO MAINTAIN THE NATURAL SHAPE OF THE PLANT EXCEPT FOR SHEARED HEDGES.

C. PEST CONTROL: PRE-EMERGENT WEED CONTROL FOR LAWN AND SHRUB BEDS MAY BE APPLIED IN FEBRUARY. CHEMICAL TREATMENT FOR INSECT INFESTATION AND DISEASE MAY BE APPLIED AND SHALL BE SPECIFIC TO THE PROBLEM.

D. MULCHING: MULCHING SHALL BE MAINTAINED AT A DEPTH OF 2-3" IN PLANT BEDS. AS A MINIMUM MULCH SHALL BE REAPPLIED AT LEAST EVERY 2 YEARS.

E. MOWING: PRIMARY PEGUE LAWN SHALL BE MAINTAINED AT A HEIGHT OF 3" AND SHALL BE MOWED APPROXIMATELY 30 TIMES PER YEAR. SECONDARY TURF AREAS MAY BE MAINTAINED HIGHER AND LESS FREQUENTLY. WARM SEASON GRASSES SHALL BE MOWED AS NEEDED DURING THE GROWING SEASON TO MAINTAIN THE RECOMMENDED HEIGHT OF THE SPECIES OF TURF GRASS.

F. PLANT PROTECTION: AVOID EXCESS INTRUSION INTO THE ROOT ZONE AREA OF ESTABLISHED PLANTINGS.

G. WATERING: IF AN IRRIGATION SYSTEM IS UTILIZED, THE SYSTEM SHALL BE REGULATED TO PROVIDE APPROXIMATELY 1" OF RAINFALL PER WEEK DURING THE GROWING SEASON.

FAILURE TO MAINTAIN ALL PLANTINGS IN ACCORDANCE WITH THIS PLAN MAY CONSTITUTE A VIOLATION OF THE UNIFIED DEVELOPMENT ORDINANCE AND MAY RESULT IN FINES."

MAINTENANCE AGREEMENT

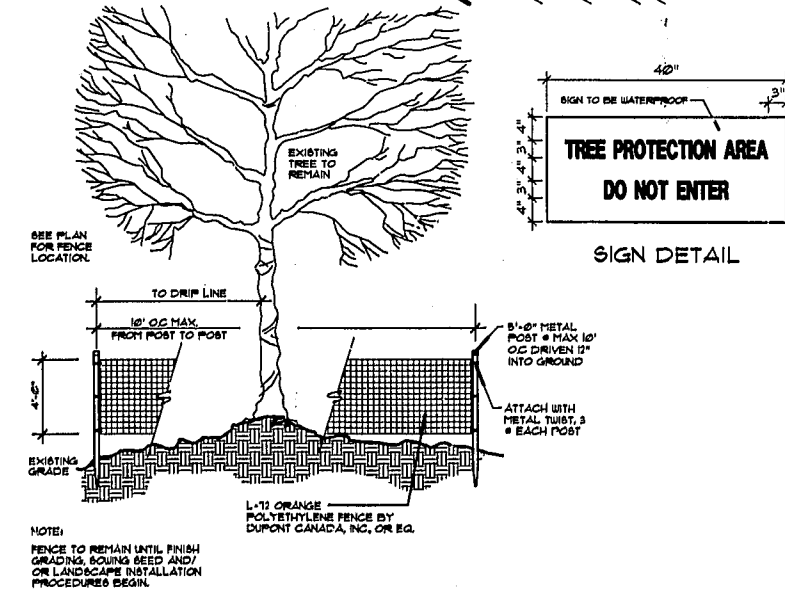

TREE PROTECTION FENCE

NOT TO SCALE

SEED ALL DISTURBED AREAS UNLESS OTHERWISE INDICATED AS SOD.



JERRY TURNER & ASSOCIATES, INC.

Landscape Architecture
Land Planning
Environmental Design

905 Jones Franklin Road
Raleigh, North Carolina 27606
(919) 851-7150 fax. (919) 851-7547

277 S.E. 5th Avenue
Delray Beach, Florida 33483
(561) 278-0453 fax. (561) 272-7593

PROJECT

THE GROVE
AT
CARY PARK
(PARCEL MR-9)

CARY, NORTH CAROLINA

REVISIONS

3/4/02
4/22/02
6/03/02

DRAWN	CHECKED
RT	LH
SCALE	DATE
1"=20'	11/5/01
TITLE	

ACTIVITY
CENTER
LANDSCAPE
PLAN

FILE NO.	JOB NO.
	1536.35
SEAL	SHEET NO.
	5



5

01-58-012-
APPROVED
TOWN OF CARY

Approved by: DRC Date: 5-22-02
Planning: BS Date: 4-15-02
Engineering: TG Date: 6-12-02

