

NOTES:

- EXISTING TOPOGRAPHY SHOWN IS FROM FIELD SURVEY BY WITHERS & RAVENEL, INC.
- CONTRACTOR SHALL VERIFY LOCATION OF ALL EXISTING UTILITIES PRIOR TO CONSTRUCTION.
- PERMANENT GROUND COVER SHALL BE ESTABLISHED WITHIN 15 WORKING DAYS OR 90 CALENDAR DAYS, WHICHEVER IS SHORTER, FOLLOWING ANY PHASE OF GRADING.
- CONTRACTOR SHALL CONSULT THE DESIGN ENGINEER PRIOR TO PLACEMENT OF ANY STOCKPILES.
- ALL STORM DRAIN FRAMES, GRATES AND HOODS SHALL BE STAMPED WITH "DRAINS TO CAPE FEAR RIVER" IN ACCORDANCE WITH TOWN OF CARY STANDARDS.
- ALL CUT AND FILL SLOPES SHALL BE STABILIZED WITHIN 15 DAYS OF ANY PHASE OF GRADING.
- THE 2 PROPOSED WET PONDS (POND 1 AND POND 2) WILL SERVE TO MEET THE WATERSHED PROTECTION REQUIREMENTS FOR THIS SITE.
- THIS PROJECT MAY REQUIRE A PRECONSTRUCTION CONFERENCE PRIOR TO ISSUANCE OF A GRADING PERMIT.
- THE STREETS IN FRONT OF THE PROJECT SHALL BE KEPT CLEAN AT ALL TIMES OR A WASH STATION WILL BE REQUIRED BY THE TOWN OF CARY.

- THE TREE PROTECTION FENCING SHALL BE INSTALLED AND INSPECTED PRIOR TO ISSUANCE OF A GRADING PERMIT.
- A BOND EQUAL TO 125% OF THE ENGINEER'S CONSTRUCTION COST ESTIMATE FOR THE TWO WET PONDS MUST BE POSTED PRIOR TO ISSUANCE OF THE GRADING PERMIT FOR THIS PROJECT.
- THIS PROJECT SHALL MEET ALL THE REQUIREMENTS OF THE BEST MANAGEMENT PRACTICES AND ENGINEERED STORMWATER CONTROL STRUCTURES AS OUTLINED IN THE TOWN OF CARY UNIFIED DEVELOPMENT ORDINANCE, CHAPTER 10, PART 3).
- THE SLOPES FOR BOTH OF THE PROPOSED PONDS SHALL BE STABILIZED WITH NORTH AMERICAN GREEN C125 LONG-TERM EROSION CONTROL LINING, AND SEEDED WITH WEEPING LOVE GRASS, RED FESCUE, OR OTHER TOWN OF CARY APPROVED, LOW MAINTENANCE VARIETY VEGETATION. 2:1 FILL-SLOPES IN OTHER AREAS SHALL ALSO BE STABILIZED WITH NORTH AMERICAN GREEN C125 LINING.
MANUFACTURER INFO:
NORTH AMERICAN GREEN, INC.
1-800-772-2040
- CUT SLOPES THAT ARE STEEPER THAN 3:1 SHALL BE STABILIZED WITH WEEPING LOVE GRASS, RED FESCUE OR APPROVED SIMILAR VARIETY.

- CONSTRUCTION SEQUENCE
- OBTAIN GRADING PERMIT (PRE-CONSTRUCTION CONFERENCE MAY BE REQUIRED), CALL TOWN OF CARY EROSION CONTROL OFFICER AT 469-4381 TO DETERMINE.
 - INSTALL ALL TEMPORARY EROSION CONTROL MEASURES SUCH AS: TEMPORARY DIVERSIONS, SILT FENCING, GRAVEL CONSTRUCTION ENTRANCES, SEDIMENT BASINS, ETC. (SEE DETAIL BELOW FOR TEMP. DIVERSION AT RETAINING WALL)
 - OBTAIN A CERTIFICATE OF COMPLIANCE THROUGH ON-SITE INSPECTION BY THE TOWN OF CARY EROSION CONTROL ENGINEER (469-4381).
 - BEGIN CLEARING AND GRUBBING.
 - MAINTAIN DEVICES AS NEEDED, ROUGH GRADE SITE.
 - INSTALL STORM SEWER AND PROTECT INLETS PER TOWN OF CARY STANDARDS.
 - BEGIN CONSTRUCTION.
 - STABILIZE DISTURBED AREAS AS THEY ARE BROUGHT UP TO FINISHED GRADE WITH VEGETATION, PAVING, ETC.
 - MAINTAIN TEMPORARY EROSION CONTROL MEASURES UNTIL PERMANENT GROUND COVER IS ESTABLISHED.
 - WHEN CONSTRUCTION IS COMPLETE AND ALL AREAS ARE STABILIZED COMPLETELY, CALL FOR A FINAL INSPECTION BY TOWN OF CARY EROSION CONTROL ENGINEER.
 - IF SITE IS APPROVED, REMOVE TEMPORARY DIVERSIONS, SILT FENCING, SEDIMENT BASINS, ETC. AND SEED OUT ALL BARE AREAS WITHIN THE SITE.
 - INSTALL PERMANENT EROSION CONTROL MEASURES SUCH AS RIP RAP DISSIPATORS, CHANNELS, ETC.

POND 1 TO BE USED FOR EROSION CONTROL.
DRAINAGE AREA=7.0 AC.
DENUDED AREA=4.8 AC.
VOLUME REQUIRED=8712 CF
VOLUME PROVIDED=9470 CF

CONSTRUCT COFFER DAM TO TOP ELEVATION OF 284.75 FOR SEDIMENT CONTROL DURING CONSTRUCTION.

DISSIPATOR PAD
18'WX15'WX22"D
CLASS B RIP-RAP
W/ FABRIC LINER
450=6'
V10=6.8 FPS

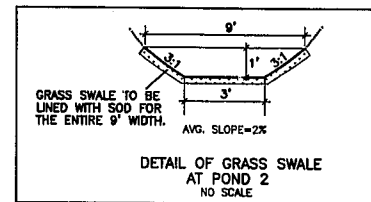

DISSIPATOR PAD
12'WX14'WX22"D
CLASS B RIP-RAP
W/ FABRIC LINER
450=5'

GRASS SWALE
(SEE DETAIL ABOVE)

CONSTRUCT COFFER DAM TO TOP ELEVATION OF 291.5 FOR SEDIMENT CONTROL DURING CONSTRUCTION.

POND 1 TO BE USED FOR EROSION CONTROL.
DRAINAGE AREA=1.3 AC.
DENUDED AREA=1.1 AC.
VOLUME REQUIRED=1987 CF
VOLUME PROVIDED=2800 CF

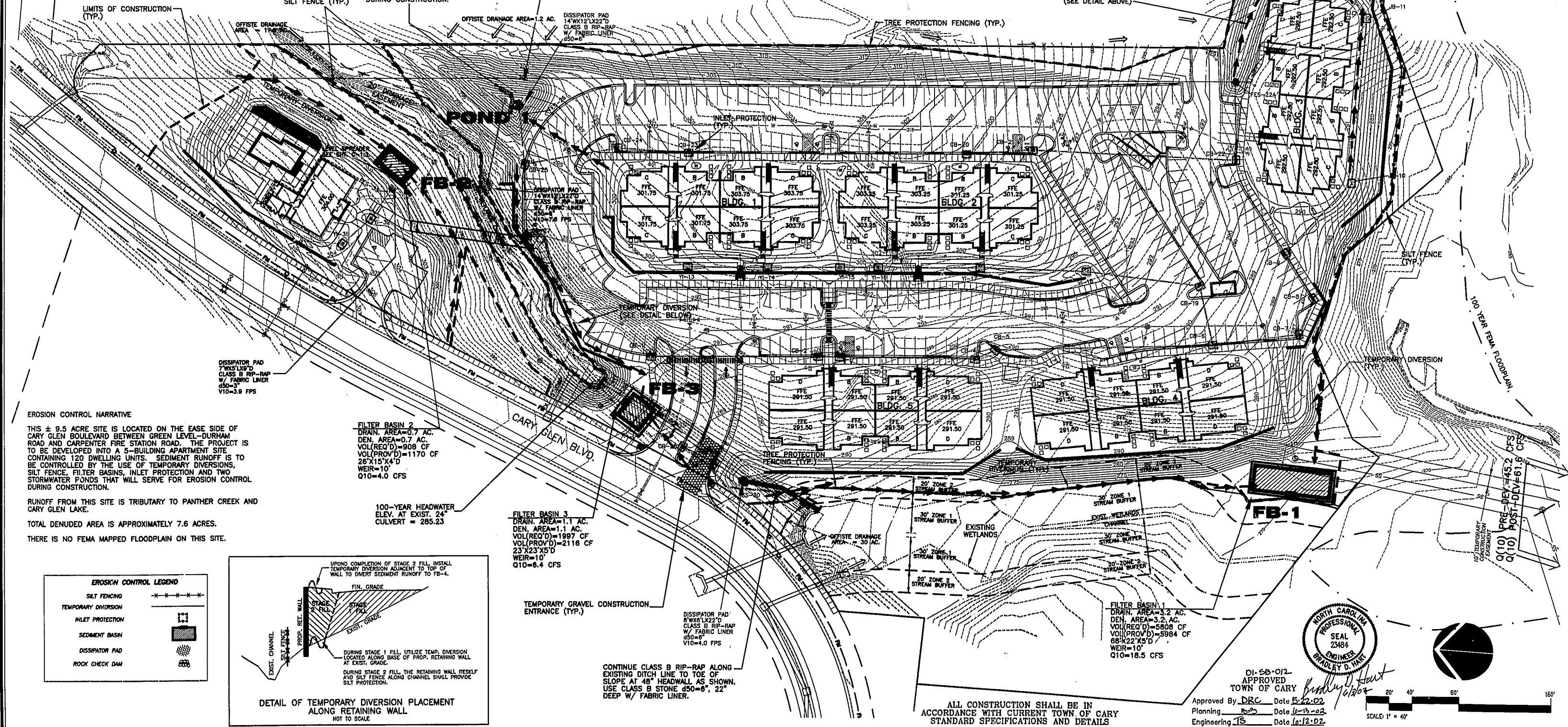

EROSION CONTROL NARRATIVE

THIS ± 9.5 ACRE SITE IS LOCATED ON THE EAST SIDE OF CARY GLEN BOULEVARD BETWEEN GREEN LEVEL-DURHAM ROAD AND CARPENTER FIRE STATION ROAD. THE PROJECT IS TO BE DEVELOPED INTO A 5-BUILDING APARTMENT SITE CONTAINING 120 DWELLING UNITS. SEDIMENT RUNOFF IS TO BE CONTROLLED BY THE USE OF TEMPORARY DIVERSIONS, SILT FENCE, FILTER BASINS, INLET PROTECTION AND TWO STORMWATER PONDS THAT WILL SERVE FOR EROSION CONTROL DURING CONSTRUCTION.

RUNOFF FROM THIS SITE IS TRIBUTARY TO PANTHER CREEK AND CARY GLEN LAKE.

TOTAL DENUDED AREA IS APPROXIMATELY 7.6 ACRES.

THERE IS NO FEMA MAPPED FLOODPLAIN ON THIS SITE.

FILTER BASIN 2
DRAIN AREA=0.7 AC.
DEN. AREA=0.7 AC.
VOL.(REQ'D)=908 CF
VOL.(PROV'D)=1170 CF
26'X15'X4'D
WEIR=10'
Q10=4.0 CFS

100-YEAR HEADWATER
ELEV. AT EXIST. 24"
CULVERT = 285.23

FILTER BASIN 3
DRAIN AREA=1.1 AC.
DEN. AREA=1.1 AC.
VOL.(REQ'D)=1993 CF
VOL.(PROV'D)=2116 CF
23'X23'X5'D
WEIR=10'
Q10=6.4 CFS

FILTER BASIN 1
DRAIN AREA=3.2 AC.
DEN. AREA=3.2 AC.
VOL.(REQ'D)=5808 CF
VOL.(PROV'D)=5984 CF
68'X22'X5'D
WEIR=10'
Q10=18.5 CFS

DISSIPATOR PAD
8'WX6'WX22"D
CLASS B RIP-RAP
W/ FABRIC LINER
450=6'
V10=4.0 FPS

TEMPORARY GRAVEL CONSTRUCTION ENTRANCE (TYP.)

CONTINUE CLASS B RIP-RAP ALONG EXISTING DITCH LINE TO TOE OF SLOPE AT 48" HEADWALL AS SHOWN. USE CLASS B STONE 450=8", 22" DEEP W/ FABRIC LINER.

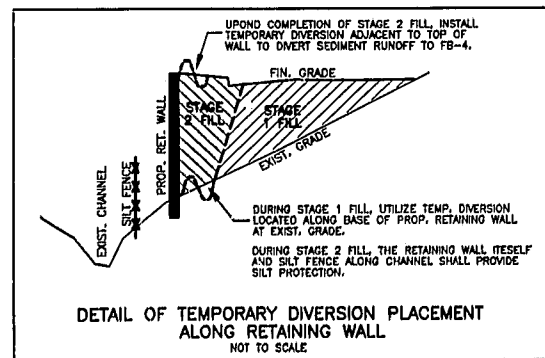
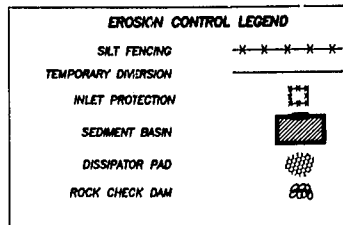

DI-SB-012
APPROVED
TOWN OF CARY
Approved By: *DRG* Date: 5-22-02
Planning: *RS* Date: 6-13-02
Engineering: *LS* Date: 6-12-02

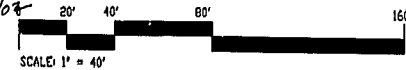

No.	Revision	Date	By
1.	PER 100 REVIEW	4/16/02	BDH
2.	PER 100 REVIEW	6/3/02	BDH

Designer	BDH	Scale	1"=40'
Drawn By	BDH	Date	01MARCH02
Checked By	BDH	Job No.	201238.00

THE GROVE AT CARY PARK

EROSION CONTROL PLAN

WITHERS & RAVENEL
ENGINEERS | PLANNERS | SURVEYORS
111 MacKenzie Drive Cary, North Carolina 27511 | tel: 919-469-3340 | fax: 919-467-6008 | www.witthersravenel.com

Sheet No.
C-2