

NO FILL SLOPES TO BE GREATER THAN 2:1.

PAVEMENT WIDENING NOTE:
PAVEMENT WIDENING (INCLUDING PAVED SHOULDER) SHALL MATCH
EXISTING CROSS SLOPE OF ADJACENT WEST-BOUND LANE.

NOTE:
EDGE OF PAVEMENT ELEVATIONS AND OFF-PAVEMENT TOPO FROM
FIELD SURVEY BY WITHERS AND RAVENEL. ON-PAVEMENT CONTOURS
ADJACENT TO PROPOSED PAVEMENT WIDENING, AND CROSS-SECTIONS
ARE BASED ON INTERPOLATION OF FIELD MEASUREMENTS OF
REPRESENTATIVE PAVEMENT CROSS-SLOPES BY WILLIAM G. DANIEL &
ASSOCIATES.

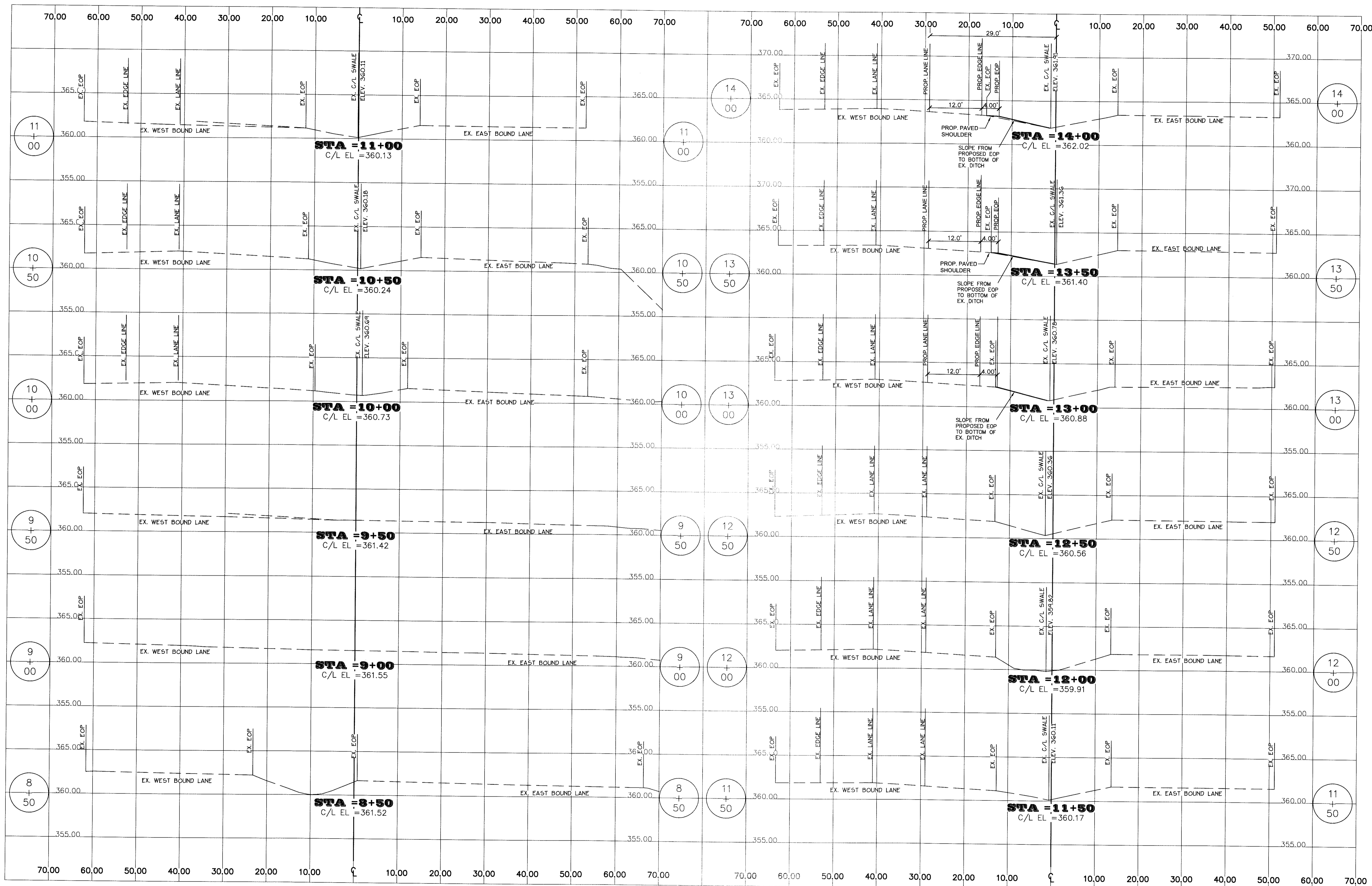

Wm. G. Daniel & Assoc.
Engineering Planning
Site Design
1150 SE MAYNARD ROAD
SUITE 260
CARY, NC 27511
(919) 467-9708
C-0329

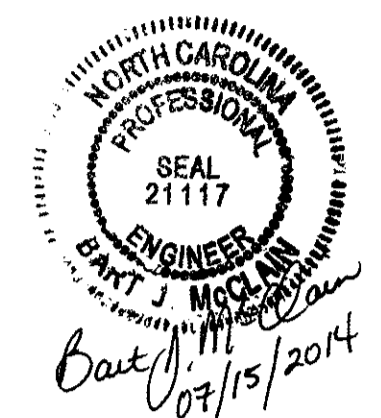

Revisions
05/28/2014 Per ToC first review.
07/15/2014 Per ToC second review.

14-SP-031
HTE #: 14-1455
Approved by the Town of Cary
Development Review Committee
Planner: K.W.L. Date: 8/1/2014

DEVELOPER:
Triad Educational Services
700 Creek Ridge Rd.
Greensboro NC 27406
(336) 505-9665
Project
MacKenan Drive
& Highway 64
Road Improvements

U.S. Highway 64
Cross Sections
Sta. 8+50 - 14+00
Date
May 8, 2014
Scale
Horiz: 1" = 10'
Vert: 1" = 5'
Sheet