

© 1995 WITHERS & RAVENEL ENGINEERING & SURVEYING, INC. THIS DOCUMENT IS THE PROPERTY OF WITHERS & RAVENEL ENGINEERING & SURVEYING, INC. ALL RIGHTS ARE RESERVED AND NO REPRODUCTION OR OTHER USE OF THIS DOCUMENT WITHOUT THE PRIOR PERMISSION OF WITHERS & RAVENEL ENGINEERING & SURVEYING, INC. IS PERMITTED.

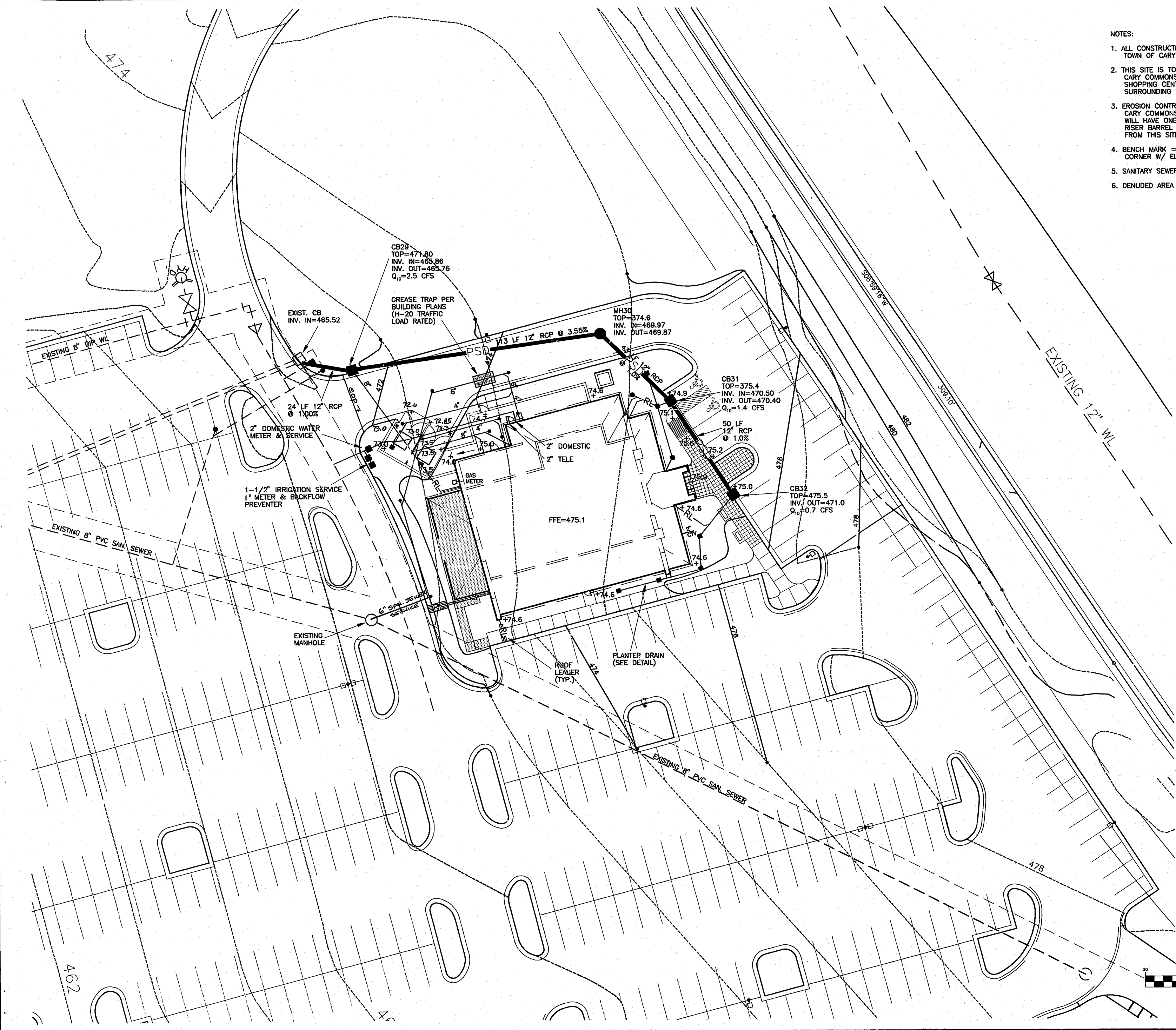

- NOTES:
1. ALL CONSTRUCTION SHALL BE IN ACCORDANCE WITH CURRENT TOWN OF CARY STANDARDS AND SPECIFICATIONS.
 2. THIS SITE IS TO BE CONSTRUCTED IN CONJUNCTION WITH THE CARY COMMONS SHOPPING CENTER. SEE THE CARY COMMONS SHOPPING CENTER PLANS FOR ADDITIONAL INFORMATION ON THE SURROUNDING SITE IMPROVEMENTS.
 3. EROSION CONTROL MEASURES FOR THIS SITE ARE SHOWN ON THE CARY COMMONS SHOPPING CENTER PLANS. THE SHOPPING CENTER WILL HAVE ONE PRIMARY EROSION CONTROL DEVICE WHICH IS A RISER BARREL SEDIMENT BASIN THAT WILL RECEIVE THE DRAINAGE FROM THIS SITE. A GRADING PERMIT WILL BE REQUIRED.
 4. BENCH MARK = ALUM. NCDOT MONUMENT AT NORTHEAST CORNER W/ ELEVATION = 478.88
 5. SANITARY SEWER FLOW = 7,200 GPD (288 SEATS * 25 GPD/SEAT)
 6. DENUDED AREA = 1.0 ACRES

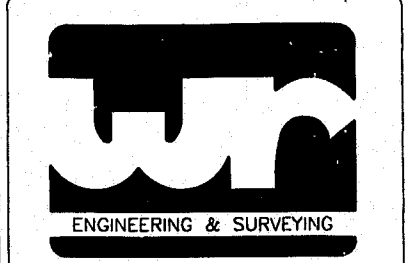

WITHERS & RAVENEL
 Engineering & Surveying, Inc.

111 MacKenan Drive
 Cary, N.C. 27511
 PHONE : 919-469-3340
 FAX : 919-467-6008

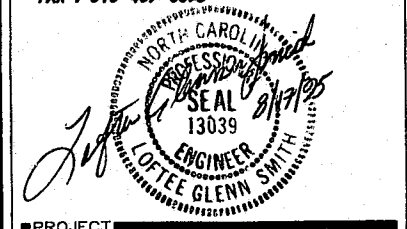

PROJECT

MACARONI GRILL

CARY COMMONS
CARY, NORTH CAROLINA

- REVISIONS
- 1 TOC 1ST REVIEW 6/15/95U
 - 2 REV. DUMP/SERV. 6/28/95U
 - 3 REV. PER ARCH 7/12/95U
 - 4 REV. RL & WM 7/20/95
 - 5 " SPOTS/SS 8/16/95

DRAWN	CHECKED
DOU	LGS
SCALE	DATE
1" = 20'	5/26/95
TITLE	

GRADING, UTILITY, & EROSION CONTROL PLAN

FILE NO.	JOB NO.
N/A	95072
SEAL	SHEET NO.

