

© JERRY TURNER & ASSOCIATES, INC. THIS DOCUMENT IS THE PROPERTY OF JERRY TURNER & ASSOCIATES. ALL RIGHTS ARE RESERVED AND ANY REPRODUCTION, REPRODUCTION, OR OTHER USE OF THIS DOCUMENT WITHOUT THE PRIOR PERMISSION OF JERRY TURNER & ASSOCIATES IS EXPRESSLY PROHIBITED.



**JERRY TURNER & ASSOCIATES**

LANDSCAPE ARCHITECTURE  
LAND PLANNING  
ENVIRONMENTAL DESIGN

905 JONES FRANKLIN ROAD  
RALEIGH, NORTH CAROLINA 27606  
(919) 851-7150

82 S.E. 6TH AVENUE  
DELRAY BEACH, FLORIDA 33483  
(407) 276-0453

PROJECT \_\_\_\_\_

**MACARONI GRILL  
CARY COMMONS**

CARY, NORTH CAROLINA

REVISIONS \_\_\_\_\_

DRAWN \_\_\_\_\_ CHECKED \_\_\_\_\_

SCALE \_\_\_\_\_ DATE 5/26/95

TITLE \_\_\_\_\_

**ARCHITECTURALS  
CONSTRUCTION DRAWING**

FILE NO. \_\_\_\_\_ JOB NO. \_\_\_\_\_

170 2093.05

SEAL \_\_\_\_\_ SHEET NO. \_\_\_\_\_

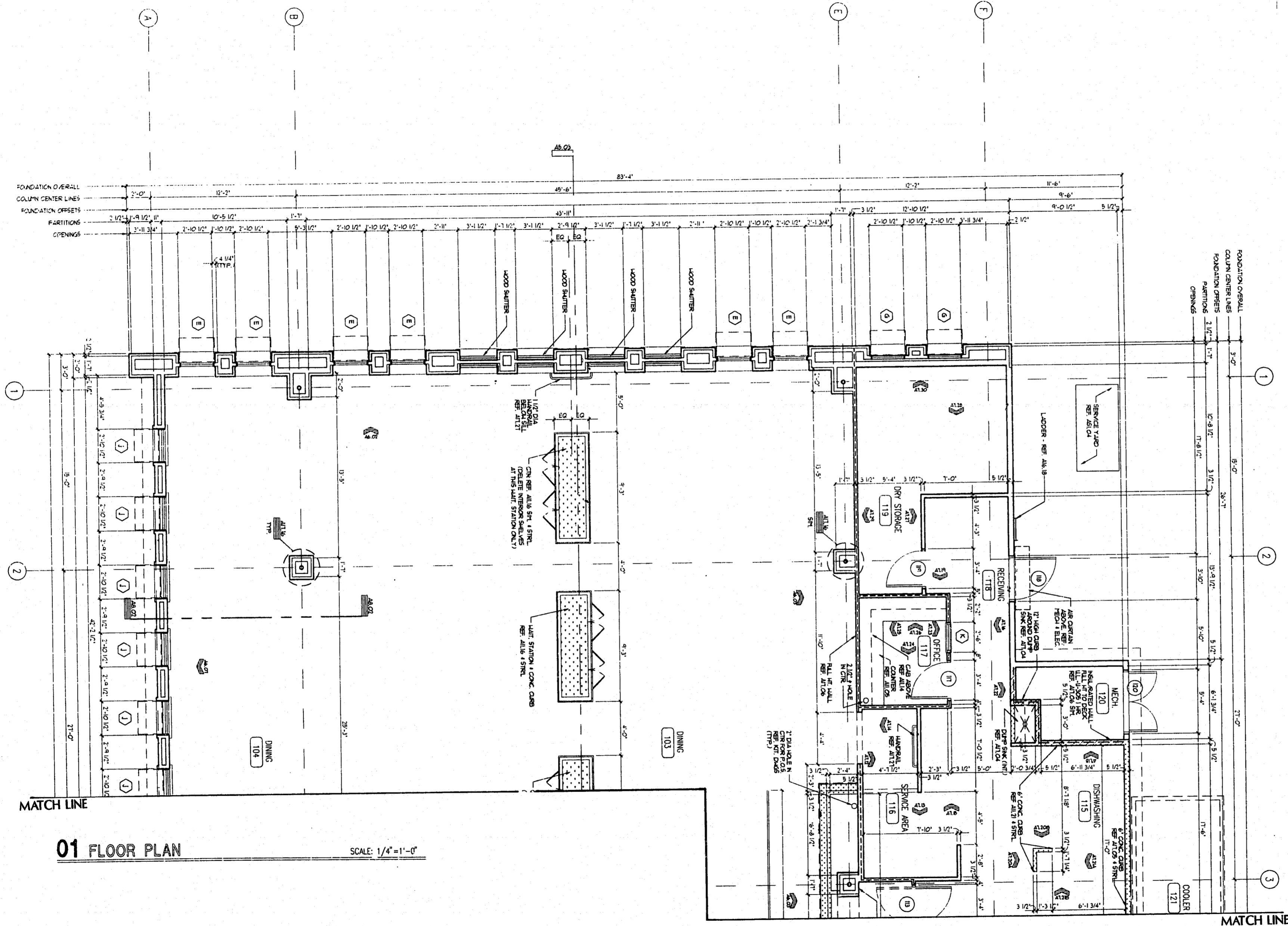

**01 FLOOR PLAN** SCALE: 1/4" = 1'-0"

**WALL TYPE LEGEND:**

	FULL HEIGHT WALL TO ROOF DECK - REF. ALL 26 (WITH NO INSULATION)		FULL HEIGHT MET. FR. WALL TO ROOF DECK - REF. ALL 23 U.N.O.
	FULL HEIGHT WALL TO ROOF DECK - REF. ALL 26 (WITH INSULATION)		TYP. HALL - REF. ALL 24
	CONCRETE CURBS REF. STR. 1 DTLS ALL 01 ALL 16 ALL 01 ALL 21 ALL 21 ALL 01	NOTE: ALL EXTERIOR WALLS TO BE INSULATED NOTE: FULL HEIGHT WALLS MAY SERVE AS DRAFT STOPS	

- GENERAL NOTES:**
- FOR THE PURPOSE OF THESE DRAWINGS AND ACCOMPANYING SPECIFICATIONS, THE TERM "BY OWNER" SHALL MEAN ITEMS PROVIDED BY OWNER INSTALLED BY CONTRACTOR AS PART OF THE WORK OF THIS CONTRACT. THE ABBREVIATION "N/C" (NOT IN CONTRACT) SHALL MEAN ITEMS PROVIDED AND INSTALLED BY OWNER UNDER SEPARATE CONTRACT.
  - SCREENED LINES INDICATE EXISTING CONSTRUCTION TO REMAIN UNLESS NOTED OTHERWISE.
  - SCREENED DASHED LINES INDICATE EXISTING TO BE REMOVED UNLESS NOTED OTHERWISE.
  - DIMENSIONS ARE TO FACE OF STLD. MAS. OR FACE OF FOUNDATION UNLESS NOTED OTHERWISE.

NOTE: FLOOR ELEV. IN ROOMS 101 & 102 ARE 10' HIGHER THAN THE REMAINING BLDG. FLOOR ELEVATION RE: CIVIL DWGS.

**DICKSON ♦ EDSON ♦ MCMAHON**  
ARCHITECTS AND INTERIOR DESIGNER  
6500 Greenville Avenue Suite 307 Dallas, Texas 75206 (214) 696-9073