

PINEY PLAINS ROAD

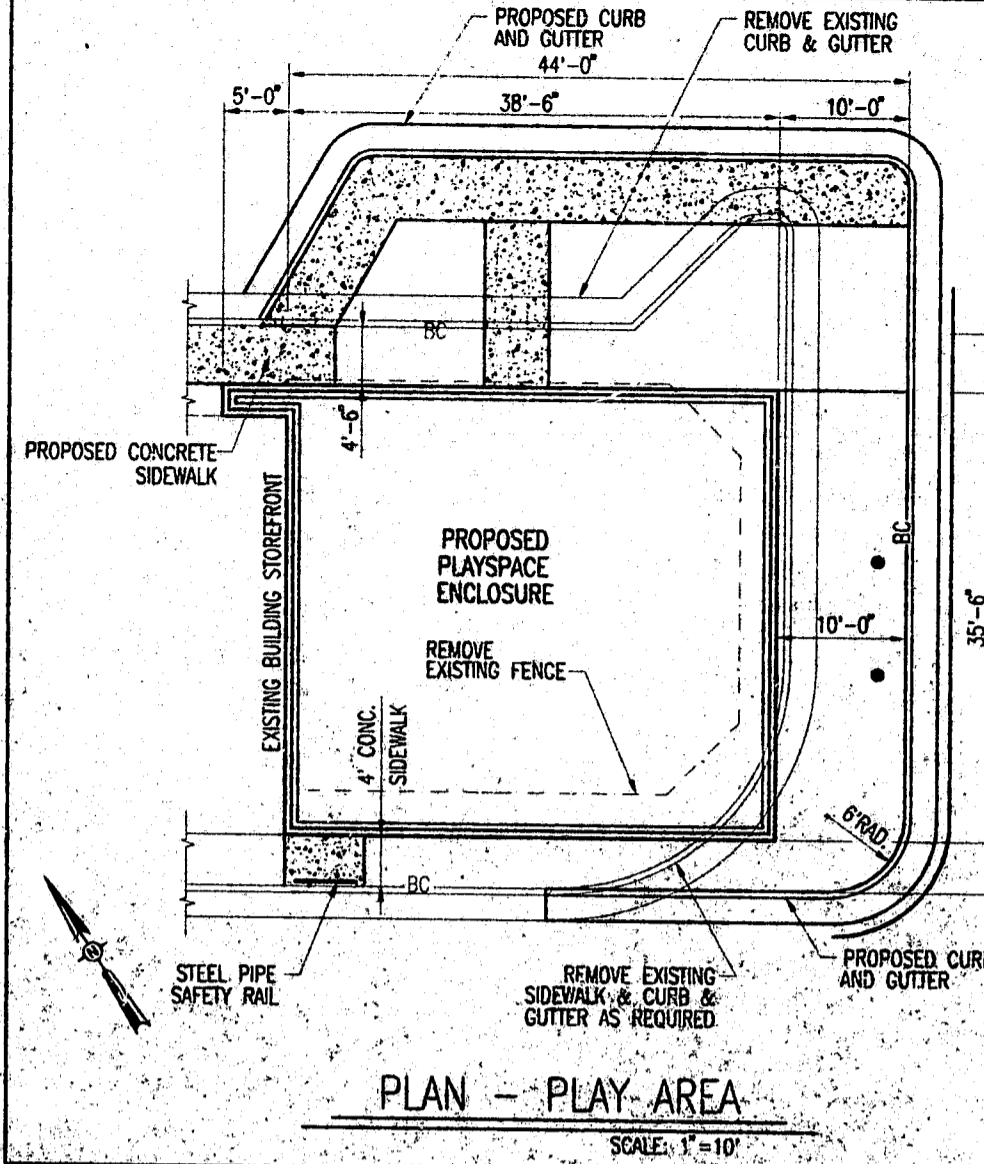
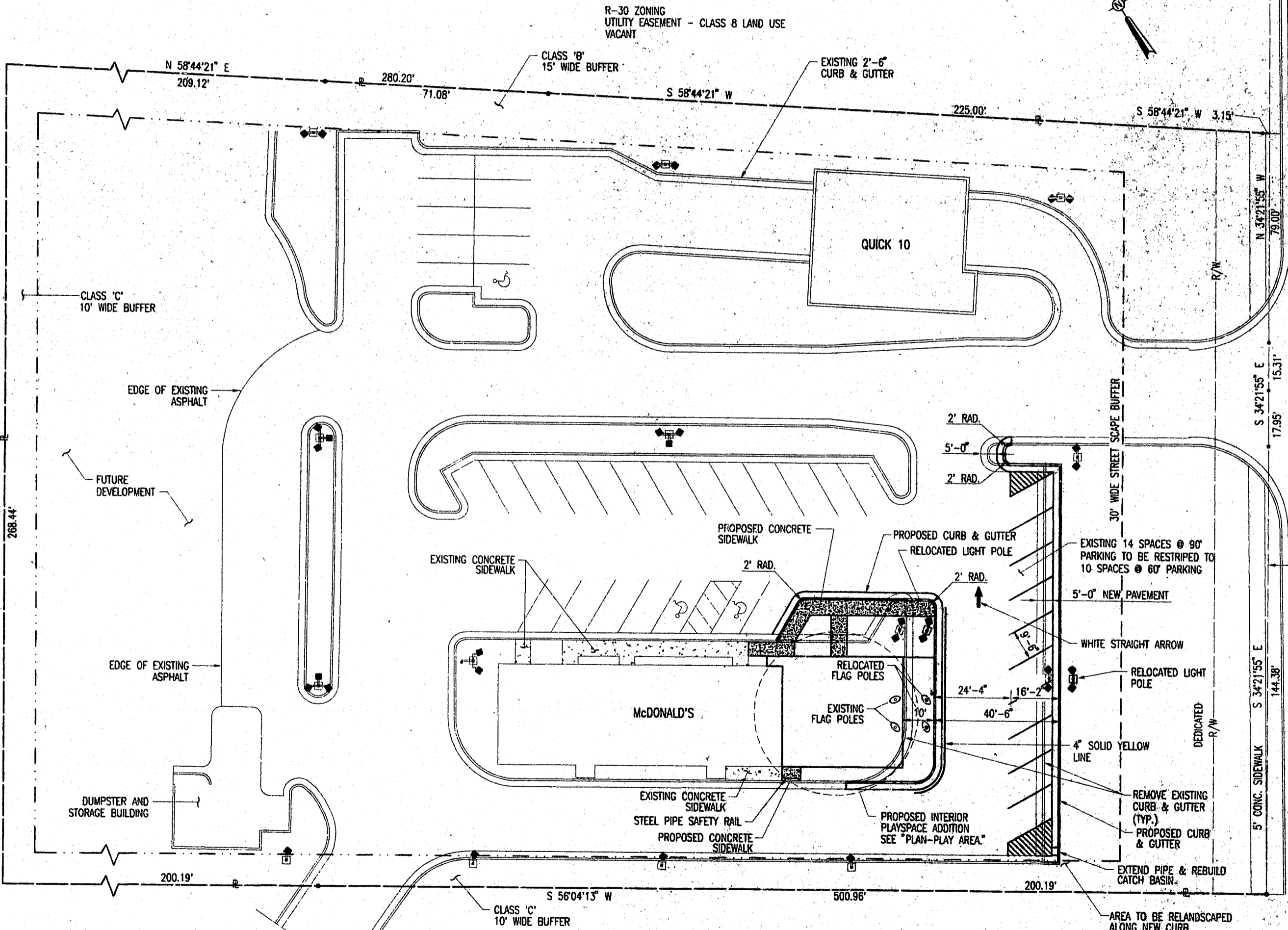

WALNUT STREET

OLD R/W

CROSSROADS PLAZA SHOPPING CENTER B-3 ZONING

APPROVED
 75-52-115
 Dec 14, 1995
 Metal & Millwork - Silver
 Safety Rails - bronze
 Parking Meters & Enclosure for
 Site Data: *[Signature]*

ZONING: CU B-2
 SITE AREA: 2.9860 ACRES
 McDONALD'S: EXISTING 2,540 SF, 75 SEATS
 PROPOSED 1,370 SF
 TOTAL 3,910 SF
 PARKING: EXISTING 37 SPACES
 PROPOSED 30 SPACES
 REQUIRED 25 SPACES
 QUICK 10: EXISTING 2,623 SF, 2-BAYS

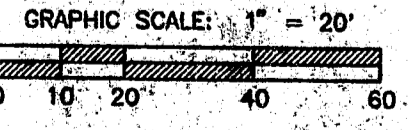

DIME: P:\G\RES\TITLE: PLOT DATE: 7/21/95 SCALE: 1/20

REV	DATE	DESCRIPTION	BY	ISSUE REF

DENNIS K. HOYLE AND ASSOCIATES, P.C.
 1500 PINEY PLAINS RD. SUITE 200
 CARY, NC 27511
 PH: (919) 380-0044

McDonald's

THESE PLANS AND SPECIFICATIONS ARE THE PROPERTY OF MCDONALD'S CORPORATION AND SHALL NOT BE REPRODUCED WITHOUT THEIR WRITTEN PERMISSION.

OFFICE: RALEIGH REGION
 ADDRESS: 3200 BEECHLEAF COURT, SUITE 300, RALEIGH, N.C. 27604

- GENERAL NOTES**
- CONTRACTOR SHALL VERIFY ALL DIMENSIONS AND ELEVATIONS PRIOR TO CONSTRUCTION AND SHALL MAKE ANY OBSERVATIONS THAT AFFECT CONSTRUCTION KNOWN TO THE ENGINEER.
 - ALL CONSTRUCTION SHALL BE IN ACCORDANCE WITH CURRENT TOWN OF CARY STANDARD SPECIFICATIONS AND DETAILS.
 - THERE WILL BE NO INCREASE IN IMPERVIOUS AREA.
 - CONTRACTOR TO DRILL 3/4" DEEP HOLES IN CONCRETE CURBS AT 8'-0" O.C. WHERE LANDSCAPING IS ADJACENT TO CURB.
 - ALL DIMENSIONS TO BACK OF CURB UNLESS NOTED OTHERWISE.

SURVEY INFORMATION

THIS DRAWING WAS PREPARED FROM THE "SITE PLAN FOR CONSTRUCTION," DRAWING NUMBER SP-1, PREPARED BY RICE AND ASSOCIATES, DATED OCTOBER 21, 1993.

LEGEND

LOT LIGHT	LP-30
-----------	-------

PLAN SCALE: 1" = 20'
 STREET ADDRESS: 1830 WALNUT STREET

CITY	CARY	STATE	N. C.
COUNTY	WAKE		

REGIONAL DWG. NO	CORPORATE DWG. NO.
-	-

PLAN APPROVALS	DATE	
SIGNATURE (2 REQUIRED)		
REGIONAL USE DEVELOPMENT MGR.		
OPERATIONS DEPT.		
CONTRACTOR		
OWNER		
STATUS	DATE	BY
PRELIMINARY	7/24/95	MAH
PLAN CHECKED	7/95	TGZ
AS-BUILT		

C-1